

CONSIDERATION OF RESOLUTION NO. _____ FOR THE
PURPOSE OF ADDING PROJECTS TO THE TRANSPORTATION
IMPROVEMENT PROGRAM, ESTABLISHING A FIVE-YEAR
PROJECT SCHEDULE AND AUTHORIZING EXPENDITURE OF
FY 1984 FUNDS

Date: December 12, 1983

Presented by: Andrew Cotugno

FACTUAL BACKGROUND AND ANALYSIS

Recommendation

1. Adopt this resolution authorizing use of some \$38+ million of available FY 1983 and FY 1984 Interstate Transfer funding.

2. Concurrent to the above 1984 funding allocation, authorize several projects to be added to the Regional Transportation Plan (RTP) establishing the "need" for the project, the Federal-Aid Urban (FAU) System identifying that the facility currently functions as at least a collector facility or will within five years and the Transportation Improvement Program (TIP) identifying Interstate Transfer funding as the appropriate category of funds to be used. The following project additions are required:

Attachment #	Project	Amendments Necessary		
		RTP	FAU System	TIP
1	Airport Way			X
2	Rivergate Dr.-Slough Bridge Approaches			X
3	Rivergate Dr. Widening			X
4	Rivergate-Slough Bridge Widening			X
5	Everett-Front Connector			X
6	Highway 43 @ Hood & McKillican			X
7	Beavercreek Rd. Realignment	X		X
8	13th/Gertz Improvement and Extension: Vancouver Way to Columbia Slough			
	Columbia Slough to Columbia Boulevard	X	X	X
9	I-505 Traffic Management Program			X

3. In response to Resolution No. 81-247, a five-year project schedule is established by this resolution to provide a guide for

seeking federal funds and prioritizing staff efforts to complete project development.

4. The priority criteria established in Resolution No. 81-247 are proposed to be revised as follows:

- In prioritizing Category II projects, in addition to the specified criteria, consideration will be given to completion of the three county and Portland programs on as uniform a schedule as possible, but without counting the four major State Highway projects (Oregon City Bypass, Highway 212, Highway 217/Sunset, 190th/Powell).
- In prioritizing Category II projects, the criteria calling for priority consideration of projects funded with a higher local match ratio than necessary is recommended to be dropped.

Background and Analysis

1. The resolution authorizes some \$38+ million of available Interstate Transfer funding to be spent. This amount will be drawn from the \$33.5 million of FY 1984 funding recently appropriated by Congress and the \$20 million of carryover FY 1983 funding not allocated last year. With this action, nearly \$15 million will continue to carry over to FY 1985. This allocation also takes into consideration adjustments to the FY 1983 allocation adopted last year to reflect cost overruns and underruns. In addition, a "reserve" is established for each county area and Portland to manage future cost overruns and underruns.

2. In order to spend available Interstate Transfer funds, a number of projects must be added to the RTP, FAU System and/or TIP. Project descriptions and justifications for each are included as attachments to the resolution.

3. A five-year schedule for completion of the Interstate Transfer program is included to provide a basis for pursuing annual appropriations of discretionary Interstate Transfer funding and to serve as a guide to the Oregon Department of Transportation (ODOT) to process project development. All project schedules as depicted are generally based upon as "fast" a schedule as practical and delays on individual projects are likely if problems occur during project development or right-of-way acquisition. Annual updates to the program schedule together with annual authorization to spend will be necessary.

4. Several amendments to the currently adopted priority criteria are reflected in this resolution:

a. In prioritizing Category II projects, there should be a recognition (in addition to the other criteria) that each program should be completed on as uniform a schedule as possible. Under a

condition of funding shortfall, an area that has already completed a lower share of their program than another area should receive priority consideration. This, however, should be weighed against the merits of the projects in question based upon the other criteria. On the basis of this addition, consideration would be given to those jurisdictions that are lagging behind the current regionwide average of 68 percent complete.

b. Not counted toward the above criteria are the four major State Highway projects: Oregon City Bypass, Highway 213, Highway 217/Sunset and 190th/Powell. These projects are significantly different in scope and size than the rest of the Category II programs and were recognized in the original freeway withdrawals as being priorities.

c. Recommended to be dropped from the criteria is consideration of projects funded with higher than the required local match ratio. The criteria was originally included to provide an incentive to local jurisdictions to raise more local funds, thereby providing the greatest improvement with the available federal funds. However, it is apparent that very few jurisdictions have the ability to raise extra local match and the criteria, therefore, penalizes those that are unable.

EXECUTIVE OFFICER'S RECOMMENDATION

The Executive Officer recommends approval of the attached Resolution.

COMMITTEE CONSIDERATION AND RECOMMENDATION

AC/srb
8880B/349
01/03/84

BEFORE THE COUNCIL OF THE
METROPOLITAN SERVICE DISTRICT

FOR THE PURPOSE OF ADDING PROJECTS)	RESOLUTION NO.
TO THE TRANSPORTATION IMPROVEMENT)	
PROGRAM, ESTABLISHING A FIVE-YEAR)	Introduced by the Joint
PROJECT SCHEDULE AND AUTHORIZING)	Policy Advisory Committee
EXPENDITURE OF FY 1984 FUNDS)	on Transportation

WHEREAS, The Transportation Improvement Program (TIP) was adopted by Resolution No. 83-430; and

WHEREAS, Procedures and policies for developing a multi-year program were adopted by Resolution No. 81-247; and

WHEREAS, FY 1983 Interstate Transfer funds in the amount of \$20 million remain available and FY 1984 funds in the amount of \$33.5 million have been appropriated by Congress; and

WHEREAS, Roads and highways to be improved with federal funds must be included in the Federal-Aid Urban (FAU) System as amended by Resolution No. 83-392; now, therefore,

BE IT RESOLVED,

1. That the following projects, as described in Attachments 1, 2, 3, 4, 5, 6 and 7 are already included in the Regional Transportation Plan (RTP) and are hereby added to the TIP for use with Interstate Transfer funding:

- Airport Way - I-84 to I-205;
- Rivergate Drive - Slough Bridge approaches;
- Rivergate Drive widening - Slough Bridge to Marine Drive;
- Rivergate Drive Slough Bridge widening;
- Everett-Front Connector - west end of Steel Bridge;
- I-505 Traffic Management Program and

- Highway 43 at Hood and McKillican.

2. That the following projects, as described in Attachments 8 and 9, are consistent with the policies of the RTP and hereby added to the plan and the TIP for use of Interstate Transfer funds:

- Beaver Creek Road realignment and extension from Highway 212 to Warner-Milne Road (at Kaen Road).

- 13th and Gertz improvement and extension from Vancouver Way to Columbia Boulevard.

3. That the following street is added to the FAU System:

- 13th and Gertz from Vancouver Way to the Columbia Slough.

4. That the five-year schedule as depicted in Attachment 10 is hereby adopted to serve as a guide for project development and construction schedules and to provide the basis for seeking annual funding appropriations.

5. That the following will be taken into consideration if project schedules must be delayed due to insufficient annual funding:

a. First priority funding will be for completion of the Category I - Regional Corridor and Replacement Projects.

b. Funding priority for the various projects within Category II--after completion of the four major state highway projects (Oregon City Bypass, Highway 212, 217/Sunset Interchange, 190th/Powell)--will result in the counties and Portland completing their programs on as uniform a schedule as possible while taking into consideration the criteria established in Resolution No. 81-247:

- Projects addressing an existing or known, near-term (three years) capacity deficiency (v/c program) will be scheduled before future capacity deficiencies for a logical roadway segment.
- Projects necessary to sustain existing or create new permanent jobs will be programmed before others.
- Projects supporting transit service as defined in the Transit Development Program will be programmed before others.
- All other factors being equal, projects on Principal and Major Arterials will be programmed before others.
- Critical Category II projects will be programmed consistent with the schedule established for Category I projects.
- Projects addressing deferred maintenance or structural inadequacy or to project an existing investment will be programmed before others.
- Other pertinent factors, including, but not limited to:
 - safety
 - air quality
 - energy conservation.

6. That the FY 1984 element of the attached program (Attachment 10) is hereby authorized to be expended for the projects specified in the TIP and that the funds can be transferred between authorized projects and phases to respond to cost overruns, underruns and schedule changes.

ADOPTED by the Council of the Metropolitan Service District
 this _____ day of _____, 1983.

 Presiding Officer

AC/srb
 8880B/349
 12/23/83

PROJECT INFORMATION FORM - TRANSPORTATION IMPROVEMENT PROGRAM

PORTLAND METROPOLITAN AREA

PROJECT DESCRIPTION

RESPONSIBILITY (AGENCY) City of Portland
 LIMITS I-205 to 181st LENGTH 4.1 miles
 DESCRIPTION This project will provide an arterial roadway connecting Airport Way at I-205 with 181st at Sandy. This will provide an important east-west access for a large area of vacant, industrially zoned land. This arterial facility is an important step in providing the infrastructure required to develop this area to its potential.
 Concept Program - New Projects (highway) #203

PROJECT NAME Airport Way
 ID No FAU 9940
 APPLICANT City of Portland

SCHEDULE

TO ODOT _____
 PE OK'D _____ EIS OK'D _____
 CAT'Y _____ BID LET _____
 HEARING _____ COMPL'T _____

RELATIONSHIP TO ADOPTED TRANSPORTATION PLAN
 LONG RANGE ELEMENT _____ TSM ELEMENT _____

FUNDING PLAN BY FISCAL YEAR (\$000)

	FY 84	FY 85	FY 86	FY 87	Post 87	TOTAL
TOTAL	118	353	249	2,224	6,056	9,000
FEDERAL	100	300	212	1,890	5,148	7,650
STATE						
LOCAL	18	53	37	334	908	1,350

APPLICANT'S ESTIMATE OF TOTAL PROJECT COST

PRELIM ENGINEERING \$ 720
 CONSTRUCTION 8,280
 RIGHT OF WAY _____
 TRAFFIC CONTROL _____
 ILLUMIN, SIGNS, _____
 LANDSCAPING, ETC _____
 STRUCTURES _____
 RAILROAD CROSSINGS _____
 TOTAL \$ 9,000

LOCATION MAP

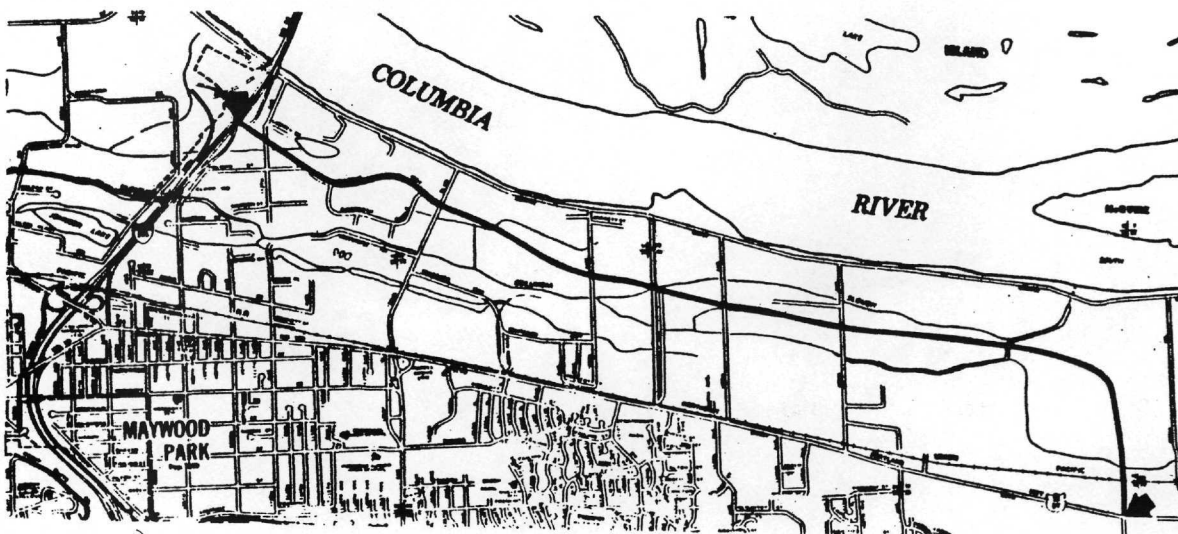

SOURCE OF FUNDS (%)

FEDERAL
 FAUS (PORTLAND) _____
 FAUS (OREGON REGION) _____
 FAUS (WASH REGION) _____
 UMTA CAPITAL _____ UMTA OPRTG _____
 INTERSTATE _____
 FED AID PRIMARY _____
 INTERSTATE _____
 SUBSTITUTION 85
 NON FEDERAL
 STATE _____ LOCAL 15

PROJECT INFORMATION FORM - TRANSPORTATION IMPROVEMENT PROGRAM

PROJECT DESCRIPTION
RESPONSIBILITY (AGENCY) City of Portland
LIMITS Marine Drive to Lombard Street **LENGTH** 0.5 mile
DESCRIPTION This project will construct approaches to the Rivergate Slough Bridge connecting with Rivergate Dr. to the north and Lombard St. to the south. The facility will have two lanes with curbs, lighting and drainage and bike lanes. This will provide direct access between the northern and southern portions of the Rivergate Industrial district.
Concept Program - New Projects (highway) #2

PROJECT NAME Rivergate Drive
ID No FAU 9958
APPLICANT City of Portland

SCHEDULE
TO ODOT _____
PE OK'D _____ **EIS OK'D** _____
CAT'Y _____ **BID LET** _____
HEARING _____ **COMPL'T** _____

RELATIONSHIP TO ADOPTED TRANSPORTATION PLAN
LONG RANGE ELEMENT _____ **TSM ELEMENT** _____

FUNDING PLAN BY FISCAL YEAR (\$000)

	FY 82	FY 83	FY 84	FY 85	FY 86	TOTAL
TOTAL			1,100			1,100
FEDERAL			935			935
STATE						
LOCAL			165			165

APPLICANT'S ESTIMATE OF TOTAL PROJECT COST

PRELIM ENGINEERING	\$	24
CONSTRUCTION		1,076
RIGHT OF WAY		
TRAFFIC CONTROL		
ILLUMIN, SIGNS, LANDSCAPING, ETC		
STRUCTURES		
RAILROAD CROSSINGS		
TOTAL	\$	1,100

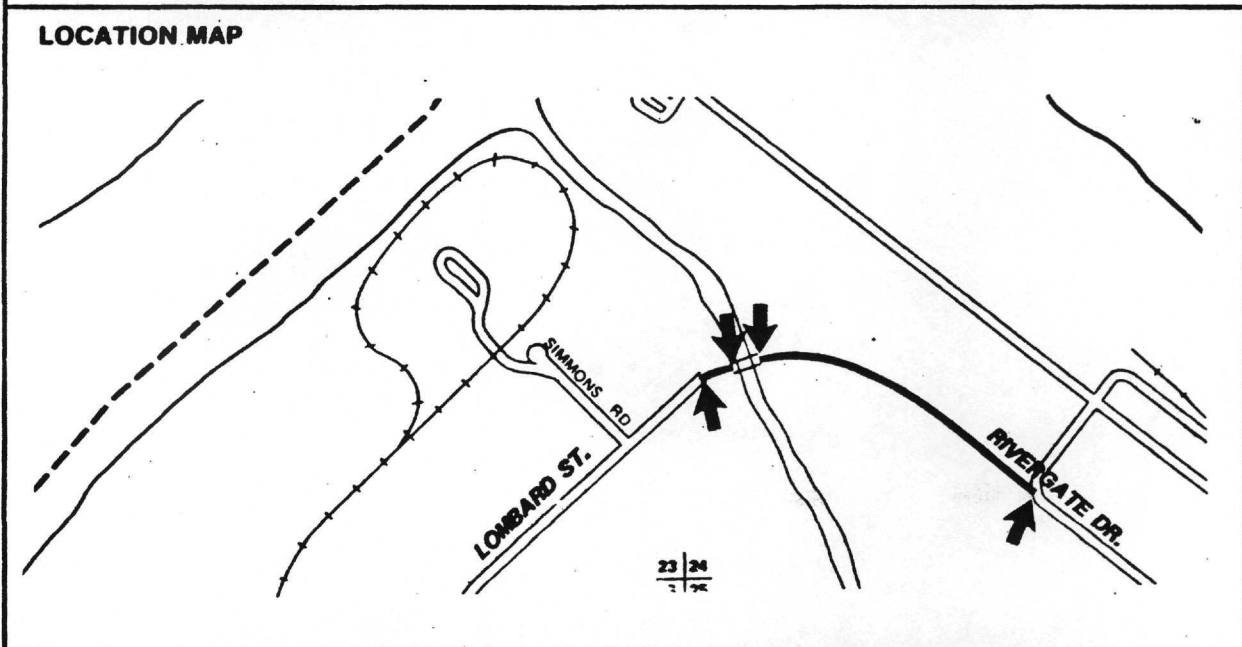

SOURCE OF FUNDS (%)

FEDERAL

FAUS (PORTLAND)	_____
FAUS (OREGON REGION)	_____
FAUS (WASH REGION)	_____
UMTA CAPITAL	_____ UMTA OPRTG _____
INTERSTATE	_____
FED AID PRIMARY	_____
INTERSTATE SUBSTITUTION	85
NON FEDERAL	_____
STATE	_____ LOCAL 15

EFFECTIVE 01-OCT-83

METROPOLITAN SERVICE DISTRICT
 PORTLAND URBANIZED AREA
 TRANSPORTATION IMPROVEMENT PROGRAM
 FISCAL YEARS 1984 TO POST 1987

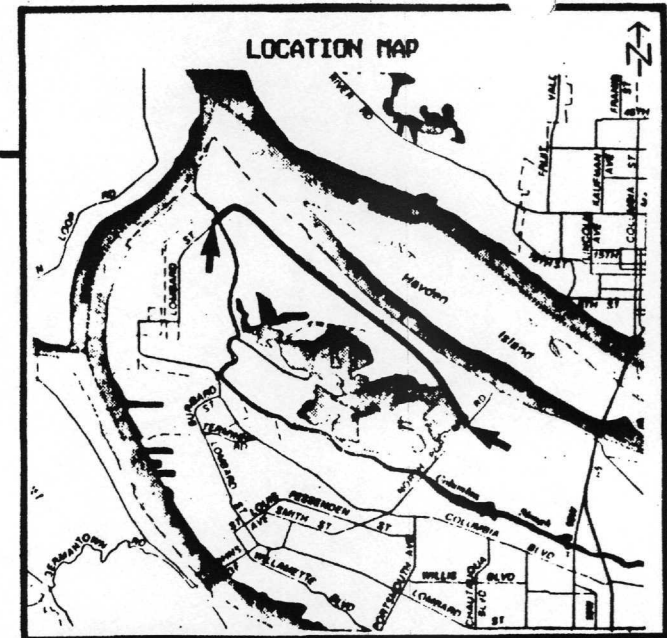

PROJECT NAME : N RIVERGATE DRIVE-LOMBARD TO PORTLAND ROAD
 PROJECT SPONSOR : CITY OF PORTLAND
 FEDERAL AID ROUTE: FAU9958
 FUNCTIONAL CLASS : MINOR ARTERIAL
 LENGTH IN MILES : 4.0

CURRENT AUTHORIZATION	FAIX	TOTAL
LOCAL MATCH	170,000	170,000
STATE MATCH	30,000	30,000
TOTAL COST	0	0
	200,000	200,000

	OBLIGATED	FUNDING PLAN BY FISCAL YEAR					POST 1987	AUTHORIZED	CURR EXCESS
		1983	1984	1985	1986	1987			
FAIX	0	0	0	0	0	0	0	0	
PE	0	0	0	0	0	0	0	0	
RESRV	0	0	0	0	0	0	170,000	170,000	
TOTAL	0	0	0	0	0	0	0	170,000	

NOTE: SPECIFIC WORK PHASES TO BE LATER ALLOCATED

PROJECT DESCRIPTION

RIVERGATE DRIVE WILL BE EXPANDED TO FOUR LANES TO SERVE THE INDUSTRIAL AND PORT RELATED FACILITIES IN THE NORTH RIVERGATE AREA AND TO PROVIDE IMPROVED AC-

CESS FROM I-5 TO RIVERGATE. THE EXISTING TWO LANES OF RIVERGATE DRIVE WILL SERVE AS THE EASTBOUND LANES, A NEW TWO LANE SEGMENT WILL BE BUILT TO SERVE AS

THE WESTBOUND LANES. THE FINAL RESULT WILL BE A BOULEVARD WITH A MEDIAN PLANTING STRIP AND LEFT TURN LANES.

EFFECTIVE 01-OCT-83

METROPOLITAN SERVICE DISTRICT
 PORTLAND URBANIZED AREA
 TRANSPORTATION IMPROVEMENT PROGRAM
 FISCAL YEARS 1984 TO POST 1987

PROJECT NAME : N RIVERGATE SLOUGH BRIDGE-LOMBARD TO RIVERGATE DRIVE
 PROJECT SPONSOR : CITY OF PORTLAND
 FEDERAL AID ROUTE : FAU9938
 FUNCTIONAL CLASS : MINOR ARTERIAL
 LENGTH IN MILES : 0.2

CURRENT AUTHORIZATION	FAIX	TOTAL
LOCAL MATCH	85,000	85,000
STATE MATCH	15,000	15,000
TOTAL COST	0	0
	100,000	100,000

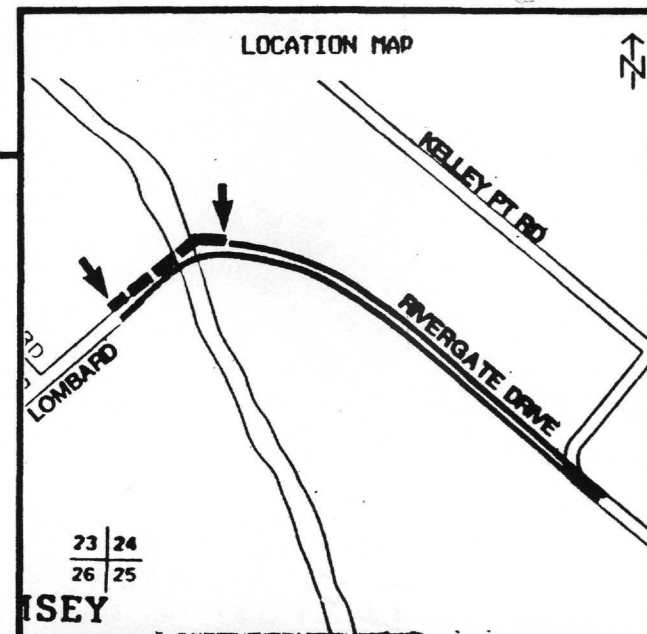

OBLIGATED	FUNDING PLAN BY FISCAL YEAR						POST 1987	AUTHORIZED	CURR EXCESS
	1983	1984	1985	1986	1987				
FAIX	0	0	0	0	0	0	0	0	0
PE	0	0	0	0	0	0	85,000	85,000	0
RESRV	0	0	0	0	0	0	0	85,000	0
TOTAL	0	0	0	0	0	0	0	85,000	0

NOTE: SPECTIFIC WORK PHASES TO BE LATER ALLOCATED

PROJECT DESCRIPTION

THIS IS A COMPANION PROJECT TO THE RIVERGATE PROJECT. THIS PROJECT WILL CONSTRUCT THE EASTERLY OF TWO SPANS OVER THE COLUMBIA SLOUGH.

THIS WILL PROVIDE THE FINAL LINK IN A FULL FOUR-LANE ARTERIAL CONNECTION FROM NORTH PORTLAND ROAD TO LOMBARD STREET.

PROJECT INFORMATION FORM - TRANSPORTATION IMPROVEMENT PROGRAM

PORTLAND METROPOLITAN AREA

PROJECT DESCRIPTION

RESPONSIBILITY (AGENCY) City of Portland/ ODOT

LIMITS NW Kittridge, St. Helens Rd., Willamette R., Burnside, 25th, 14th

DESCRIPTION

A Transportation Systems Management project consisting of a Traffic Management Committee, Traffic Monitoring, Rideshare and Public Info. Programs and construction projects to reduce the negative construction impacts of the I-505 projects on industrial traffic access, businesses and residential neighborhoods.

PROJECT NAME Northwest Transportation Systems Management Program

ID No _____

APPLICANT City of Portland

SCHEDULE

TO ODOT _____

PE OK'D _____ EIS OK'D _____

CAT'Y _____ BID LET _____

HEARING _____ COMPL'T _____

RELATIONSHIP TO ADOPTED TRANSPORTATION PLAN

LONG RANGE ELEMENT _____ TSM ELEMENT X

FUNDING PLAN BY FISCAL YEAR (\$000)

	FY 83	FY 84	FY 85	FY 86	FY 87	TOTAL
TOTAL	_____	<u>62,500</u>	<u>93,750</u>	<u>56,250</u>	<u>37,500</u>	<u>250,000</u>
FEDERAL	_____	<u>53,125</u>	<u>79,688</u>	<u>47,812</u>	<u>31,875</u>	<u>212,500</u>
STATE	_____	<u>4,687</u>	<u>7,031</u>	<u>4,219</u>	<u>2,812</u>	<u>18,750</u>
LOCAL	_____	<u>4,688</u>	<u>7,031</u>	<u>4,219</u>	<u>2,813</u>	<u>18,750</u>
_____	_____	_____	_____	_____	_____	_____
_____	_____	_____	_____	_____	_____	_____

APPLICANT'S ESTIMATE OF TOTAL PROJECT COST

PRELIM ENGINEERING \$ 62,500

CONSTRUCTION 187,500

RIGHT OF WAY _____

TRAFFIC CONTROL _____

ILLUMIN, SIGNS, _____

LANDSCAPING, ETC _____

STRUCTURES _____

RAILROAD CROSSINGS _____

TOTAL \$ 250,000

LOCATION MAP (general)

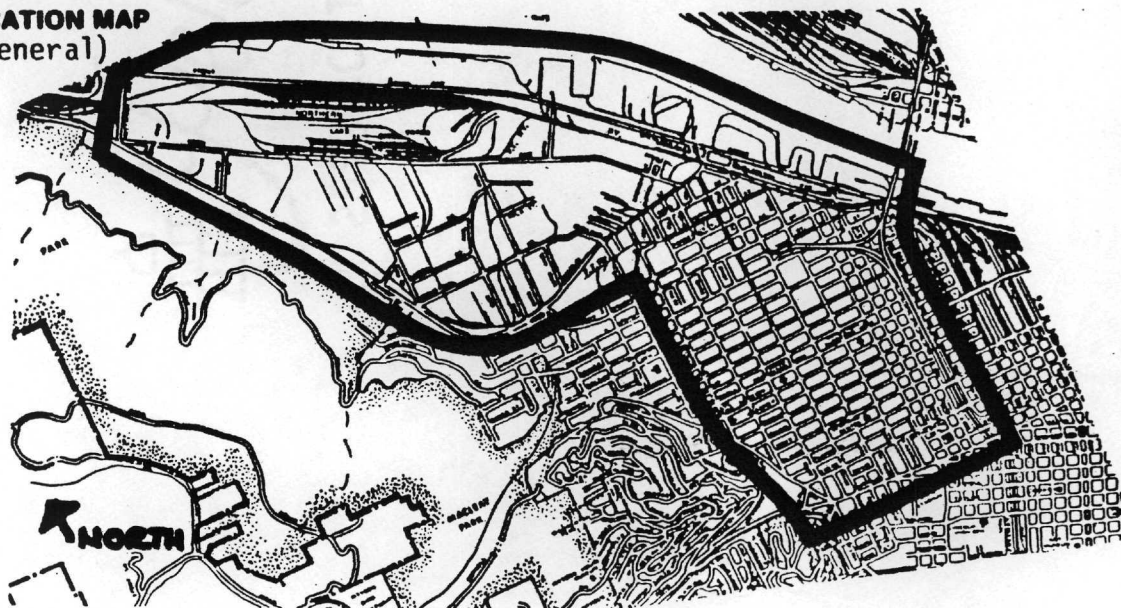

SOURCE OF FUNDS (%)

FEDERAL _____

FAUS (PORTLAND) _____

FAUS (OREGON REGION) _____

FAUS (WASH REGION) _____

UMTA CAPITAL _____ UMTA OPRTG _____

INTERSTATE _____

FED AID PRIMARY _____

INTERSTATE _____

SUBSTITUTION 85%

NON FEDERAL _____

STATE _____ LOCAL *15%

*Split between state/city

PROJECT INFORMATION FORM - TRANSPORTATION IMPROVEMENT PROGRAM

ATTACHMENT 7
PORTLAND METROPOLITAN AREA

PROJECT DESCRIPTION

RESPONSIBILITY (AGENCY) Oregon Department of Transportation (ODOT)
LIMITS N/A **LENGTH** 0.1 mile
DESCRIPTION This project will widen Highway 43 at its intersection with McKillican/Hood Avenue to include left-turn lanes in both the northbound and southbound directions. Work will include left-turn channelization, new curbs and sidewalks and reconstruction of the bicycle lane at this intersection.

Concept Program - New Projects (highway) #239

PROJECT NAME Highway 43 @ McKillican/Hood Avenue
ID No FAU 9565
APPLICANT ODOT

SCHEDULE

TO ODOT _____
PE OK'D _____ **EIS OK'D** _____
CAT'Y _____ **BID LET** _____
HEARING _____ **COMPL'T** _____

RELATIONSHIP TO ADOPTED TRANSPORTATION PLAN
LONG RANGE ELEMENT _____ **TSM ELEMENT** _____

FUNDING PLAN BY FISCAL YEAR (\$000)

	FY 82	FY 83	FY 84	FY 85	FY 86	TOTAL
TOTAL	_____	_____	200	_____	_____	200
FEDERAL	_____	_____	170	_____	_____	170
STATE	_____	_____	30	_____	_____	30
LOCAL	_____	_____	_____	_____	_____	_____
_____	_____	_____	_____	_____	_____	_____

APPLICANT'S ESTIMATE OF TOTAL PROJECT COST

PRELIM ENGINEERING \$ _____
CONSTRUCTION 200
RIGHT OF WAY _____
TRAFFIC CONTROL _____
ILLUMIN, SIGNS, LANDSCAPING, ETC _____
STRUCTURES _____
RAILROAD CROSSINGS _____

TOTAL \$ 200

LOCATION MAP

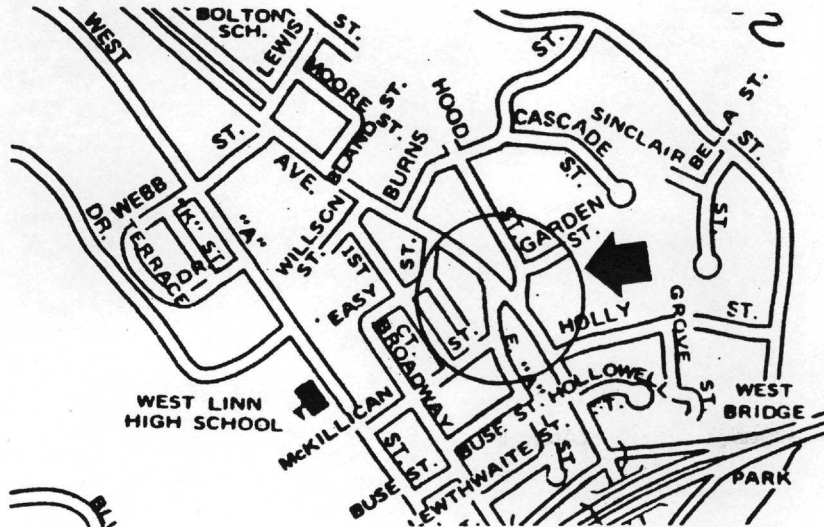

SOURCE OF FUNDS (%)

FEDERAL
FAUS (PORTLAND) _____
FAUS (OREGON REGION) _____
FAUS (WASH REGION) _____
UMTA CAPITAL _____ **UMTA OPRTG** _____
INTERSTATE _____
FED AID PRIMARY INTERSTATE _____
SUBSTITUTION 85

NON FEDERAL
STATE 15 **LOCAL** _____

ATTACHMENT 8a

BEAVERCREEK ROAD EXTENSION

Proposed Project Description

This addition to the RTP consists of minor improvements to Beaver Creek Road between the Oregon City Bypass and a point east of Highway 213. From this point westward, Beaver Creek Road will be extended approximately 3,100 feet in a 60-80 foot right-of-way. All right-of-way on the county and Randall properties will be dedicated to the city. Right-of-way will have to be purchased from the Care Center, Danielson's, and Clairmont Club properties.

Figure 1 depicts alternative alignments. One alternative alignment would be to bring the new road to the west to intersect with Warner-Milne at the Kaen Road intersection. This would require additional work on Kaen to realign intersections with the new road and Library Court. It may also require that another road be constructed connecting Warner-Milne and the new road, running between the Carpenter's Hall and the apartments, to provide a second access point to the property from Warner-Milne.

The roadway improvement will consist of at least one travel lane in each direction, a center left-turn lane, and a planter and sidewalk on the north side of the street. Right-turn lanes will be added at the Molalla Avenue intersection. A storm drainage system will have to be incorporated into the roadway design. Also, since the road will be a low lying area, the existing drainage ditch will have to be placed in a culvert under the roadway. A sound barrier for the Care Center will be provided as part of the project. The abandoned part of the existing Beaver Creek right-of-way could be:

1) completely vacated, 2) partially vacated and used as the right turn lane onto Molalla Avenue, or 3) used as a local access street with no through traffic.

Objectives of the Project

The principal objectives of the project are to:

1. Provide direct and improved access to existing and planned commercial, office and industrial development in the Red Soils area;
2. Improve north/south traffic flow along Molalla Avenue (Highway 213); and
3. Improve east/west traffic flow through the area.

Degree to Which the Project Meets the Objectives

The proposed improvement would meet the stated objectives by ameliorating several problems that currently exist as follows:

OREGON

To I-205

Warner-Milne Rd.

Proposed Extension
CITY

Beavercreek

Road

Thayer Rd

O.C. Bypass

Maple Lane

Hwy 213

OREGON CITY CITY LIMITS

OREGON CITY

CITY LIMITS



Scale 1" = 1000'

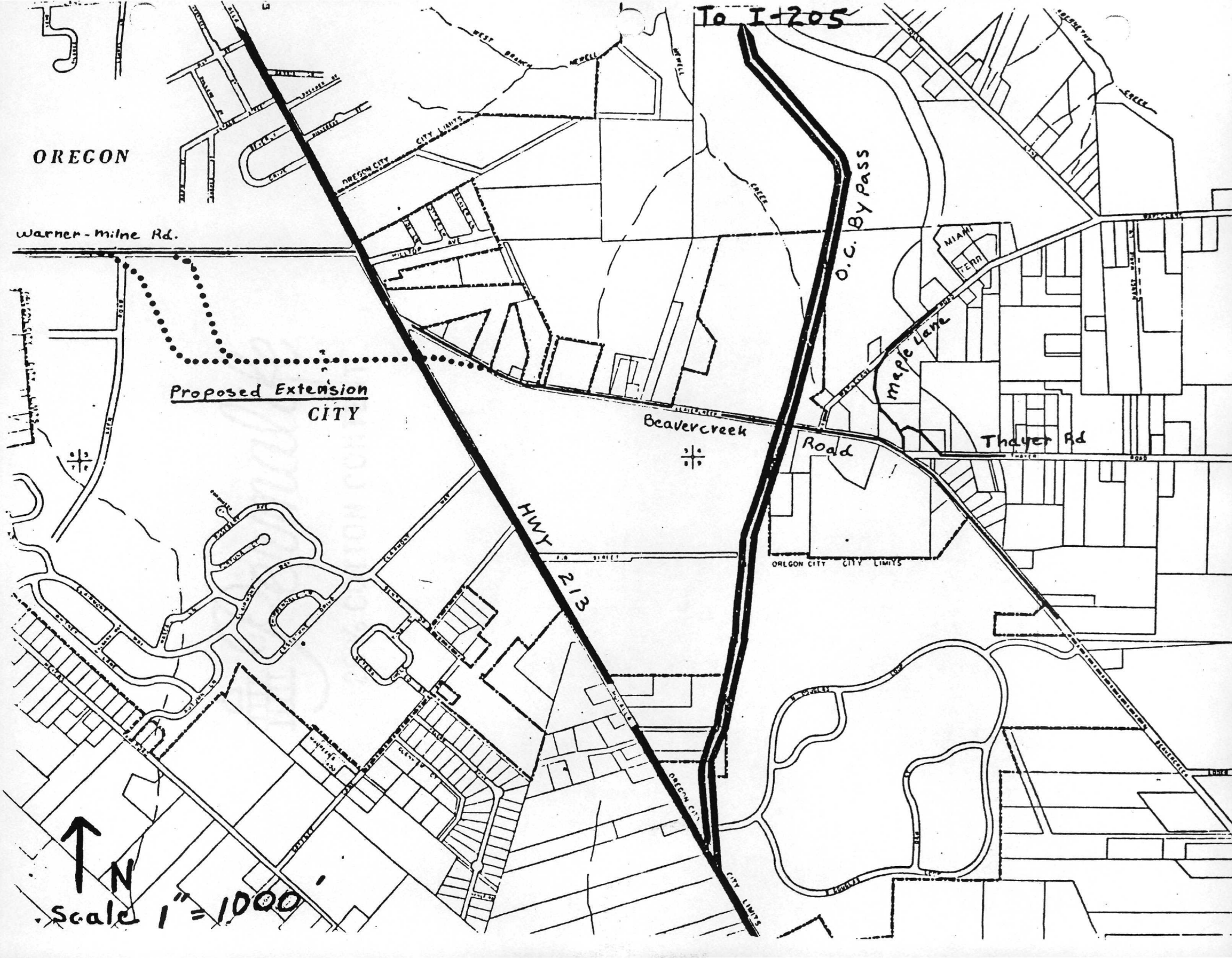

1. Currently, access to the existing commercial development is limited and circuitous, especially from the proposed Oregon City Bypass interchange with Beaver Creek Road. Adequate access to the developable acreage surrounding the existing development is virtually nonexistent. The proposed project would provide improved access from the bypass to both the existing and planned development on the Red Soils property.
2. Currently, north/south movements along Highway 213 adjacent to the Red Soils acreage are impeded by both the conflicting east/west movements that must use this section of Highway 213 as a connection between Beaver Creek and Warner-Milne Roads as well as the congestion related to weaving and left-turn movement conflict with through traffic caused by the proximity of the Beaver Creek and Warner-Milne intersections with Highway 213. This section currently carries about 26,000 AWD although this volume will drop greatly with the opening of the bypass. The proposed improvement would address these problems by eliminating the need for east/west traffic to use Highway 213 and provide increased separation between the intersections.
3. As noted above, current east/west travel through the Red Soils area must travel north/south on Highway 213 and then turn left to continue onto either Warner-Milne or Beaver Creek Roads. The proposed improvement would eliminate: a) the Highway 213 leg of the east/west movement altogether; b) the need to make a left-turn in the west to east direction; and c) relocate to a point near Kaen Road the left turn onto Warner-Milne Road required in the east to west direction. These changes would significantly improve the east/west accessibility and traffic flow through the area.

Impact of the Project on the Balance of the System

The proposed project would have the following beneficial effects on the regional system in the Red Soils area:

1. Improve access from the Oregon City Bypass (a regional Principal route) to the principal existing and planned retail shopping opportunity in the hilltop area of Oregon City; and
2. Improve north/south traffic flows on Highway 213 (a regional Major Arterial) by removing conflicting east-west traffic and lengthening the distance between major intersections.

Impact of the Project on Other RTP Objectives

The proposed improvement would further the following other RTP objectives:

1. Improve access to existing jobs and shopping opportunities;
2. Improve access to markets for retail developments;
3. By improving north/south and east/west travel flows, reduce energy consumption and vehicle emissions compared to a no-build condition; and
4. Improve access to vacant, developable land and facilitate economic development.

AC/srb
8880B/349
12/13/83

PROJECT INFORMATION FORM - TRANSPORTATION IMPROVEMENT PROGRAM

PROJECT DESCRIPTION

RESPONSIBILITY (AGENCY) Clackamas County
LIMITS Beavercreek Road to Warner-Milne Road **LENGTH** 0.6 mile
DESCRIPTION This project will extend Beavercreek Road to the west through a new intersection with Highway 213 and then angle north to Warner-Milne Road. This new roadway will consist of at least one lane in each direction with a center left-turn lane, sidewalks and drainage facilities. This will provide access to the Oregon City bypass and will open a large amount of vacant land to potential development.

Concept Program - New Projects (highway) #205

PROJECT NAME Beavercreek Road Extension (Red Soils)
ID No FAU 9742
APPLICANT Clackamas County

SCHEDULE

TO ODOT _____
PE OK'D _____ **EIS OK'D** _____
CAT'Y _____ **BID LET** _____
HEARING _____ **COMPL'T** _____

RELATIONSHIP TO ADOPTED TRANSPORTATION PLAN
LONG RANGE ELEMENT _____ **TSM ELEMENT** _____

FUNDING PLAN BY FISCAL YEAR (\$000)

	FY 82	FY 83	FY 84	FY 85	FY 86	TOTAL
TOTAL	_____	_____	153	_____	_____	153
FEDERAL	_____	_____	130	_____	_____	130
STATE	_____	_____	_____	_____	_____	_____
LOCAL	_____	_____	23	_____	_____	23
_____	_____	_____	_____	_____	_____	_____
_____	_____	_____	_____	_____	_____	_____

APPLICANT'S ESTIMATE OF TOTAL PROJECT COST

PRELIM ENGINEERING \$ 153
CONSTRUCTION _____
RIGHT OF WAY _____
TRAFFIC CONTROL _____
ILLUMIN, SIGNS, LANDSCAPING, ETC _____
STRUCTURES _____
RAILROAD CROSSINGS _____

TOTAL \$ 153

LOCATION MAP

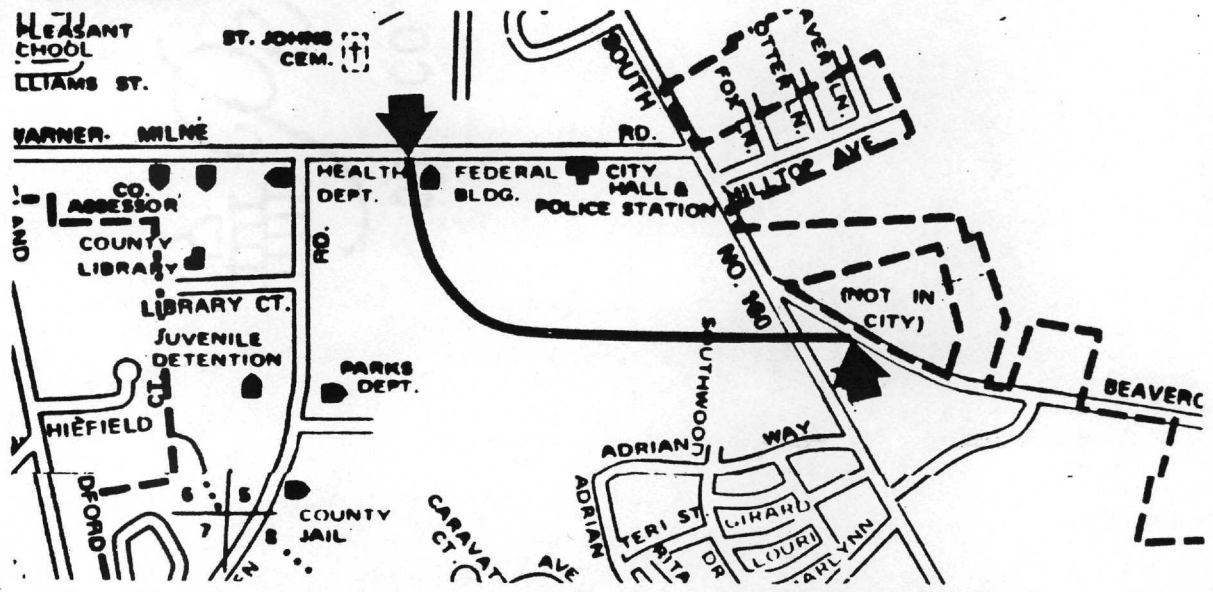

SOURCE OF FUNDS (%)

FEDERAL
FAUS (PORTLAND) _____
FAUS (OREGON REGION) _____
FAUS (WASH REGION) _____
UMTA CAPITAL _____ **UMTA OPRTG** _____
INTERSTATE _____
FED AID PRIMARY _____
INTERSTATE SUBSTITUTION 85

NON FEDERAL
STATE _____ **LOCAL** 15

ATTACHMENT 9a

13TH AND GERTZ (VANCOUVER WAY-COLUMBIA BOULEVARD)

Proposed Project Description

This addition to the RTP consists of reconstruction to a two-lane industrial standard including: 1) upgrading Gertz Road from a point west of 9th 700 feet to a redesigned and improved intersection with Vancouver Way; 2) relocating 2,800 feet of roadway to the south the connection between Gertz Road and 13th and closing 13th at a point north of the new intersection; 3) upgrading 13th to the Columbia Slough; 4) constructing a new bridge over the Columbia Slough; and 5) constructing a connection from the new bridge to Columbia Boulevard via an alignment to be determined (see Figure 1). The project would be constructed in two phases with portions 1 through 3 listed above to be constructed within five years, and portions 4 and 5 (which traverse a potentially environmentally sensitive area and will likely require an Environmental Impact Statement (EIS)) at some point 11-20 years hence.

Objectives of the Project

The principal objectives of the project are to:

1. provide direct and improved access to 160 acres of developable industrially zoned land north of the Columbia Slough;
2. improve general circulation in the area by removing the barrier effect of the Columbia Slough and providing a north/south connection to Columbia Boulevard; and
3. reduce truck and other inappropriate industrial area traffic through the residential development surrounding the current Gertz Road/13th intersection and extending north along 13th.

Degree to Which the Project Meets the Objectives

The proposed improvement would meet the stated objectives by ameliorating several problems that currently exist:

1. Currently, there is no direct connection from the industrial area to Columbia Boulevard, the designated through truck route. In addition, access to the area from I-5 and I-205 is forced to use inadequate (Gertz Road) or inappropriate (13th) routes. The proposed project would provide a direct and improved collector level connection to Columbia Boulevard (and, via Columbia Boulevard, to I-205) as well as improve the Gertz Road facility to the intersection with Vancouver Way (already programmed for improvement) and, via Vancouver Way, to I-5.

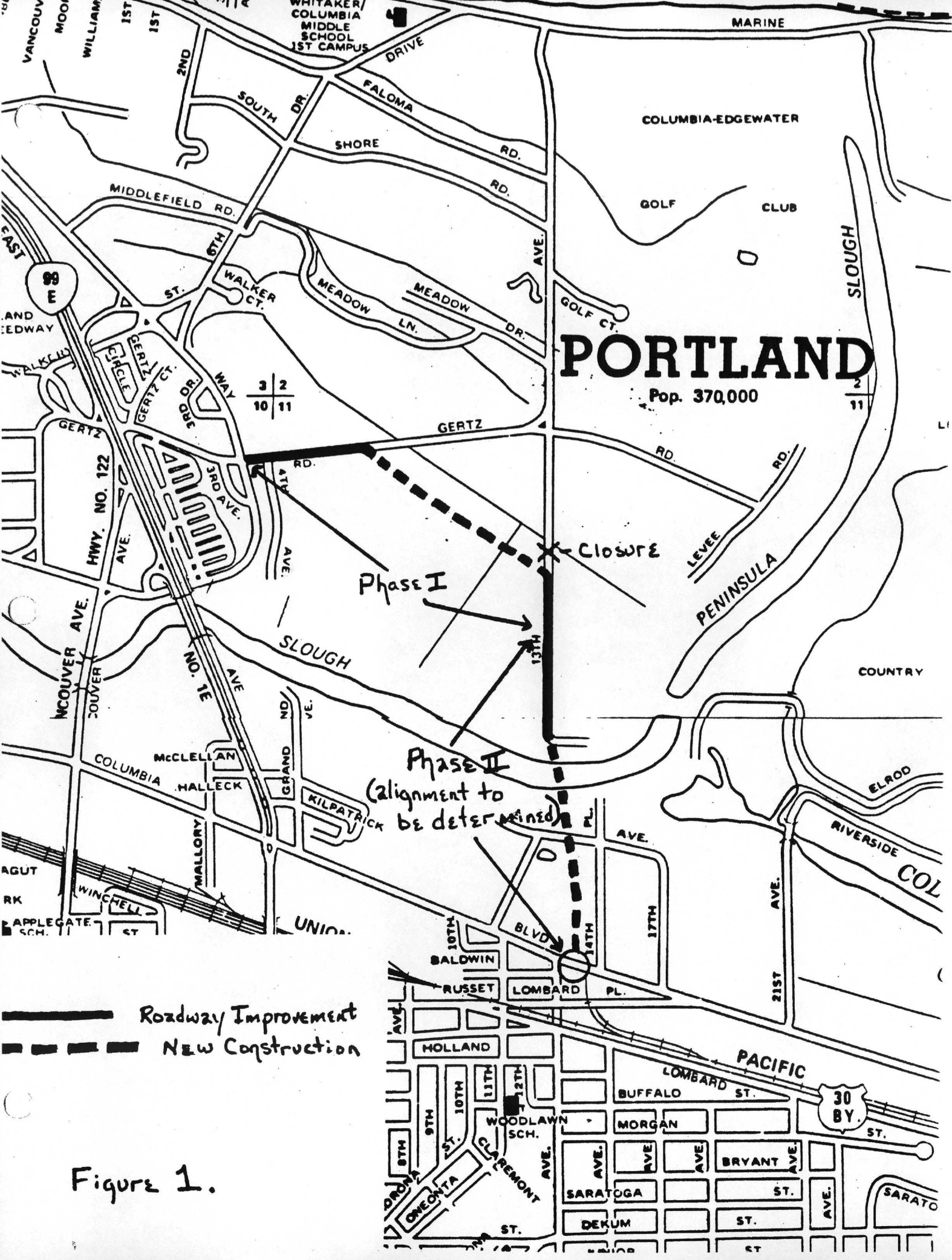

Figure 1.

2. Currently, the Columbia Slough presents a barrier to the development in the area and causes out-of-direction travel and poor circulation patterns. The second phase of the proposed improvement would remove the barrier by constructing a new bridge over the slough (subject to an EIS determination) and improve circulation by providing a continuous collector level route through the industrially zoned acreage connecting Columbia Boulevard and Vancouver Way.
3. Currently, traffic accessing the industrial acreage must pass through residential areas east of 9th on Gertz Road and south of the current intersection on 13th. By relocating the connection of Gertz and 13th to the south, and by disconnecting 13th north of the new intersection, the proposed project should greatly reduce inappropriate traffic through the neighborhood.

Impact of the Project on the Balance of the System

The proposed project would have the following beneficial effects on the street system in the area:

1. distribute traffic accessing the industrial area more evenly between Vancouver via Gertz and Columbia Boulevard via 13th; and
2. remove inappropriate traffic from 13th at Marine Drive.

Impact of the Project on Other RTP Objectives

The proposed improvement would further the following other RTP objectives:

1. improve access to developable industrial acreage and new jobs, thereby facilitating economic development; and
2. by reducing out of direction travel and improving circulation patterns in the area, reduce energy consumption and vehicle emissions compared to a no-build condition.

AC/srb
8880B/349
12/13/83

PROJECT INFORMATION FORM - TRANSPORTATION IMPROVEMENT PROGRAM

PROJECT DESCRIPTION

RESPONSIBILITY (AGENCY) City of Portland
LIMITS Vancouver Way to NE 13th Avenue **LENGTH** 0.7 mile
DESCRIPTION This project will provide access to industrially zoned land south of Gertz Road and at the same time will discourage industrial traffic through residential areas to the north. A portion of Gertz Road east of Vancouver Way will be improved and will be connected with NE 13th Avenue through construction of a new two-lane facility. NE 13th Avenue will be vacated between Gertz Road and its intersection with the new roadway.

Concept Program - New Projects (highway) #220

PROJECT NAME 13th & Gertz - Ph.I.
Industrial Access Road
ID No FAU 9961
APPLICANT City of Portland

SCHEDULE

TO ODOT _____
PE OK'D _____ **EIS OK'D** _____
CAT'Y _____ **BID LET** _____
HEARING _____ **COMPL'T** _____

RELATIONSHIP TO ADOPTED TRANSPORTATION PLAN
LONG RANGE ELEMENT _____ **TSM ELEMENT** _____

FUNDING PLAN BY FISCAL YEAR (\$000)

	FY 82	FY 83	FY 84	FY 85	FY 86	TOTAL
TOTAL			92		809	901
FEDERAL			78		688	766
STATE						
LOCAL			14		121	135

APPLICANT'S ESTIMATE OF TOTAL PROJECT COST

PRELIM ENGINEERING \$ 92
CONSTRUCTION 809
RIGHT OF WAY _____
TRAFFIC CONTROL _____
ILLUMIN, SIGNS, LANDSCAPING, ETC _____
STRUCTURES _____
RAILROAD CROSSINGS _____

TOTAL \$ 901

LOCATION MAP

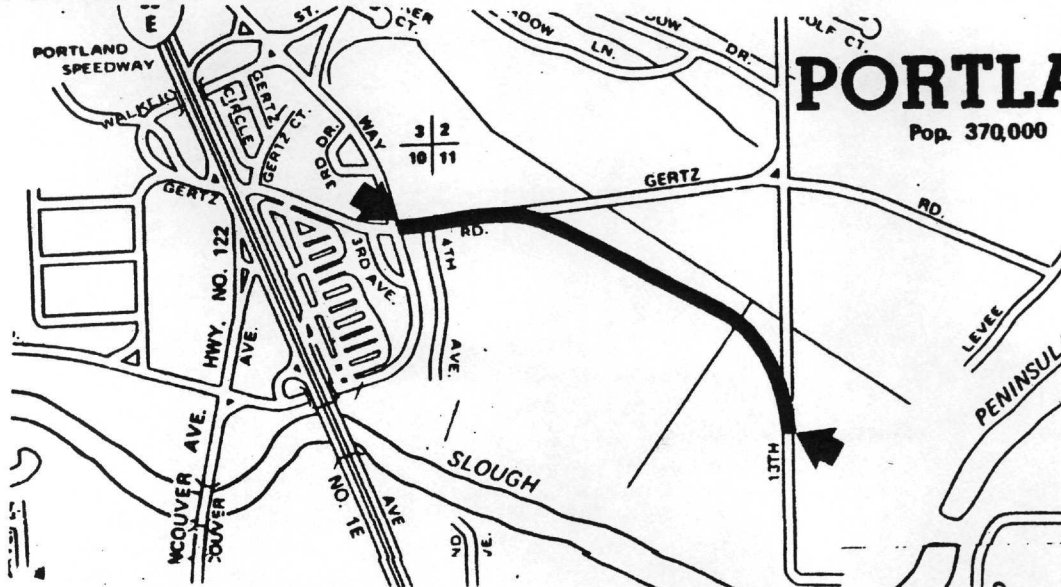

SOURCE OF FUNDS (%)

FEDERAL
FAUS (PORTLAND) _____
FAUS (OREGON REGION) _____
FAUS (WASH REGION) _____
UMTA CAPITAL _____ **UMTA OPRTG** _____
INTERSTATE _____
FED AID PRIMARY _____
INTERSTATE _____
SUBSTITUTION 85
NON FEDERAL
STATE _____ **LOCAL** 15

METROPOLITAN SERVICE DISTRICT
 TRANSPORTATION IMPROVEMENT PROGRAM
 QUARTERLY REPORT FOR QUARTER ENDING 30-JUN-83
 FAU/E4 PROJECTS BY SPONSOR AND FUNDING SOURCE
 14-Dec-83

PHASES
 TIPSON.DAT

	OBLIGATED	1983	1984	1985	1986	1987	POST 1987	AUTHORIZED	
CATEGORY I PROJECTS									
1 BANFIELD TRANSITWAY-HIGHWAY FUNDS**115*224*223*****FAP68									80900
INTERSTATE TRANSFER FUNDS									
PE	5,192,931	0	0	0	0	0	0	5,192,931	
R/W	8,927,639	0	0	0	0	0	0	8,927,639	
CONST	12,526,885	-62,954	0	0	0	0	0	12,463,931	
TOTAL	26,647,455	-62,954	0	0	0	0	0	26,584,501	
2 BANFIELD TRANSITWAY-TRANSIT FUNDS**116*226*275*317*360*432*490*519*446*225*****FAP68									80900
INTERSTATE TRANSFER FUNDS									
PE	6,564,267	4,765,090	0	0	0	0	0	11,329,357	
R/W	11,139,228	0	0	0	0	0	0	11,139,228	
CONST	54,850,583	20,357,319	0	0	0	0	0	75,207,902	
RESRV	0	32,807,591	9,860,000	298,822	0	0	5,927,475	48,893,888	
TOTAL	72,554,078	57,930,000	9,860,000	298,822	0	0	5,927,475	146,570,375	
3 WESTSIDE TRANSITWAY**117*228*229*227*****FAP27									10013
INTERSTATE TRANSFER FUNDS									
PE	2,250,036	0	0	0	0	0	0	2,250,036	
4 BANFIELD TRANSITWAY-METRO PLANNING**118*422*521*****FAP68									
INTERSTATE TRANSFER FUNDS									
PE	300,000	0	0	0	0	0	0	300,000	
5 TRI-MET TECHNICAL STUDY - 5 WORK ELEMENTS**120*230*****N/A									
INTERSTATE TRANSFER FUNDS									
PE	428,000	0	0	0	0	0	0	428,000	
6 METRO CORRIDOR PLANNING**126*522*423*****N/A									80404
INTERSTATE TRANSFER FUNDS									
PE	527,756	300,000	0	0	0	0	0	827,756	
RESRV	0	0	300,000	299,994	0	0	0	599,994	
TOTAL	527,756	300,000	300,000	299,994	0	0	0	1,427,750	

METROPOLITAN SERVICE DISTRICT
 TRANSPORTATION IMPROVEMENT PROGRAM
 QUARTERLY REPORT FOR QUARTER ENDING 30-JUN-83
 FAU/E4 PROJECTS BY SPONSOR AND FUNDING SOURCE
 14-Dec-83

PHASES
 TIPSON.DAT

	OBLIGATED	1983	1984	1985	1986	1987	POST 1987	AUTHORIZED	
CATEGORY I PROJECTS (CONTINUED)									
7 MCDUGHLIN CORRIDOR-UNION/GRAND AVE VIADUCT TO SE RIVER ROAD**127*237*238*235*236***** FAP26									77159
INTERSTATE TRANSFER FUNDS									
PE	437,425	0	0	0	0	0	0	437,425	
RESRV	0	0	0	0	0	0	24,772,612	24,772,612	
TOTAL	437,425	0	0	0	0	0	24,772,612	25,210,037	
8 MCDUGHLIN BLVD INTERSECTION AND SIGNAL IMPROVEMENTS**147*245***** FAP26									80058
INTERSTATE TRANSFER FUNDS									
PE	115,070	30	0	0	0	0	0	115,100	
R/W	0	8,500	0	0	0	0	0	8,500	
CONST	0	857,462	0	0	0	0	0	857,462	
RESRV	0	0	0	0	0	0	-71,977	-71,977	
TOTAL	115,070	865,992	0	0	0	0	-71,977	909,085	
9 POWELL BLVD R/W & CONSTRUCTION-ROSS ISLAND BRIDGE TO 52ND-SECT I**162*276***** FAP24									80069
INTERSTATE TRANSFER FUNDS									
PE	172,027	0	0	0	0	0	0	172,027	
R/W	1,340,550	0	0	0	0	0	0	1,340,550	
CONST	3,617,962	0	0	0	0	0	0	3,617,962	
RESRV	0	0	0	0	0	0	51,071	51,071	
TOTAL	5,130,539	0	0	0	0	0	51,071	5,181,610	
10 POWELL BLVD R/W & CONST-50TH AVE TO I205-SECTION II**164*278*277*491***** FAP24									76012
INTERSTATE TRANSFER FUNDS									
PE	487,356	0	0	0	0	0	0	487,356	
R/W	6,266,675	0	0	0	0	0	0	6,266,675	
CONST	4,199,502	0	0	0	0	0	0	4,199,502	
RESRV	0	0	0	0	0	0	810,948	810,948	
TOTAL	10,953,533	0	0	0	0	0	810,948	11,764,480	
11 SUNSET HIGHWAY OVERLAYS - CONSTRUCTION**267*408***** FAP27									78086
INTERSTATE TRANSFER FUNDS									
CONST	1,422,729	0	0	0	0	0	0	1,422,729	

METROPOLITAN SERVICE DISTRICT
 TRANSPORTATION IMPROVEMENT PROGRAM
 QUARTERLY REPORT FOR QUARTER ENDING 30-JUN-83
 FAU/E4 PROJECTS BY SPONSOR AND FUNDING SOURCE
 14-Dec-83

PHASES
 TIPSON.DAT

	OBLIGATED	1983	1984	1985	1986	1987	POST 1987	AUTHORIZED	
CATEGORY I PROJECTS (CONTINUED)									
12 RECONSTRUCTION OF YEON/VAUGHN/NICOLAI/WARDWAY AND ST HELENS RD***269*426***** MISC									79038
INTERSTATE TRANSFER FUNDS									
PE	442,128	328,822	0	0	0	0	779,525 0	770,950	
RESRV	0	0	0	0	0	0	992,025 779,525	992,025 779,525	
TOTAL	442,128	328,822	0	0	0	0	992,025 1,550,475	1,762,975 1,550,475	
<i>12A I-405 Traffic Mgmt. Program 1983: \$212,500</i>									212,500
13 BANFIELD LRT STATION AREA PLANNING PROGRAM***290*447***** N/A									80900
INTERSTATE TRANSFER FUNDS									
PE	1,028,069	0	0	0	0	0	0	1,028,069	
RESRV	0	0	0	0	0	0	528,194	528,194	
TOTAL	1,028,069	0	0	0	0	0	528,194	1,556,264	
14 TRI-MET RIDESHARE PROGRAM***295*475*411*495*248*474***** N/A									80303
INTERSTATE TRANSFER FUNDS									
OPRTC	337,788	87,912	0	68,143	53,995	0	0	547,838	
RESRV	201,857	552,089	0	250,232	215,125	0	0	1,219,302	
TOTAL	539,645	640,000	0	318,375	269,120	0	0	1,767,140	
15 I5 NORTH RIDESHARE PROGRAM***296*496*476***** N/A									80043
INTERSTATE TRANSFER FUNDS									
PE	95,379	0	0	0	0	0	0	95,379	
OPRTC	69,621	0	0	0	0	0	0	69,621	
TOTAL	165,000	1	0	0	0	0	0	165,001	
16 PORTLAND/VANCOUVER CORRIDOR ANALYSIS...BI-STATE TASK FORCE*44***310*523*502***** N/A									80032
INTERSTATE TRANSFER FUNDS									
PE	72,311	0	0	0	0	0	0	72,311	
RESRV	0	0	0	0	0	0	-61	-61	
TOTAL	72,311	0	0	0	0	0	-61	72,250	
17 WESTSIDE CORRIDOR RELATED HIGHWAY PROJECTS-FHWA FUNDED***559*524*250***** N/A									10013
INTERSTATE TRANSFER FUNDS									
PE	59,500	0	0	0	0	0	0	59,500	

METROPOLITAN SERVICE DISTRICT
 TRANSPORTATION IMPROVEMENT PROGRAM
 QUARTERLY REPORT FOR QUARTER ENDING 30-JUN-83
 FAU/E4 PROJECTS BY SPONSOR AND FUNDING SOURCE
 14-Dec-83

PHASES
 TIPSON.DAT

	OBLIGATED	1983	1984	1985	1986	1987	POST 1987	AUTHORIZED	
CATEGORY I PROJECTS (CONTINUED)									
18 MCLOUGHLIN CORRIDOR TRANSIT ANALYSIS***598*256***** FAP26									
INTERSTATE TRANSFER FUNDS									
PE	100,000	0	0	0	0	0	0	100,000	
RESRV	0	0	0	0	0	0	-1	-1	
TOTAL	100,000	0	0	0	0	0	-1	99,999	
19 REGIONAL RESERVE***625*525*424***** N/A									
INTERSTATE TRANSFER FUNDS									
RESRV	0	0	0	0	0	0	142,789	142,789	
20 WESTSIDE RESERVE***688*257*402*373*481*338***** FAP27									
INTERSTATE TRANSFER FUNDS									
RESRV	0	0	0	0	0	0	0	0	
21 NW NICOLAI ST-NW 29TH TO NW 24TH***731*427***** FAU9296 79038									
INTERSTATE TRANSFER FUNDS									
R/W	43,775	85,000	0	0	0	0	0	128,775	
CONST	1,613,754	0	0	0	0	0	0	1,613,754	
RESRV	0	0	0	0	0	0	126,090	126,090	
TOTAL	1,657,529	85,000	0	0	0	0	126,090	1,868,619	
22 NW YEON AVE-NW ST HELENS RD TO NW NICOLAI***733*428***** FAP1 79038									
INTERSTATE TRANSFER FUNDS									
R/W	2,125,000	0	0	0	0	0	0	2,125,000	
CONST	0	0	0	9,945,000	0	0	0	9,945,000	
RESRV	0	0	0	0	0	0	610,685	610,685	
TOTAL	2,125,000	0	0	9,945,000	0	0	610,685	12,680,685	
23 NW ST HELENS RD-NW KITTRIDGE ST TO NW 29TH AVE***734*429***** FAU9296 79038									
INTERSTATE TRANSFER FUNDS									
CONST	0	1,530,000	0	0	1,770,000	0	0	3,300,000	
RESRV	0	0	0	0	0	0	226,127	226,127	
TOTAL	0	1,530,000	0	0	1,770,000	0	226,127	3,526,127	

METROPOLITAN SERVICE DISTRICT
 TRANSPORTATION IMPROVEMENT PROGRAM
 QUARTERLY REPORT FOR QUARTER ENDING 30-JUN-83
 FAU/E4 PROJECTS BY SPONSOR AND FUNDING SOURCE
 14-Dec-83

PHASES
 TIPSON.DAT

OBLIGATED	1983	1984	1985	1986	1987	POST 1987	AUTHORIZED

CATEGORY I PROJECTS (CONTINUED)							
24 VAUGHN ST/HARDWAY-NJ 29TH AVE TO NJ 24TH AVE***735*430***** FAU9296 79038							
INTERSTATE TRANSFER FUNDS							
CONST	0	0	0	954,948	0	0	954,948
RESRV	0	0	0	0	0	129,180	129,180
TOTAL	0	0	0	954,948	0	129,180	1,084,128
25 FRONT-YEON CONNECTION***738*431***** FAU9300 79038							
INTERSTATE TRANSFER FUNDS							
R/W	0	1,750,000	0	0	0	0	1,750,000
CONST	0	0	0	3,085,580	0	0	3,085,580
RESRV	0	0	0	0	0	404,372	404,372
TOTAL	0	1,750,000	0	3,085,580	0	404,372	5,239,952
26 REGIONAL RESERVE***755*374*445*302*513*341*520*448*260***** N/A							
INTERSTATE TRANSFER FUNDS							
RESRV	0	0	0	0	0	17,120,464	17,120,464
27 PHASE I ALTERNATIVES ANALYSIS***765*425***** MISC							
INTERSTATE TRANSFER FUNDS							
PE	170,000	0	80,000	0	0	0	250,000
28 BANFIELD CORRIDOR RIDESHARE MARKETING PROGRAM***770*263***** FAP68 10192							
INTERSTATE TRANSFER FUNDS							
OPRTC	0	53,380	0	0	0	0	53,380
29 BANFIELD TRAFFIC MONITORING PROGRAM***771*264***** FAP68 10183							
INTERSTATE TRANSFER FUNDS							
PE	0	23,290	0	0	0	0	23,290
CONST	0	170,000	0	0	0	0	170,000
TOTAL	0	193,290	0	0	0	0	193,290

METROPOLITAN SERVICE DISTRICT
 TRANSPORTATION IMPROVEMENT PROGRAM
 QUARTERLY REPORT FOR QUARTER ENDING 30-JUN-83
 FAU/E4 PROJECTS BY SPONSOR AND FUNDING SOURCE
 14-Dec-83

PHASE3
 TIPSON.DAT

OBLIGATED	1983	1984	1985	1986	1987	POST 1987	AUTHORIZED
-----------	------	------	------	------	------	-----------	------------

CATEGORY I PROJECTS (CONTINUED)

30 SUNSET LIGHT RAIL PROGRAM***773*265***** FAP27							
INTERSTATE TRANSFER FUNDS							
PE	0	500,000	0	0	0	0	500,000

31 UNALLOCATED RESERVE-OREGON STATE HIGHWAY DIVISION***792*414***** N/A							
INTERSTATE TRANSFER FUNDS							
RESRV	0	0	0	0	0	57,777	57,777

32 UNALLOCATED RESERVE-REGION***795*415***** N/A							
INTERSTATE TRANSFER FUNDS							
RESRV	0	0	0	0	0	53,153	53,153

33 SUNSET HIGHWAY RAMP METERING***827*266***** FAP27							
INTERSTATE TRANSFER FUNDS ^{22,000}							
CONST	0	0	0	748,000	0	0	770,000
				770,000			

34 OBLIGATIONAL AUTHORITY RESERVE-CATEGORY I***832*416***** N/A							
INTERSTATE TRANSFER FUNDS							
RESRV	0	2,673,618	0	0	0	-2,673,618	0
		2,439,118					

AGENCY TOTAL: CATEGORY I

FEDERAL AID URBAN SYSTEM FUNDS							
TOTAL	0	0	0	0	0	0	0

INTERSTATE TRANSFER FUNDS							
PE	18,442,255	5,917,234	80,000	0	0	0	24,439,489
R/W	29,842,867	1,843,500	0	0	0	0	31,686,367
CONST	78,231,415	22,851,826	0	13,800,580	2,724,948	0	117,608,769
GPRTG	407,409	141,292	0	68,143	53,995	0	670,839
RESRV	201,857	36,033,298	10,160,000	849,048	215,125	0	49,207,306
TOTAL	127,125,803	66,787,149	10,240,000	14,717,771	2,994,068	0	49,207,306
							271,072,096

METROPOLITAN SERVICE DISTRICT
 TRANSPORTATION IMPROVEMENT PROGRAM
 QUARTERLY REPORT FOR QUARTER ENDING 30-JUN-83
 FAU/E4 PROJECTS BY SPONSOR AND FUNDING SOURCE
 14-Dec-83

PAGE 7

PHASES TIPSON.DAT	OBLIGATED	1983	1984	1985	1986	1987	POST 1987	AUTHORIZED
CATEGORY I PROJECTS (CONTINUED)								
ISOS TRANSFER FUNDS								
TOTAL	0	0	0	0	0	0	0	0
AGENCY TOTAL: CATEGORY I								
PE	18,442,255	5,917,234	80,000	0	0	0	0	24,439,489
R/W	29,842,867	1,843,500	0	0	0	0	0	31,686,367
CONST	78,231,415	22,851,826	0	13,800,580	2,724,948	0	0	117,608,769
QORTC	407,409	141,292	0	68,143	53,995	0	0	670,839
RESRV	201,857	36,033,298	10,160,000	849,048	215,125	0	49,207,306	96,666,633
TOTAL	127,125,603	66,787,149	10,240,000	14,717,771	2,994,068	0	49,207,306	271,072,096

METROPOLITAN SERVICE DISTRICT
 TRANSPORTATION IMPROVEMENT PROGRAM
 QUARTERLY REPORT FOR QUARTER ENDING 30-JUN-83
 FAU/E4 PROJECTS BY SPONSOR AND FUNDING SOURCE
 14-Dec-83

PHASES
 TIPSON.DAT

	OBLIGATED	1983	1984	1985	1986	1987	POST 1987	AUTHORIZED	
CITY OF PORTLAND PROJECTS									
35 N COLUMBIA BLVD-0.25 MI W OF TERMINAL RD TO W OSWEGO AVE***9*376*455***** FAU9956									75019
INTERSTATE TRANSFER FUNDS									
R/W	172,805	158,695	0	0	0	0	0	331,500	
CONST	2,742,935	0	0	0	0	0	0	2,742,935	
TOTAL	2,915,740	158,695	0	0	0	0	0	3,074,435	
36 BASIN AVENUE/GOING STREET PROJECT***18*304***** FAU9930									76088
INTERSTATE TRANSFER FUNDS									
R/W	271,150	0	0	0	0	0	0	271,150	
CONST	1,679,623	0	0	0	0	0	0	1,679,623	
RESRV	0	0	0	0	0	0	0	0	
TOTAL	1,950,773	0	0	0	0	0	0	1,950,774	
37 N INTERSTATE AVE-GREELEY TO RUSSELL***21*305***** FAU9945									76009
INTERSTATE TRANSFER FUNDS									
CONST	0	85,267	0	0	0	0	0	85,267	
RESRV	0	0	0	0	0	0	-23,267	-23,267	
TOTAL	0	85,267	0	0	0	0	-23,267	62,000	
38 NEW TRAFFIC SIGNALS-CITY OF PORTLAND***22*377***** MISC									
INTERSTATE TRANSFER FUNDS									
RESRV	0	0	0	0	0	0	123,620	123,620	
39 TRAFFIC SIGNAL REPLACEMENT-CITY OF PORTLAND RESERVE ACCOUNT***24*492*487*526***** MISC									
INTERSTATE TRANSFER FUNDS									
PE	0	0	120,000	0	0	0	0	120,000	
RESRV	0	0	0	1,200,000	1,200,000	1,080,000	-3,273,334	206,666	
TOTAL	0	0	120,000	1,200,000	1,200,000	1,080,000	-3,273,334	326,666	
40 TRAFFIC SIGNAL IMPROVEMENT-CITY OF PORTLAND***25*273*378*498***** MISC									
INTERSTATE TRANSFER FUNDS									
PE	0	0	0	100,000	100,000	100,000	100,000	400,000	
CONST	0	0	0	900,000	900,000	900,000	1,800,000	4,500,000	
RESRV	0	0	0	0	0	0	-4,415,794	-4,415,794	
TOTAL	0	0	0	1,000,000	1,000,000	1,000,000	-2,515,794	484,206	

METROPOLITAN SERVICE DISTRICT
 TRANSPORTATION IMPROVEMENT PROGRAM
 QUARTERLY REPORT FOR QUARTER ENDING 30-JUN-83
 FAU/E4 PROJECTS BY SPONSOR AND FUNDING SOURCE
 14-Dec-83

PHASES
 TIPSON.DAT

	OBLIGATED	1983	1984	1985	1986	1987	POST 1987	AUTHORIZED		
CITY OF PORTLAND PROJECTS (CONTINUED)										
41 SIGNAL COMPUTER CONTROL EXPANSION***26#379*****									MISC	77026
INTERSTATE TRANSFER FUNDS										
CONST	51,977	0	3,273	0	0	0	0	55,250		
42 MACADAM AVE(OR43) PROJECT-ROSS ISL BRIDGE TO SELLWOOD BRIDGE1*****27#306#307***** FAU9565										
INTERSTATE TRANSFER FUNDS										78063
PE	198,370	0	0	0	0	0	0	198,370		
R/W	179,179	0	0	0	0	0	0	179,179		
CONST	3,910,000	1	0	0	0	0	0	3,910,001		
RESRV	0	0	0	0	0	0	-55	-55		
TOTAL	4,287,549	1	0	0	0	0	-55	4,287,495		
43 HOLLYWOOD DISTRICT IMPROVEMENTS-NE SANDY BLVD-37TH TO 47TH4*****28#489***** FAU9326										
INTERSTATE TRANSFER FUNDS										79071
PE	198,889	0	0	0	0	0	0	198,889		
R/W	163,200	0	0	0	0	0	0	163,200		
CONST	0	0	2,432,400	0	0	0	0	2,432,400		
RESRV	0	0	0	0	0	0	-1,400	-1,400		
TOTAL	362,089	0	2,432,400	0	0	0	-1,400	2,793,089		
44 NW FRONT AVE-NW 26TH AVE TO NW KITTRIDGE***29#308***** FAU9300										
INTERSTATE TRANSFER FUNDS										10031
CONST	522,074	0	0	0	0	0	0	522,074		
45 SE HOLGATE BLVD-SE 17TH AVE TO SE 28TH AVE-BRIDGE AND APPROACHES***42#274***** FAU9793										
INTERSTATE TRANSFER FUNDS										76002
CONST	4,450,600	0	0	0	0	0	0	4,450,600		
46 ARTERIAL STREET 3R PROGRAM***43#456#457#458#459***** MISC										
INTERSTATE TRANSFER FUNDS										10050
PE	58,042	117,219	45,050	0	0	0	0	220,311		
CONST	2,844,939	2,149,585	1,081,200	1,126,250	0	0	0	7,201,974		
RESRV	0	0	0	0	0	0	-30,344	-30,344		
TOTAL	2,902,981	2,266,804	1,126,250	1,126,250	0	0	-30,344	7,391,941		

METROPOLITAN SERVICE DISTRICT
 TRANSPORTATION IMPROVEMENT PROGRAM
 QUARTERLY REPORT FOR QUARTER ENDING 30-JUN-83
 FAU/E4 PROJECTS BY SPONSOR AND FUNDING SOURCE
 14-Dec-83

PHASES
 TIPSON.DAT

OBLIGATED 1983 1984 1985 1986 1987 POST 1987 AUTHORIZED

CITY OF PORTLAND PROJECTS (CONTINUED)

47 MCLOUGHLIN NEIGHBORHOOD TRAFFIC CIRCULATION***153*246***** N/A									80081
INTERSTATE TRANSFER FUNDS									
PE	19,000	0	0	0	55,000	0	0	74,000	
CONST	0	0	0	0	0	346,525	0	346,525	
RESRV	0	0	0	0	0	0	12,628	12,628	
TOTAL	19,000	0	0	0	55,000	346,525	12,628	433,153	
48 MCLOUGHLIN BLVD(OR99E) PED UNDERPASS - 100 FT SO OF HAIG***169*281***** FAP26									77127
INTERSTATE TRANSFER FUNDS									
PE	36,820	0	0	0	0	0	0	36,820	
RESRV	0	0	0	0	0	0	217	217	
TOTAL	36,820	0	0	0	0	0	217	37,037	
49 GRAND AVE(OR99E) AT MORRISON - 2 LEFT TURN LANES***170*282***** FAU9809									80084
INTERSTATE TRANSFER FUNDS									
PE	22,358	0	0	0	0	0	0	22,358	
CONST	145,180	0	0	0	0	0	0	145,180	
TOTAL	167,538	0	0	0	0	0	0	167,538	
50 33RD AT BROADWAY - SB/NB LEFT TURN REFUGES***173*283*284***** FAU9823									77123
INTERSTATE TRANSFER FUNDS									
PE	25,245	0	0	0	0	0	0	25,245	
R/W	132,600	0	0	0	0	0	0	132,600	
CONST	121,603	0	0	0	0	0	0	121,603	
RESRV	0	0	0	0	0	0	0	0	
TOTAL	279,448	0	0	0	0	0	0	279,448	
51 39TH AVE - SE GLENWOOD TO CRYSTAL SPRINGS BLVD - WIDENING***175*285***** FAU9699									77125
INTERSTATE TRANSFER FUNDS									
PE	46,450	0	0	0	0	0	0	46,450	
R/W	41	0	0	0	0	0	0	41	
CONST	494,434	0	0	0	0	0	0	494,434	
TOTAL	540,925	0	0	0	0	0	0	540,925	

METROPOLITAN SERVICE DISTRICT
 TRANSPORTATION IMPROVEMENT PROGRAM
 QUARTERLY REPORT FOR QUARTER ENDING 30-JUN-83
 FAU/E4 PROJECTS BY SPONSOR AND FUNDING SOURCE
 14-Dec-83

PHASES
 TIPSON.DAT

	OBLIGATED	1983	1984	1985	1986	1987	POST 1987	AUTHORIZED	

CITY OF PORTLAND PROJECTS (CONTINUED)									
52 39TH @ STARK -WIDENING/SB LEFT TURN MEDIAN/SIGNAL INTERTIE/STRIP***178*286*287***** FAU9699									77124
INTERSTATE TRANSFER FUNDS									
PE 15,800	0	0	0	0	0	0	0	15,800	
R/W 37,788	0	4,032	0	0	0	0	0	41,820	
CONST 123,505	0	3,001	0	0	0	0	0	126,506	
RESRV 0	0	0	0	0	0	0	0	0	
TOTAL 177,093	0	7,033	0	0	0	0	0	184,126	
53 CURB EXTENSION PROGRAM***179*288***** MISC									77129
INTERSTATE TRANSFER FUNDS									
PE 13,889	0	0	0	0	0	0	0	13,889	
54 CURB CORNER MODIFICATION PROGRAM***180*289***** MISC									77119
INTERSTATE TRANSFER FUNDS									
PE 2,969	0	0	0	0	0	0	0	2,969	
CONST 7,259	0	0	0	0	0	0	0	7,259	
TOTAL 10,228	0	0	0	0	0	0	0	10,228	
55 ACTUATED SIGNALS-SE BYBEE @ 23RD/SE TOLMAN @ MILWAUKIE-@17TH***183*290***** FAU9760									77118
INTERSTATE TRANSFER FUNDS									
PE 1,153	0	0	0	0	0	0	0	1,153	
CONST 41,152	0	0	0	0	0	0	0	41,152	
TOTAL 42,305	0	0	0	0	0	0	0	42,305	
56 SIGNAL MODIFICATION AND REPLACEMENT PROGRAM - 8 LOCATIONS***185*291***** MISC									77117
INTERSTATE TRANSFER FUNDS									
PE 1,691	0	0	0	0	0	0	0	1,691	
CONST 13,313	0	0	0	0	0	0	0	13,313	
TOTAL 15,004	0	0	0	0	0	0	0	15,004	
57 MCLOUGHLIN(OR99E)/MILWAUKIE CONNECTION***187*292***** FAP26									77128
INTERSTATE TRANSFER FUNDS									
PE 2,742	0	0	0	0	0	0	0	2,742	

METROPOLITAN SERVICE DISTRICT
 TRANSPORTATION IMPROVEMENT PROGRAM
 QUARTERLY REPORT FOR QUARTER ENDING 30-JUN-83
 FAU/E4 PROJECTS BY SPONSOR AND FUNDING SOURCE
 14-Dec-83

PHASES
 TIPSON.DAT

	OBLIGATED	1983	1984	1985	1986	1987	POST 1987	AUTHORIZED	
CITY OF PORTLAND PROJECTS (CONTINUED)									
58 SE DIVISION CORRIDOR-DIVISION/CLINTON/HARRISON***189*293*****								FAU9800	78069
INTERSTATE TRANSFER FUNDS									
PE	51,550	0	0	0	0	0	0	51,550	
RESRV	0	0	0	0	0	0	9,918	9,918	
TOTAL	51,550	0	0	0	0	0	9,918	61,468	
59 39TH AVENUE CORRIDOR IMPROVEMENT-GLISAN TO HOLGATE***191*294*295*****								FAU9699	78070
INTERSTATE TRANSFER FUNDS									
PE	76,892	0	328	0	0	0	0	77,220	
R/W	425,000	0	0	0	0	0	0	425,000	
CONST	1,158,908	0	0	15,171	0	0	0	1,174,079	
RESRV	0	0	0	0	0	0	1,080	1,080	
TOTAL	1,660,800	0	328	15,171	0	0	1,080	1,677,379	
60 CONTINGENCY-CATEGORY II-CITY OF PORTLAND***194*296*****								N/A	
INTERSTATE TRANSFER FUNDS									
RESRV	0	0	0	0	0	0	2,726,850	2,726,850	
61 UNION AVENUE(OR99E)-WEIDLER TO COLUMBIA BLVD-#6***195*322*492*****								FAU9809	74001
INTERSTATE TRANSFER FUNDS									
PE	267,944	0	0	0	0	0	0	267,944	
R/W	205,700	0	0	0	0	0	0	205,700	
CONST	6,539,794	-176,727	0	0	0	0	0	6,363,067	
RESRV	0	0	0	0	0	0	3,432	3,432	
TOTAL	7,013,438	-176,728	0	0	0	0	3,432	6,840,142	
62 GOING STREET NOISE MITIGATION PROJECT***198*323*493*****								FAU9945	78080
INTERSTATE TRANSFER FUNDS									
PE	287,720	5,049	0	0	0	0	0	292,769	
CONST	594,399	0	24,400	0	0	0	0	618,799	
RESRV	0	0	0	0	0	0	-11,881	-11,881	
TOTAL	882,119	5,049	24,400	0	0	0	-11,881	899,687	

METROPOLITAN SERVICE DISTRICT
TRANSPORTATION IMPROVEMENT PROGRAM
QUARTERLY REPORT FOR QUARTER ENDING 30-JUN-83
FAU/E4 PROJECTS BY SPONSOR AND FUNDING SOURCE
14-Dec-83

PHASES
TIPSON.DAT

	OBLIGATED	1983	1984	1985	1986	1987	POST 1987	AUTHORIZED	
CITY OF PORTLAND PROJECTS (CONTINUED)									
63 SW BROADWAY-SW 4TH TO SW 6TH***200*324***** MISC 10092									
INTERSTATE TRANSFER FUNDS									
PE	50,000	0	0	0	0	0	0	50,000	
CONST	0	0	703,800	0	0	0	0	703,800	
RESRV	0	0	0	0	0	0	-91,800	-91,800	
TOTAL	50,000	0	703,800	0	0	0	-91,800	662,000	
64 CONTINGENCY-CITY OF PORTLAND-CATEGORY III***203*325***** N/A									
INTERSTATE TRANSFER FUNDS									
RESRV	0	0	0	0	0	0	12,228	12,228	
65 NW 18TH/19TH AND NW 14TH/16TH COUPLETS***239*367***** FAU9295 78067									
INTERSTATE TRANSFER FUNDS									
PE	55,920	0	0	0	0	0	0	55,920	
CONST	384,680	0	0	0	0	0	0	384,680	
RESRV	0	0	0	0	0	0	334,558	334,558	
TOTAL	440,600	0	0	0	0	0	334,558	775,158	
66 BEAVERTON HILLSDALE HWY(OR10)-CAPITOL HWY TO SCHOLLS FY RD***243*494*369***** FAU9228 78050									
INTERSTATE TRANSFER FUNDS									
PE	179,095	57,715	0	0	0	0	0	236,810	
R/W	522,410	-8,160	0	0	0	0	0	514,250	
CONST	0	0	2,082,500	0	0	0	0	2,082,500	
RESRV	0	0	0	0	0	0	-577,490	-577,490	
TOTAL	701,505	49,555	2,082,500	0	0	0	-577,490	2,256,070	
67 FAU REPLACEMENT CONTINGENCY-CITY OF PORTLAND***261*471*472*393***** N/A									
INTERSTATE TRANSFER FUNDS									
RESRV	0	0	0	0	0	0	1,077,915	1,077,915	
68 ST HELENS ROAD RECONSTRUCTION-WEST CITY LIMITS TO NW KITTRIDGE A***271*433***** FAP1 79067									
INTERSTATE TRANSFER FUNDS									
PE	221,468	0	0	0	0	0	0	221,468	
R/W	0	0	0	0	1,751,750	1,142,608	0	2,894,358	
RESRV	0	0	0	0	0	0	401,024	401,024	
TOTAL	221,468	0	0	0	1,751,750	1,142,608	401,024	3,516,850	

METROPOLITAN SERVICE DISTRICT
 TRANSPORTATION IMPROVEMENT PROGRAM
 QUARTERLY REPORT FOR QUARTER ENDING 30-JUN-83
 FAU/E4 PROJECTS BY SPONSOR AND FUNDING SOURCE
 14-Dec-83

PHASES
 TIPSON.DAT

	OBLIGATED	1983	1984	1985	1986	1987	POST 1987	AUTHORIZED		
CITY OF PORTLAND PROJECTS (CONTINUED)										
69 TRANSPORTATION IMPROVEMENTS IN NORTHWEST PORTLAND***278*434*****									MISC	79035
INTERSTATE TRANSFER FUNDS										
RESRV	0	0	0	0	0	0	2,073,847	2,073,847		
70 W BURNSIDE ROAD/TICNER DRIVE INTERSECTION IMPROVEMENT***282*435*****										
INTERSTATE TRANSFER FUNDS									FAU9326	79058
PE	26,972	1,000	0	0	0	0	0	27,972		
R/W	69,820	0	0	0	0	0	0	69,820		
CONST	444,640	43,109	0	0	0	0	0	487,749		
RESRV	0	0	0	0	0	0	-21,949	-21,949		
TOTAL	541,432	44,109	0	0	0	0	-21,949	563,592		
71 NORTHWEST PORTLAND TRANSPORTATION STUDY***285*436*****										
INTERSTATE TRANSFER FUNDS									N/A	79035
PE	32,130	0	0	0	0	0	0	32,130		
72 NW FRONT AVENUE RECONSTRUCTION-NW GLISAN TO NW 26TH AVE***286*437*****										
INTERSTATE TRANSFER FUNDS									FAU9300	80006
PE	248,200	0	850	0	0	0	0	249,050		
R/W	0	120,700	0	0	0	0	0	120,700		
CONST	4,273,144	-229,045	0	0	0	0	0	4,044,099		
TOTAL	4,521,344	-108,344	850	0	0	0	0	4,413,850		
73 MARINE DRIVE WIDENING TO FOUR LANES-15 TO RIVERGATE***298*497*****										
INTERSTATE TRANSFER FUNDS									FAU9962	79056
PE	0	0	275,000	119,400	0	0	0	394,400		
CONST	0	0	0	0	4,535,600	0	0	4,535,600		
RESRV	0	0	0	0	0	0	-762,511	-762,511		
TOTAL	0	0	275,000	119,400	4,535,600	0	-762,511	4,167,489		
74 NE PORTLAND HWY IMPROVEMENT TO FOUR LANES-NE 60TH AVE TO I205***301*336*****										
INTERSTATE TRANSFER FUNDS									FAU9917	80011
PE	89,080	0	48,365	0	0	0	0	137,445		
RESRV	0	0	0	0	0	0	1,864,896	1,864,896		
TOTAL	89,080	0	48,365	0	0	0	1,864,896	2,002,341		

METROPOLITAN SERVICE DISTRICT
 TRANSPORTATION IMPROVEMENT PROGRAM
 QUARTERLY REPORT FOR QUARTER ENDING 30-JUN-83
 FAU/E4 PROJECTS BY SPONSOR AND FUNDING SOURCE
 14-Dec-83

PHASES
 TIPSON.DAT

OBLIGATED	1983	1984	1985	1986	1987	POST 1987	AUTHORIZED
CITY OF PORTLAND PROJECTS (CONTINUED)							
75 COLUMBIA BLVD/COLUMBIA WAY/N PORTLAND RD INTERSECTION IMPRVMT***303*498***** FAU9956 79057							
INTERSTATE TRANSFER FUNDS							
PE 12,436	0	0	0	0	0	0	12,436
CONST 165,916	0	0	0	0	0	0	165,916
RESRV 0	0	0	0	0	0	42,814	42,814
TOTAL 178,352	0	0	0	0	0	42,814	221,166
76 COMMERCIAL ARTERIAL STREET LIGHT CONVERSION-CITY WIDE***307*499***** MISC 79041							
INTERSTATE TRANSFER FUNDS							
PE 28,681	0	0	0	0	0	0	28,681
CONST 1,088,000	0	0	0	0	0	0	1,088,000
TOTAL 1,116,681	0	0	0	0	0	0	1,116,681
77 POWELL BUTTE/MT SCOTT STUDY AREA-PROJECT DEVELOPMENT***308*500***** MISC 79081							
INTERSTATE TRANSFER FUNDS							
PE 29,750	0	0	0	0	0	0	29,750
78 SU TERWILLIGER BLVD-BARBUR BLVD TO TAYLORS FERRY RD***309*501*541***** FAU9361 80015							
INTERSTATE TRANSFER FUNDS							
PE 55,000	24,046	177,654	0	0	0	0	256,700
CONST 0	0	0	0	551,920	0	0	551,920
RESRV 0	0	0	0	0	0	7,162,804	7,162,804
TOTAL 55,000	24,046	177,654	0	551,920	0	7,162,804	7,971,424
79 82ND AVENUE-SISKIYOU TO BROADWAY***551*503***** FAU9713 79049							
INTERSTATE TRANSFER FUNDS							
PE 17,722	0	19,720	0	0	0	0	37,442
CONST 0	0	236,300	0	0	0	0	236,300
RESRV 0	0	0	0	0	0	-73,020	-73,020
TOTAL 17,722	0	256,020	0	0	0	-73,020	200,722

METROPOLITAN SERVICE DISTRICT
 TRANSPORTATION IMPROVEMENT PROGRAM
 QUARTERLY REPORT FOR QUARTER ENDING 30-JUN-83
 FAU/E4 PROJECTS BY SPONSOR AND FUNDING SOURCE
 14-Dec-83

PHASES
 TIPSON.DAT

PHASES TIPSON.DAT	OBLIGATED	1983	1984	1985	1986	1987	POST 1987	AUTHORIZED	
CITY OF PORTLAND PROJECTS (CONTINUED)									
80 SIGNAL MODIFICATION AT 10 LOCATIONS(LEFT TURN)-SE PORTLAND**558*394***** MISC									79075
INTERSTATE TRANSFER FUNDS									
PE	2,082	0	0	0	0	0	0	2,082	
CONST	48,960	0	0	0	0	0	0	48,960	
TOTAL	51,042	0	0	0	0	0	0	51,042	
81 EAST BURNSIDE-90TH TO 94TH**599*297***** FAU9822									10077
INTERSTATE TRANSFER FUNDS									
PE	35,700	-1	0	0	0	0	0	35,699	
CONST	0	218,901	0	0	0	0	0	218,901	
TOTAL	35,700	218,901	0	0	0	0	0	254,601	
82 NW 23RD AVE/BURNSIDE**626*438***** FAU9326									10093
INTERSTATE TRANSFER FUNDS									
PE	60,200	39,800	40,397	0	0	0	0	140,397	
R/W	0	0	0	435,200	0	0	0	435,200	
CONST	0	0	-39,800	0	1,125,000	0	0	1,085,200	
RESRV	0	0	0	0	0	0	-542,027	-542,027	
TOTAL	60,200	39,800	597	435,200	1,125,000	0	-542,027	1,118,770	
83 NW 21ST/22ND-THURMAN TO NICOLAI**630*439***** FAU9317									10126
INTERSTATE TRANSFER FUNDS									
PE	112,710	0	0	0	0	0	0	112,710	
R/W	0	0	0	20,000	0	0	0	20,000	
CONST	0	0	0	0	681,236	0	0	681,236	
RESRV	0	0	0	0	0	0	110,107	110,107	
TOTAL	112,710	0	0	20,000	681,236	0	110,107	924,053	
84 NW INTERSECTION IMPROVEMENTS-22 LOCATIONS**631*440***** MISC									10017
INTERSTATE TRANSFER FUNDS									
PE	33,000	0	0	0	0	0	0	33,000	
RESRV	0	0	0	0	0	0	324,592	324,592	
TOTAL	33,000	0	0	0	0	0	324,592	357,592	

METROPOLITAN SERVICE DISTRICT
 TRANSPORTATION IMPROVEMENT PROGRAM
 QUARTERLY REPORT FOR QUARTER ENDING 30-JUN-83
 FAU/E4 PROJECTS BY SPONSOR AND FUNDING SOURCE
 14-Dec-83

PHASE3
 TIPSON.DAT

	OBLIGATED	1983	1984	1985	1986	1987	POST 1987	AUTHORIZED	
CITY OF PORTLAND PROJECTS (CONTINUED)									
##85 NW EVERETT/GLISAN-NW 18TH TO WESTOVER ROAD*****633*441***** FAU9314									10097
INTERSTATE TRANSFER FUNDS									
CONST	0	0	0	61,336	0	0	0	61,336	
RESRV	0	0	0	0	0	0	17,947	17,947	
TOTAL	0	0	0	61,336	0	0	17,947	79,283	
##86 NW CIRCULATION IMPROVEMENTS-10 INTERSECTIONS*****641*442***** FAU9305									00060
INTERSTATE TRANSFER FUNDS									
PE	10,710	0	0	0	0	0	0	10,710	
CONST	0	0	0	63,017	0	0	0	63,017	
RESRV	0	0	0	0	0	0	6,102	6,102	
TOTAL	10,710	0	0	63,017	0	0	6,102	79,829	
##87 SIGNAL REPLACEMENT-34 LOCATIONS*****643*477***** MISC									10107
INTERSTATE TRANSFER FUNDS									
PE	54,825	0	0	0	0	0	0	54,825	
CONST	0	0	1,478,746	0	0	0	0	1,478,746	
RESRV	0	0	0	0	0	0	-156,171	-156,171	
TOTAL	54,825	0	1,478,746	0	0	0	-156,171	1,377,400	
##88 SIGNAL REPLACEMENT-16 LOCATIONS*****645*478***** MISC									80080
INTERSTATE TRANSFER FUNDS									
CONST	386,083	0	0	0	0	0	0	386,083	
##89 NEW SIGNALS-5 LOCATIONS-PORTLAND BLVD ET AL*****647*395***** MISC									78122
INTERSTATE TRANSFER FUNDS									
CONST	129,310	0	0	0	0	0	0	129,310	
##90 COLUMBIA BLVD (3) NEW TRAFFIC SIGNALS*****650*396***** FAU9956									78026
INTERSTATE TRANSFER FUNDS									
CONST	239,837	0	0	0	0	0	0	239,837	

METROPOLITAN SERVICE DISTRICT
 TRANSPORTATION IMPROVEMENT PROGRAM
 QUARTERLY REPORT FOR QUARTER ENDING 30-JUN-83
 FAU/E4 PROJECTS BY SPONSOR AND FUNDING SOURCE
 14-Dec-83

PHASES
 TIPSON.DAT

	OBLIGATED	1983	1984	1985	1986	1987	POST 1987	AUTHORIZED		
CITY OF PORTLAND PROJECTS (CONTINUED)										
91 NE SANDY BLVD AT 50TH AND 70TH-NEW SIGNALS***652*397*****									FAU9326	78120
INTERSTATE TRANSFER FUNDS										
CONST	44,724	0	0	0	0	0	0	44,724		
92 COLUMBIA BLVD AT 47TH-NEW TRAFFIC SIGNAL***653*398*****									FAU9956	80060
INTERSTATE TRANSFER FUNDS										
PE	2,550	0	0	0	0	0	0	2,550		
CONST	57,000	0	0	0	0	0	0	57,000		
RESRV	0	0	0	0	0	0	-8,713	-8,713		
TOTAL	59,550	0	0	0	0	0	-8,713	50,837		
93 SW CAPITOL AT HUBER-NEW TRAFFIC SIGNAL***655*399*****									FAU9407	10032
INTERSTATE TRANSFER FUNDS										
CONST	60,810	0	0	0	0	0	0	60,810		
94 COLISEUM AREA TRAFFIC SIGNALS-SIGNAL IMPROVEMENT***657*504*298*****									MISC	78119
INTERSTATE TRANSFER FUNDS										
CONST	390,000	1	0	0	0	0	0	390,001		
95 CITYWIDE SIGNAL SYSTEM ANALYSIS***660*299*337*505*479*****									MISC	80042
INTERSTATE TRANSFER FUNDS										
CONST	0	295,000	845,000	900,000	277,000	0	0	2,317,000		
RESRV	0	0	0	0	0	0	153,332	153,332		
TOTAL	0	295,000	845,000	900,000	277,000	0	153,332	2,470,332		
96 CBD TRAFFIC SIGNAL REPLACEMENTS-21 LOCATIONS***661*400*****									MISC	78028
INTERSTATE TRANSFER FUNDS										
CONST	771,500	0	0	0	0	0	0	771,500		
97 INTERSTATE AT TILLAMOOK-SIGNAL REPLACEMENT***663*401*****									FAU9361	80005
INTERSTATE TRANSFER FUNDS										
PE	2,040	0	0	0	0	0	0	2,040		
CONST	28,033	0	9,350	0	0	0	0	37,383		
RESRV	0	0	0	0	0	0	577	577		
TOTAL	30,073	0	9,350	0	0	0	577	40,000		

METROPOLITAN SERVICE DISTRICT
 TRANSPORTATION IMPROVEMENT PROGRAM
 QUARTERLY REPORT FOR QUARTER ENDING 30-JUN-83
 FAU/E4 PROJECTS BY SPONSOR AND FUNDING SOURCE
 14-Dec-83

PHASES
 TIPSON.DAT

	OBLIGATED	1983	1984	1985	1986	1987	POST 1987	AUTHORIZED		
CITY OF PORTLAND PROJECTS (CONTINUED)										
98 82ND AVE (6) SIGNAL REPLACEMENTS-SANDY TO WASHINGTON**668*480*****									FAU9713	80061
INTERSTATE TRANSFER FUNDS										
PE	6,623	0	0	0	0	0	0	6,623		
CONST	209,790	1	0	0	0	0	0	209,791		
TOTAL	216,413	1	0	0	0	0	0	216,414		
99 COLUMBIA BLVD-DELAWARE TO CHAUTAUQUA**712*507*****41*****									FAU9956	75019
INTERSTATE TRANSFER FUNDS										
PE	118,150	0	0	0	0	0	0	118,150		
CONST	0	0	0	1,193,400	0	0	0	1,193,400		
RESRV	0	0	0	0	0	0	434,450	434,450		
TOTAL	118,150	0	0	1,193,400	0	0	434,450	1,746,000		
100 SE FOSIER RD IMPROVEMENTS-122ND TO JENNE RD**714*508*339*****4*****									FAU9776	10144
INTERSTATE TRANSFER FUNDS										
PE	0	195,000	0	75,000	0	0	0	270,000		
R/W	0	0	0	680,000	0	0	0	680,000		
CONST	0	0	0	0	2,380,000	0	0	2,380,000		
RESRV	0	0	0	0	0	0	-2,337,474	-2,337,474		
TOTAL	0	195,000	0	755,000	2,380,000	0	-2,337,474	992,526		
101 NORTHWEST RIDESHARE**723*443*****4*****									N/A	10090
INTERSTATE TRANSFER FUNDS										
OPRTC	85,000	0	0	0	0	0	0	85,000		
102 BANFIELD FIRE LINE**724*509*****4*****									FAP68	
INTERSTATE TRANSFER FUNDS										
PE	0	0	17,000	0	0	0	0	17,000		
CONST	0	0	0	0	0	0	0	0		
TOTAL	0	0	17,000	0	0	0	0	17,000		

METROPOLITAN SERVICE DISTRICT
 TRANSPORTATION IMPROVEMENT PROGRAM
 QUARTERLY REPORT FOR QUARTER ENDING 30-JUN-83
 FAU/E4 PROJECTS BY SPONSOR AND FUNDING SOURCE
 14-Dec-83

PHASES
 TIPSON.DAT

	OBLIGATED	1983	1984	1985	1986	1987	POST 1987	AUTHORIZED	
CITY OF PORTLAND PROJECTS (CONTINUED)									

*103 SW VERMONT STREET-30TH AVENUE TO OLESON ROAD*****726*340*30)*258*356***** FAU9398 10133									
INTERSTATE TRANSFER FUNDS									
PE	158,950	0	74,980	0	0	0	0	233,930	
R/W	0	0	0	8,500	0	0	0	8,500	
CONST	0	0	0	892,500	143,385	0	0	1,035,885	
RESRV	0	0	0	0	0	0	-2,000	-2,000	
TOTAL	158,950	0	74,980	901,000	143,385	0	-2,000	1,276,315	

*104 MARQUAM RAMP STREET IMPROVEMENTS-SE WATER/YAMHILL/TAYLOR/CLAY*****727*301***** FAU9366 10132									
INTERSTATE TRANSFER FUNDS									
PE	37,400	0	0	0	0	0	0	37,400	
R/W	0	0	0	170,000	0	0	0	170,000	
CONST	0	0	0	0	476,000	0	0	476,000	
RESRV	0	0	0	0	0	0	100,786	100,786	
TOTAL	37,400	0	0	170,000	476,000	0	100,786	784,186	

*105 82ND AVENUE-DIVISION TO CRYSTAL SPRINGS-UNITS 1 & 2*****730*510***** FAU9713 79049									
INTERSTATE TRANSFER FUNDS									
PE	72,845	0	53,125	0	0	0	0	125,970	
R/W	0	0	0	446,250	957,950	0	0	1,404,200	
CONST	0	0	0	0	586,500	586,500	0	1,173,000	
RESRV	0	0	0	0	0	0	721,005	721,005	
TOTAL	72,845	0	53,125	446,250	1,544,450	586,500	721,005	3,424,175	

*106 CITY OF PORTLAND REGIONAL TRANSIT/HIGHWAY IMPROVEMENT PROJECTS*****749*511*409*410***** 0									
INTERSTATE TRANSFER FUNDS									
RESRV	0	0	0	0	0	0	1,516,841	1,516,841	

*107 SW DOSCH RD-BEAVERTON HILLSDALE HIGHWAY TO PATTON RD*****749*512***** FAU9407 10145									
INTERSTATE TRANSFER FUNDS									
PE	0	0	0	0	0	255,000	0	255,000	
R/W	0	0	0	0	0	0	85,000	85,000	
CONST	0	0	0	0	0	0	1,615,000	1,615,000	
RESRV	0	0	0	0	0	0	-1,955,000	-1,955,000	
TOTAL	0	0	0	0	0	255,000	-255,000	0	

METROPOLITAN SERVICE DISTRICT
 TRANSPORTATION IMPROVEMENT PROGRAM
 QUARTERLY REPORT FOR QUARTER ENDING 30-JUN-83
 FAU/E4 PROJECTS BY SPONSOR AND FUNDING SOURCE
 14-Dec-83

PHASES
 TIPSON.DAT

	OBLIGATED	1983	1984	1985	1986	1987	POST 1987	AUTHORIZED	
CITY OF PORTLAND PROJECTS (CONTINUED)									
*108 NW FRONT AVE-GLISAN TO COUCH(EVERETT-FRONT CONNECTOR)*****751*444***** FAU9300 10140									
INTERSTATE TRANSFER FUNDS									
PE	159,120	0	0	0	0	0	0	159,120	
CONST	0	0	1,518,240	0	0	0	0	1,518,240	
RESRV	0	0	0	0	0	0	-244,359	-244,359	
TOTAL	159,120	0	1,518,240	0	0	0	-244,359	1,433,001	
*109 CITY ROLLBACK RESERVE*****759*303***** N/A									
*110 N VANCOUVER WAY-UNION AVENUE TO MARINE DRIVE*****762*506*342***** FAU9960 10149									
INTERSTATE TRANSFER FUNDS									
PE	270,300	-300	0	0	0	0	0	270,000	
CONST	0	0	2,798,880	0	0	0	0	2,798,880	
RESRV	0	0	0	0	0	0	-163,880	-163,880	
TOTAL	270,300	-300	2,798,880	0	0	0	-163,880	2,905,000	
*111 UNALLOCATED RESERVE-CITY OF PORTLAND*****788*412***** N/A									
INTERSTATE TRANSFER FUNDS									
RESRV	0	0	0	0	0	0	162,575	162,575	
*112 PEDESTRIAN/SCHOOL SIGNAL-NE 47TH AVENUE AND OREGON*****801*514***** N/A 10207									
INTERSTATE TRANSFER FUNDS									
PE	0	3,500	0	0	0	0	0	3,500	
CONST	0	42,000	0	0	0	0	0	42,000	
TOTAL	0	45,500	0	0	0	0	0	45,500	
*113 OBLIGATIONAL AUTHORITY RESERVE-CITY OF PORTLAND*****833*417***** N/A									
INTERSTATE TRANSFER FUNDS									
RESRV	0	9,373,243	-5,835,272	0	0	0	-3,537,971	0	
*114 N RIVERGATE DRIVE-LOMBARD TO PORTLAND ROAD*****845*516***** FAU9958									
INTERSTATE TRANSFER FUNDS									
PE	0	0	0	170,000	0	0	-170,000	0	
RESRV	0	0	0	0	0	0	170,000	170,000	
TOTAL	0	0	0	170,000	0	0	0	170,000	

METROPOLITAN SERVICE DISTRICT
 TRANSPORTATION IMPROVEMENT PROGRAM
 QUARTERLY REPORT FOR QUARTER ENDING 30-JUN-83
 FAU/E4 PROJECTS BY SPONSOR AND FUNDING SOURCE
 14-Dec-83

PHASES
 TIPSON.DAT

	OBLIGATED	1983	1984	1985	1986	1987	POST 1987	AUTHORIZED	
CITY OF PORTLAND PROJECTS (CONTINUED)									
*115 N RIVERGATE SLOUGH BRIDGE-LOMBARD TO RIVERGATE DRIVE*****846*517***** FAU9958									
INTERSTATE TRANSFER FUNDS									
PE	0	0	0	85,000	0	0	-85,000	0	
RESRV	0	0	0	0	0	0	85,000	85,000	
TOTAL	0	0	0	85,000	0	0	0	85,000	
*116 SANDY/12TH/BURNSIDE INTERSECTION*****848*314*518***** FAU9326 10198									
INTERSTATE TRANSFER FUNDS									
PE	0	0	0	85,000	0	0	0	85,000	
*117 SE DIVISION/CLINTON-SE 8TH TO SE 13TH AVE*****850*527***** FAU9800 78069									
INTERSTATE TRANSFER FUNDS									
PE	0	0	0	50,000	35,000	0	0	85,000	
CONST	0	0	0	0	425,000	0	0	425,000	
TOTAL	0	0	0	50,000	460,000	0	0	510,000	
*118 N RIVERGATE DRIVE-SLOUGH BRIDGE STREET APPROACHES*****856*536***** TBD									
INTERSTATE TRANSFER FUNDS									
PE	0	0	20,000	0	0	0	0	20,000	
CONST	0	0	915,000	0	0	0	0	915,000	
RESRV	0	0	0	0	0	0	-935,000	-935,000	
TOTAL	0	0	935,000	0	0	0	-935,000	0	
*119 NE GERTZ/13TH-VANCOUVER WAY TO MERRITT/FAZIO*****857*537***** TBD									
INTERSTATE TRANSFER FUNDS									
PE	0	0	78,540	0	0	0	0	78,540	
CONST	0	0	0	0	688,560	0	0	688,560	
RESRV	0	0	0	0	0	0	-767,100	-767,100	
TOTAL	0	0	78,540	0	688,560	0	-767,100	0	
*120 AIRPORT WAY-I205 TO 148TH AVE-UNIT I*****858*538***** TBD									
INTERSTATE TRANSFER FUNDS									
PE	0	0	100,000	300,000	212,000	0	0	612,000	
CONST	0	0	0	0	0	1,889,900	0	1,889,900	
RESRV	0	0	0	0	0	0	-2,501,900	-2,501,900	
TOTAL	0	0	100,000	300,000	212,000	1,889,900	-2,501,900	0	

METROPOLITAN SERVICE DISTRICT
 TRANSPORTATION IMPROVEMENT PROGRAM
 QUARTERLY REPORT FOR QUARTER ENDING 30-JUN-83
 FAU/E4 PROJECTS BY SPONSOR AND FUNDING SOURCE
 14-Dec-83

PHASES
 TIPSON.DAT

OBLIGATED 1983 1984 1985 1986 1987 POST 1987 AUTHORIZED

CITY OF PORTLAND PROJECTS (CONTINUED)

*121 AIRPORT WAY-NE 148TH TO NE 168TH-UNIT I*****859*539*****1*****
 INTERSTATE TRANSFER FUNDS

CONST	0	0	0	0	0	0	1,364,300	1,364,300
RESRV	0	0	0	0	0	0	-1,364,300	-1,364,300
TOTAL	0	0	0	0	0	0	0	0

*122 AIRPORT WAY-NE 168TH TO 181ST/SANDY-UNIT III*****861*540*****1*****
 INTERSTATE TRANSFER FUNDS

CONST	0	0	0	0	0	0	3,783,800	3,783,800
RESRV	0	0	0	0	0	0	-3,783,800	-3,783,800
TOTAL	0	0	0	0	0	0	0	0

AGENCY TOTAL: CITY OF PORTLAND

FEDERAL AID URBAN SYSTEM FUNDS								
TOTAL	0	0	0	0	0	0	0	0

INTERSTATE TRANSFER FUNDS

PE	3,511,183	443,029	1,071,009	984,400	402,000	355,000	-155,000	6,611,620
R/W	2,179,693	271,235	4,032	1,759,950	2,709,700	1,142,608	85,000	8,152,218
CONST	34,164,122	2,428,093	14,092,289	5,151,675	12,770,200	3,722,925	8,563,100	80,892,405
OPRTC	85,000	0	0	0	0	0	0	85,000
RESRV	0	9,373,243	-5,835,272	1,200,000	1,200,000	1,080,000	-7,931,396	-913,424
TOTAL	39,939,998	12,515,600	9,332,058	9,096,025	17,081,900	6,300,533	561,704	94,827,819

1505 TRANSFER FUNDS

TOTAL	0	0	0	0	0	0	0	0
-------	---	---	---	---	---	---	---	---

AGENCY TOTAL: CITY OF PORTLAND

PE	3,511,183	443,029	1,071,009	984,400	402,000	355,000	-155,000	6,611,620
R/W	2,179,693	271,235	4,032	1,759,950	2,709,700	1,142,608	85,000	8,152,218
CONST	34,164,122	2,428,093	14,092,289	5,151,675	12,770,200	3,722,925	8,563,100	80,892,405
OPRTC	85,000	0	0	0	0	0	0	85,000
RESRV	0	9,373,243	-5,835,272	1,200,000	1,200,000	1,080,000	-7,931,396	-913,424
TOTAL	39,939,998	12,515,600	9,332,058	9,096,025	17,081,900	6,300,533	561,704	94,827,819

METROPOLITAN SERVICE DISTRICT
 TRANSPORTATION IMPROVEMENT PROGRAM
 QUARTERLY REPORT FOR QUARTER ENDING 30-JUN-83
 FAU/E4 PROJECTS BY SPONSOR AND FUNDING SOURCE
 14-Dec-83

PHASES
 TIPSON.DAT

	OBLIGATED	1983	1984	1985	1986	1987	POST 1987	AUTHORIZED	
MULTNOMAH COUNTY PROJECTS									
*123 SELLWOOD BRIDGE PROJECT*****52*345*380*309*460***** FAU9704									76031
INTERSTATE TRANSFER FUNDS									
CONST	899,538	0	0	0	0	0	0	899,538	
RESRV	0	0	0	0	0	-43,266	17,416	-25,850	
TOTAL	899,538	0	0	0	0	-43,266	17,416	873,688	
*124 238TH AVE IMPROVEMENT-UP RXXNG TO HALSEY ST*****58*461*346***** FAU9877									78009
INTERSTATE TRANSFER FUNDS									
PE	36,216	0	0	0	0	0	0	36,216	
R/W	16,267	0	0	0	0	0	0	16,267	
CONST	275,200	0	0	0	0	0	0	275,200	
RESRV	0	0	0	0	0	0	97,777	97,777	
TOTAL	327,683	1	0	0	0	0	97,777	425,461	
*125 EAST COUNTY SIGNAL PROJECTS-STARK/22ND/HALSEY/A02ND*****137*347*242***** MISC									80037
INTERSTATE TRANSFER FUNDS									
PE	14,591	19,409	0	0	0	0	0	34,000	
CONST	466,842	0	0	0	0	0	0	466,842	
RESRV	0	0	0	0	0	0	1,528	1,528	
TOTAL	481,433	19,409	0	0	0	0	1,528	502,370	
*126 242ND AVE TSM IMPROVEMENTS-DIVISION TO GLISA*****138*243***** FAU9877									80047
INTERSTATE TRANSFER FUNDS									
PE	31,535	0	0	0	0	0	0	31,535	
CONST	453,335	0	0	0	0	0	0	453,335	
RESRV	0	0	0	0	0	0	171,193	171,193	
TOTAL	484,870	0	0	0	0	0	171,193	656,063	
*127 257TH AVE IMPROVEMENT & EXTENSION-COLUMBIA HWY TO STARK ST*****139*244***** FAU9883									80048
INTERSTATE TRANSFER FUNDS									
PE	74,000	74,750	0	0	0	0	0	148,750	
R/W	0	0	1,224,000	0	0	0	0	1,224,000	
CONST	0	0	0	1,421,680	0	0	0	1,421,680	
TOTAL	74,000	74,750	1,224,000	1,421,680	0	0	0	2,794,430	

METROPOLITAN SERVICE DISTRICT
 TRANSPORTATION IMPROVEMENT PROGRAM
 QUARTERLY REPORT FOR QUARTER ENDING 30-JUN-83
 FAU/E4 PROJECTS BY SPONSOR AND FUNDING SOURCE
 14-Dec-83

PHASES
 TIPSON.DAT

OBLIGATED	1983	1984	1985	1986	1987	POST 1987	AUTHORIZED	
MULTNOMAH COUNTY PROJECTS (CONTINUED)								
*129 SE 72ND RECONSTRUCTION-DUKE TO CLACKAMAS COUNTY LINE*****165*279***** FAU9723 80083								
INTERSTATE TRANSFER FUNDS								
PE	17,800	0	0	0	0	0	17,800	
CONST	567,115	0	0	0	0	0	567,115	
RESRV	0	0	0	0	0	27,688	27,688	
TOTAL	584,915	0	0	0	0	27,688	612,603	
*129 BURNSIDE BRIDGE RESURFACING AND JOINTS*****166*280***** FAU9326 77017								
INTERSTATE TRANSFER FUNDS								
PE	5,974	0	0	0	0	0	5,974	
CONST	284,518	0	0	0	0	0	284,518	
RESRV	0	0	0	0	0	24,621	24,621	
TOTAL	290,492	0	0	0	0	24,621	315,113	
*130 BROADWAY BRIDGE RESURFACING-W3*****204*326***** FAU9318 77048								
INTERSTATE TRANSFER FUNDS								
PE	5,540	0	0	0	0	0	5,540	
CONST	87,276	0	0	0	0	0	87,276	
RESRV	0	0	0	0	0	-4,445	-4,445	
TOTAL	92,816	0	0	0	0	-4,445	88,371	
*131 221ST/223RD-POWELL BLVD TO FARISS RD-UNITS 1 & 2*****205*349*328*327***** FAU9867 205								
INTERSTATE TRANSFER FUNDS								
PE	234,891	0	0	0	0	0	234,891	
R/W	1,003,000	0	0	0	0	0	1,003,000	
CONST	1,907,171	-1	0	0	0	0	1,907,170	
RESRV	0	0	0	0	0	935,513	935,513	
TOTAL	3,145,062	0	0	0	0	935,513	4,080,575	
*132 CONTINGENCY-MULTNOMAH COUNTY/CITIES-CATEGORY III*****206*329***** N/A								
INTERSTATE TRANSFER FUNDS								
RESRV	0	0	0	0	0	217,346	217,346	

METROPOLITAN SERVICE DISTRICT
 TRANSPORTATION IMPROVEMENT PROGRAM
 QUARTERLY REPORT FOR QUARTER ENDING 30-JUN-83
 FAU/E4 PROJECTS BY SPONSOR AND FUNDING SOURCE
 14-Dec-83

PHASES
 TIPSON.DAT

PAGE 26

OBLIGATED	1983	1984	1985	1986	1987	POST 1987	AUTHORIZED
MULTNOMAH COUNTY PROJECTS (CONTINUED)							
*133 FAIRVIEW AVE SIGNALIZATION- AT HALSEY ST AND AT SANDY BLVD*****212*349***** FAU9867 78008							
INTERSTATE TRANSFER FUNDS							
PE 3,272	0	0	0	0	0	0	3,272
CONST 40,346	0	0	0	0	0	0	40,346
RESRV 0	0	0	0	0	0	2,732	2,732
TOTAL 43,618	0	0	0	0	0	2,732	46,350
*134 182ND AVENUE WIDENING-DIVISION ST TO POWELL BLVD*****213*350*333***** FAU9891 78010							
INTERSTATE TRANSFER FUNDS							
PE 114,900	0	0	0	0	0	0	114,900
R/W 72,250	0	0	0	0	0	0	72,250
CONST 1,009,875	0	0	0	0	0	0	1,009,875
RESRV 0	0	0	0	0	0	43,963	43,963
TOTAL 1,197,025	0	0	0	0	0	43,963	1,240,988
*135 221ST AVE EXTENSION/TOWLE RD IMPVMT-POWELL BLVD TO BUTLER RD*****214*351***** FAU9867 78012							
INTERSTATE TRANSFER FUNDS							
PE 283,000	0	0	0	0	0	0	283,000
R/W 332,435	95,665	0	0	0	0	0	428,100
CONST 0	0	1,004,000	0	0	0	0	1,004,000
RESRV 0	0	0	0	0	0	-49,127	-49,127
TOTAL 615,435	95,665	1,004,000	0	0	0	-49,127	1,665,973
*136 CHERRY PARK RD/257TH DRIVE-242ND AVE TO TROUTDALE RD*****216*352***** FAU9880 78011							
INTERSTATE TRANSFER FUNDS							
PE 47,886	0	0	0	0	0	0	47,886
CONST 581,400	0	0	0	0	0	0	581,400
RESRV 0	0	0	0	0	0	321,749	321,749
TOTAL 629,286	0	0	0	0	0	321,749	951,035
*137 CONTINGENCY-CATEGORY IV*****222*353***** N/A							
INTERSTATE TRANSFER FUNDS							
RESRV 0	0	0	0	0	0	459,402	459,402

METROPOLITAN SERVICE DISTRICT
 TRANSPORTATION IMPROVEMENT PROGRAM
 QUARTERLY REPORT FOR QUARTER ENDING 30-JUN-83
 FAU/E4 PROJECTS BY SPONSOR AND FUNDING SOURCE
 14-Dec-83

PHASES
 TIPSON.DAT

	OBLIGATED	1983	1984	1985	1986	1987	POST 1987	AUTHORIZED		
MULTNOMAH COUNTY PROJECTS (CONTINUED)										
*138 SANDY BLVD CORRIDOR-99TH AVE TO 162ND AVE*****244*369*****									FAU9326	78049
INTERSTATE TRANSFER FUNDS										
PE	66,980	0	0	0	0	0	0	66,980		
R/W	13,090	0	0	0	0	0	0	13,090		
CONST	0	502,000	0	0	0	0	0	502,000		
RESRV	0	0	0	0	0	0	29,942	29,942		
TOTAL	80,070	502,000	0	0	0	0	29,942	612,012		
*139 E BURNSIDE-SE 223RD TO SE POWELL BLVD-CONSTRUCTION*****252*392*****									FAU9822	76034
INTERSTATE TRANSFER FUNDS										
CONST	1,634,200	0	0	0	0	0	0	1,634,200		
RESRV	0	0	0	0	0	0	-162,986	-162,986		
TOTAL	1,634,200	0	0	0	0	0	-162,986	1,471,214		
*140 POWELL AND 190TH INTERSECTION IMPROVEMENT*****293*453*****									FAP24	77064
INTERSTATE TRANSFER FUNDS										
PE	153,340	0	0	0	0	0	0	153,340		
R/W	0	1,000,001	0	0	0	0	0	1,000,001		
CONST	0	0	0	1,600,108	0	0	0	1,600,108		
RESRV	0	0	0	0	0	0	-289,475	-289,475		
TOTAL	153,340	1,000,000	0	1,600,108	0	0	-289,475	2,463,973		
*141 BURNSIDE ST-STARK TO 223RD AVE*****294*354*473*****									FAU9822	76034
INTERSTATE TRANSFER FUNDS										
R/W	198,475	0	0	0	0	0	0	198,475		
CONST	0	2,422,775	0	0	0	0	0	2,422,775		
RESRV	0	0	0	0	0	0	-191,323	-191,323		
TOTAL	198,475	2,422,775	0	0	0	0	-191,323	2,429,927		
*142 221ST AVENUE-POWELL THROUGH JOHNSON CREEK BRIDGE*****715*355*****									FAU9867	78012
INTERSTATE TRANSFER FUNDS										
CONST	0	1,225,680	168,020	0	0	0	0	1,393,700		
RESRV	0	0	0	0	0	0	106,733	106,733		
TOTAL	0	1,225,680	168,020	0	0	0	106,733	1,500,433		

METROPOLITAN SERVICE DISTRICT
 TRANSPORTATION IMPROVEMENT PROGRAM
 QUARTERLY REPORT FOR QUARTER ENDING 30-JUN-83
 FAU/E4 PROJECTS BY SPONSOR AND FUNDING SOURCE
 14-Dec-83

PHASE5
 TIPSON.DAT

OBLIGATED	1983	1984	1985	1986	1987	POST 1987	AUTHORIZED
MULTNOMAH COUNTY PROJECTS (CONTINUED)							
*143 SYLVAN/SKYLINE IMPROVEMENTS-VICINITY OF SUNSET HIGHWAY*****831*343*404*269*515*375*485***** TBD							
INTERSTATE TRANSFER FUNDS							
PE	0	100,000	0	0	0	0	100,000
R/W	0	0	0	1,243,000	0	0	1,243,000
CONST	0	0	23,800	318,000	115,200	0	457,000
TOTAL	0	100,000	23,800	1,561,000	115,200	0	1,800,000
*144 OBLIGATIONAL AUTHORITY RESERVE-MULTNOMAH COUNTY*****834*418***** N/A							
INTERSTATE TRANSFER FUNDS							
RESRV	0	600,000	0	0	0	-600,000	0
*145 SE STARK STREET-242ND AVENUE TO 257TH AVENUE*****837*357*270*344***** FAU9810 10206							
INTERSTATE TRANSFER FUNDS							
PE	0	42,500	0	0	0	0	42,500
R/W	0	0	850	0	0	0	850
CONST	0	0	764,150	0	0	0	764,150
TOTAL	0	42,500	765,000	0	0	0	807,500
AGENCY TOTAL: MULTNOMAH COUNTY							
FEDERAL AID URBAN SYSTEM FUNDS							
TOTAL	0	0	0	0	0	0	0
INTERSTATE TRANSFER FUNDS							
PE	1,089,925	136,659	100,000	0	0	0	1,326,584
R/W	1,635,517	1,095,666	1,224,850	0	1,243,000	0	5,199,033
CONST	8,206,816	4,150,454	1,936,170	3,045,588	318,000	115,200	17,772,228
RESRV	0	0	600,000	0	0	-43,266	1,716,981
TOTAL	10,932,258	5,382,780	3,861,020	3,045,588	1,561,000	71,934	26,014,827
I505 TRANSFER FUNDS							
TOTAL	0	0	0	0	0	0	0

METROPOLITAN SERVICE DISTRICT
 TRANSPORTATION IMPROVEMENT PROGRAM
 QUARTERLY REPORT FOR QUARTER ENDING 30-JUN-83
 FAU/E4 PROJECTS BY SPONSOR AND FUNDING SOURCE
 14-Dec-83

PHASES TIPSON.DAT	OBLIGATED	1983	1984	1985	1986	1987	POST 1987	AUTHORIZED
----------------------	-----------	------	------	------	------	------	-----------	------------

MULTNOMAH COUNTY PROJECTS (CONTINUED)

AGENCY TOTAL: MULTNOMAH COUNTY								
PE	1,089,925	136,659	100,000	0	0	0	0	1,326,584
R/W	1,635,517	1,095,666	1,224,850	0	1,243,000	0	0	5,199,033
CONST	8,206,816	4,150,454	1,936,170	3,045,588	318,000	115,200	0	17,772,228
RESRV	0	0	600,000	0	0	-43,266	1,160,247	1,716,981
TOTAL	10,932,258	5,382,790	3,861,020	3,045,588	1,561,000	71,934	1,160,247	26,014,827

METROPOLITAN SERVICE DISTRICT
 TRANSPORTATION IMPROVEMENT PROGRAM
 QUARTERLY REPORT FOR QUARTER ENDING 30-JUN-83
 FAU/E4 PROJECTS BY SPONSOR AND FUNDING SOURCE
 14-Dec-83

PHASES
 TIPSON.DAT

OBLIGATED	1983	1984	1985	1986	1987	POST 1987	AUTHORIZED	
CLACKAMAS COUNTY PROJECTS								
*146 LOWER BOONES FERRY RD-MACRONA TO SW JEAN*****68*215*358*310***** FAU9473 80104								
INTERSTATE TRANSFER FUNDS								
R/W	525,583	0	0	0	0	0	525,583	
CONST	0	631,052	0	0	0	0	631,052	
TOTAL	525,583	631,052	0	0	0	0	1,156,635	
*147 82ND DRIVE-HIGHWAY 212 TO I205- CONSTRUCTION*****71*381***** FAU9653 76048								
INTERSTATE TRANSFER FUNDS								
CONST	393,474	0	0	0	0	0	393,474	
*148 SUNNYSIDE ROAD-STEVENS ROAD TO 122ND UNIT I*****77*462***** FAU9718 77147								
INTERSTATE TRANSFER FUNDS								
PE	21,845	0	0	0	0	0	21,845	
R/W	148,750	0	0	0	0	0	148,750	
CONST	314,530	0	0	0	0	0	314,530	
TOTAL	485,125	0	0	0	0	0	485,125	
*149 SUNNYSIDE ROAD REALIGNMENT-0.25 MI WEST OF 142ND (S CURVE)*****78*382***** FAU9718 77149								
INTERSTATE TRANSFER FUNDS								
CONST	172,517	0	0	0	0	0	172,517	
*150 OSWEGO CREEK BRIDGE(OR43)-BRIDGE REPLACEMENT AND NEW BIKEWAY*****103*467*386*449*313*222*533***** FAU9565 76085								
INTERSTATE TRANSFER FUNDS								
PE	98,856	-1	0	0	0	0	98,855	
R/W	37,635	0	0	0	0	0	37,635	
CONST	1,827,498	0	0	0	0	0	1,827,498	
RESRV	0	126,140	0	0	0	-1	126,139	
TOTAL	1,963,989	126,140	0	0	0	-1	2,090,128	
*151 OSWEGO HIGHWAY(OR43) AT CEDAR OAKS-LEFT TURN REFUGES*****113*450*468***** FAU9565 78118								
INTERSTATE TRANSFER FUNDS								
CONST	34,438	0	0	0	0	0	34,438	
RESRV	0	0	0	0	0	0	0	
TOTAL	34,438	0	0	0	0	0	34,438	

METROPOLITAN SERVICE DISTRICT
 TRANSPORTATION IMPROVEMENT PROGRAM
 QUARTERLY REPORT FOR QUARTER ENDING 30-JUN-83
 FAU/E4 PROJECTS BY SPONSOR AND FUNDING SOURCE
 14-Dec-83

PHASES
 TIPSON.DAT

	OBLIGATED	1983	1984	1985	1986	1987	POST 1987	AUTHORIZED	
CLACKAMAS COUNTY PROJECTS (CONTINUED)									
*152 HIGHWAY 212 IMPROVEMENTS (I205 EAST TO HIGHWAY 224)*****1244469*232*452*319*233*****<***** FAP74									77037
INTERSTATE TRANSFER FUNDS									
PE	321,300	0	0	0	0	0	0	321,300	
R/W	2,686,000	0	0	0	0	0	0	2,686,000	
CONST	2,013,073	3,191,112	0	0	0	0	0	5,204,185	
RESRV	0	113,688	0	0	0	0	99,827	213,515	
TOTAL	5,020,373	3,304,800	0	0	0	0	99,827	8,425,000	
*153 OREGON CITY BYPASS-PARK PLACE TO COMMUNITY COLLEGE*****125*234*320*321*534*****<***** N/A									76007
INTERSTATE TRANSFER FUNDS									
PE	946,508	0	0	0	0	0	0	946,508	
R/W	4,632,500	0	0	0	0	0	0	4,632,500	
CONST	5,266,485	0	8,999,742	0	0	0	0	14,266,227	
RESRV	0	2,488,350	0	0	0	0	780,406	3,268,756	
TOTAL	10,845,493	2,488,350	8,999,742	0	0	0	780,406	23,113,991	
*154 STATE STREET CORRIDOR (OR43)-B AVENUE TO NORTH SHORE*****133*361*240*****<***** FAU9565									77068
INTERSTATE TRANSFER FUNDS									
PE	94,605	0	0	0	0	0	0	94,605	
R/W	0	411,000	0	0	0	0	0	411,000	
CONST	0	0	85,000	1,142,000	0	0	0	1,227,000	
RESRV	0	0	0	0	0	0	-117,773	-117,773	
TOTAL	94,605	411,001	85,000	1,142,000	0	0	-117,773	1,614,833	
*155 GLADSTONE/MILWAUKIE SUBAREA TSM*****248*391*371*370*****<***** MISC									
INTERSTATE TRANSFER FUNDS									
PE	214,770	15,417	0	0	0	0	0	230,187	
R/W	160,405	0	0	0	0	0	0	160,405	
CONST	1,273,917	0	0	0	0	0	0	1,273,917	
RESRV	0	433,500	0	0	0	0	0	433,500	
TOTAL	1,649,092	448,917	0	0	0	0	0	2,098,009	

METROPOLITAN SERVICE DISTRICT
 TRANSPORTATION IMPROVEMENT PROGRAM
 QUARTERLY REPORT FOR QUARTER ENDING 30-JUN-83
 FAU/E4 PROJECTS BY SPONSOR AND FUNDING SOURCE
 14-Dec-83

PHASE3
 TIPSON.DAT

	OBLIGATED	1983	1984	1985	1986	1987	POST 1987	AUTHORIZED	
CLACKAMAS COUNTY PROJECTS (CONTINUED)									
*156 RAILROAD AVENUE/HARMONY ROAD-82ND TO MILWAUKIE CBD-UNIT I*****553*249*****								FAU9702	10037
INTERSTATE TRANSFER FUNDS									
PE	124,992	63,008	0	0	0	0	0	188,000	
R/W	0	31,992	0	0	0	0	0	31,992	
CONST	0	0	0	1,000,000	899,532	0	0	1,899,532	
TOTAL	124,992	95,000	0	1,000,000	899,532	0	0	2,119,524	
*157 CLACKAMAS TOWN CENTER SIGNALS*****561*251*****								N/A	10038
INTERSTATE TRANSFER FUNDS									
PE	10,530	0	0	0	0	0	0	10,530	
CONST	86,000	0	0	0	0	0	0	86,000	
TOTAL	96,530	0	0	0	0	0	0	96,530	
*158 82ND DRIVE-HWY 212 TO GLADSTONE/I205 INTERCHANGE*****578*252*****								FAU9653	10051
INTERSTATE TRANSFER FUNDS									
PE	170,000	0	0	0	0	0	0	170,000	
CONST	0	0	0	2,306,145	0	0	0	2,306,145	
TOTAL	170,000	0	0	2,306,145	0	0	0	2,476,145	
*159 THIESSEN/JENNINGS CORRIDOR-DATFIELD ROAD TO I205*****581*253*****								FAU9698	10052
INTERSTATE TRANSFER FUNDS									
PE	0	85,000	0	0	0	0	0	85,000	
CONST	0	0	0	0	0	878,704	0	878,704	
RESRV	0	0	0	0	0	0	0	0	
TOTAL	0	85,000	0	0	0	878,704	0	963,704	
*160 CLACKAMAS COUNTY ROLLBACK RESERVE*****761*261*493*403*454*****								N/A	
*161 RAILROAD AVENUE/HARMONY ROAD-82ND/SUNNYSIDE REALIGNMENT-UNIT II*****764*262*****								FAU9702	10037
INTERSTATE TRANSFER FUNDS									
PE	0	50,000	0	0	0	0	0	50,000	
R/W	0	700,000	0	0	0	0	0	700,000	
CONST	0	0	285,000	0	0	0	0	285,000	
TOTAL	0	750,000	285,000	0	0	0	0	1,035,000	

METROPOLITAN SERVICE DISTRICT
 TRANSPORTATION IMPROVEMENT PROGRAM
 QUARTERLY REPORT FOR QUARTER ENDING 30-JUN-83
 FAU/E4 PROJECTS BY SPONSOR AND FUNDING SOURCE
 14-Dec-83

PHASES TIPSON.DAT	OBLIGATED	1983	1984	1985	1986	1987	POST 1987	AUTHORIZED
CLACKAMAS COUNTY PROJECTS (CONTINUED)								
INTERSTATE TRANSFER FUNDS								
PE	2,003,406	213,425	195,000	0	0	0	0	2,411,831
R/W	8,190,873	1,652,992	0	0	0	0	0	9,843,865
CONST	11,381,932	3,822,165	11,292,742	4,448,145	899,532	878,704	0	32,723,220
RESRV	0	3,231,428	930,250	0	0	0	175,271	4,336,949
TOTAL	21,576,211	8,920,010	12,417,992	4,448,145	899,532	878,704	175,271	49,315,865
1505 TRANSFER FUNDS								
TOTAL	0	0	0	0	0	0	0	0
AGENCY TOTAL: CLACKAMAS COUNTY								
PE	2,003,406	213,425	195,000	0	0	0	0	2,411,831
R/W	8,190,873	1,652,992	0	0	0	0	0	9,843,865
CONST	11,381,932	3,822,165	11,292,742	4,448,145	899,532	878,704	0	32,723,220
RESRV	0	3,231,428	930,250	0	0	0	175,271	4,336,949
TOTAL	21,576,211	8,920,010	12,417,992	4,448,145	899,532	878,704	175,271	49,315,865

METROPOLITAN SERVICE DISTRICT
 TRANSPORTATION IMPROVEMENT PROGRAM
 QUARTERLY REPORT FOR QUARTER ENDING 30-JUN-83
 FAU/E4 PROJECTS BY SPONSOR AND FUNDING SOURCE
 14-Dec-83

PHASES
 TIPSON.DAT

	OBLIGATED	1983	1984	1985	1986	1987	POST 1987	AUTHORIZED		
WASHINGTON COUNTY PROJECTS										
*168 SW 65TH/NYBERG RD-15 TO SAGERT RD-UNIT #1-CONSTRUCTION*****#83*383*****									FAU9556	10003
INTERSTATE TRANSFER FUNDS										
CONST	422,206	0	0	0	0	0	0	422,206		
*169 SW NYBERG ROAD-SW 89TH AVE TO I5-UNIT #2*****#84*463*311*****									FAU9282	77139
INTERSTATE TRANSFER FUNDS										
R/W	331,500	0	0	0	0	0	0	331,500		
CONST	1,525,009	0	0	0	0	0	0	1,525,009		
RESRV	0	51,027	0	0	0	0	2,210	53,237		
TOTAL	1,856,509	51,027	0	0	0	0	2,210	1,909,746		
*170 CORNELL RD @ MURRAY BLVD - IMPROVE/SIGNALIZE*****#87*384*****									FAU9022	78082
INTERSTATE TRANSFER FUNDS										
CONST	108,517	0	0	0	0	0	0	108,517		
*171 SW GREENBURG RD - HALL TO OAK*****#91*385*216*****									FAU9207	77041
INTERSTATE TRANSFER FUNDS										
CONST	859,350	0	0	0	0	0	0	859,350		
*172 NW 185TH-WALKER ROAD TO SUNSET HIGHWAY-PHASE I*****#92*312*217*218*464*****									FAU9043	77076
INTERSTATE TRANSFER FUNDS										
PE	17,085	0	0	0	0	0	0	17,085		
CONST	1,399,564	0	0	0	0	0	0	1,399,564		
RESRV	0	-7,244	0	0	0	0	100,595	93,351		
TOTAL	1,416,649	-7,244	0	0	0	0	100,595	1,510,000		
*173 ALLEN BLVD RECONSTRUCTION-MURRAY BLVD TO HWY217*****#93*219*359*****									FAU9088	80858
INTERSTATE TRANSFER FUNDS										
PE	94,911	0	0	0	0	0	0	94,911		
R/W	1,166,370	0	0	0	0	0	0	1,166,370		
CONST	803,316	900,000	0	0	0	0	0	1,703,316		
RESRV	0	0	0	0	0	0	331,184	331,184		
TOTAL	2,064,597	900,000	0	0	0	0	331,184	3,295,781		

METROPOLITAN SERVICE DISTRICT
 TRANSPORTATION IMPROVEMENT PROGRAM
 QUARTERLY REPORT FOR QUARTER ENDING 30-JUN-83
 FAU/EA PROJECTS BY SPONSOR AND FUNDING SOURCE
 14-Dec-83

PHASES
 TIPSON.DAT

OBLIGATED	1983	1984	1985	1986	1987	POST 1987	AUTHORIZED	
WASHINGTON COUNTY PROJECTS (CONTINUED)								
*174 SW BARNES ROAD-HIGHWAY 217 TO SW 84TH-PHASE I*****95*465*220***** FAU9326 77070								
INTERSTATE TRANSFER FUNDS								
PE	62,186	0	0	0	0	0	62,186	
R/W	255,000	0	0	0	0	0	255,000	
CONST	846,023	117,970	0	0	0	0	963,993	
RESRV	0	0	0	0	0	68,821	68,821	
TOTAL	1,163,209	117,970	0	0	0	68,821	1,350,000	
*175 SW JENKINS/158TH-MURRAY BLVD TO SUNSET HIGHWAY*****97*466*221***** FAU9030 10107								
INTERSTATE TRANSFER FUNDS								
CONST	1,683,738	0	0	0	0	0	1,683,738	
RESRV	0	0	0	0	0	66,262	66,262	
TOTAL	1,683,738	0	0	0	0	66,262	1,750,000	
*176 SCHOLLS HWY(OR210) @ ALLEN - SIGNALS/WIDENING*****106*387***** FAU9234 78125								
INTERSTATE TRANSFER FUNDS								
PE	4,100	0	0	0	0	0	4,100	
CONST	110,438	0	0	0	0	0	110,438	
TOTAL	114,538	0	0	0	0	0	114,538	
*177 PROGRESS INTCHG OFF-RAMP TO SCHOLLS FERRY RD(OR210)*****109*315*388*405***** FAU9234 109								
INTERSTATE TRANSFER FUNDS								
CONST	294,873	0	0	0	0	0	294,873	
*178 HALL BLVD(AT HWY217)-LEFT TURN REFUGE FOR SB ON RAMP*****110*316*389***** FAU9091 78042								
INTERSTATE TRANSFER FUNDS								
CONST	103,883	0	0	0	0	0	103,883	
*179 HIGHWAY 217 AND SUNSET HIGHWAY INTERCHANGE*****121*451*318*231***** FAP79 79076								
INTERSTATE TRANSFER FUNDS								
PE	250,000	0	0	0	0	0	250,000	
R/W	3,485,000	700,000	0	0	0	0	4,185,000	
CONST	0	0	8,000,000	0	0	0	8,000,000	
TOTAL	3,735,000	700,000	8,000,000	0	0	0	12,434,999	

METROPOLITAN SERVICE DISTRICT
 TRANSPORTATION IMPROVEMENT PROGRAM
 QUARTERLY REPORT FOR QUARTER ENDING 30-JUN-83
 FAU/E4 PROJECTS BY SPONSOR AND FUNDING SOURCE
 14-Dec-83

PHASES
 TIPSON.DAT

	OBLIGATED	1983	1984	1985	1986	1987	POST 1987	AUTHORIZED		

WASHINGTON COUNTY PROJECTS (CONTINUED)										
*180 CORNELL ROAD RECONSTRUCTION-E MAIN TO ELAM YOUNG PARKWAY*****132*239*****									FAU9022	80038
INTERSTATE TRANSFER FUNDS										
PE	153,000	0	0	0	0	0	0	153,000		
R/W	238,000	25,000	0	0	0	0	0	263,000		
CONST	0	2,125,000	0	0	0	0	0	2,125,000		
RESRV	0	0	0	0	0	0	159,000	159,000		
TOTAL	391,000	2,150,000	0	0	0	0	159,000	2,700,000		
*181 BEAVERTON HILLSDALE HWY SIGNAL INTERTIE-LOMBARD TO SW 91ST AVE*****135*241*****									FAU9228	10007
INTERSTATE TRANSFER FUNDS										
PE	6,083	0	0	0	0	0	0	6,083		
CONST	67,716	0	0	0	0	0	0	67,716		
RESRV	0	0	0	0	0	0	16,201	16,201		
TOTAL	73,799	0	0	0	0	0	16,201	90,000		
*182 TUALATIN VALLEY HIGHWAY(OR8) @ 185TH STREET*****207*330*****									FAP32	76027
INTERSTATE TRANSFER FUNDS										
PE	144,160	0	0	0	0	0	0	144,160		
R/W	0	1,020,000	0	0	0	0	0	1,020,000		
CONST	0	0	688,750	0	0	0	0	688,750		
RESRV	0	0	0	0	0	0	-254,232	-254,232		
TOTAL	144,160	1,020,000	688,750	0	0	0	-254,232	1,598,678		
*183 HWY 217/72ND AVE INTCHG-PE & CONSTRUCTION-W2*****208*331*332*535*****									FAP79	80079
INTERSTATE TRANSFER FUNDS										
PE	221,188	0	0	0	0	0	0	221,188		
R/W	233,750	0	0	0	0	0	0	233,750		
CONST	1,012,463	-1	0	0	0	0	0	1,012,462		
TOTAL	1,467,401	-1	0	0	0	0	0	1,467,400		
*184 PACIFIC HWY W(OR99W)-BULL MTN RD TO N TIGARD INTCHG-TSM IMP #1*****228*362*406*****									FAP9	79063
INTERSTATE TRANSFER FUNDS										
PE	91,674	0	0	0	0	0	0	91,674		
CONST	961,007	0	0	0	0	0	0	961,007		
TOTAL	1,052,681	0	0	0	0	0	0	1,052,681		

METROPOLITAN SERVICE DISTRICT
 TRANSPORTATION IMPROVEMENT PROGRAM
 QUARTERLY REPORT FOR QUARTER ENDING 30-JUN-83
 FAU/E4 PROJECTS BY SPONSOR AND FUNDING SOURCE
 14-Dec-83

PHASES
 TIPSON.DAT

	OBLIGATED	1983	1984	1985	1986	1987	POST 1987	AUTHORIZED	

WASHINGTON COUNTY PROJECTS (CONTINUED)									
*185 CANYON/TV HWY CORRIDOR(CR8) TSM-WALKER RD TO MURRAY BLVD*****4229*363***** FAP32									78054
INTERSTATE TRANSFER FUNDS									
PE	36,950	0	0	0	0	0	0	36,950	
CONST	659,864	0	0	0	0	0	0	659,864	
TOTAL	696,814	0	0	0	0	0	0	696,814	
*186 FARMINGTON RD CORRIDOR(OR208) TSM-185TH AVE TO LOMBARD AVE*****236*364***** FAU9064									78057
INTERSTATE TRANSFER FUNDS									
PE	55,420	4,080	0	0	0	0	0	59,500	
CONST	0	100,000	190,500	0	0	0	0	290,500	
TOTAL	55,420	104,080	190,500	0	0	0	0	350,000	
*187 HALL BLVD CORRIDOR TSM-TV HWY TO SCHOLLS FERRY RD*****237*247*365***** FAU9091									78055
INTERSTATE TRANSFER FUNDS									
PE	47,780	0	0	0	0	0	0	47,780	
R/W	7,762	0	0	0	0	0	0	7,762	
CONST	173,395	0	0	0	0	0	0	173,395	
TOTAL	228,937	0	0	0	0	0	0	228,937	
*188 CEDAR HILLS BLVD/WALKER RD INTERSECTION IMPROVEMENT*****238*366*370***** FAU9097									78136
INTERSTATE TRANSFER FUNDS									
PE	8,624	0	0	0	0	0	0	8,624	
CONST	81,441	0	0	0	0	0	0	81,461	
RESRV	0	0	0	0	0	0	20,539	20,539	
TOTAL	90,065	0	0	0	0	0	20,539	110,624	
*189 BEAVERTON TUALATIN HIGHWAY--FANNO CREEK BRIDGE WIDENING*****4249*334*470*372***** FAU9091									78056
INTERSTATE TRANSFER FUNDS									
CONST	248,113	0	0	0	0	0	0	248,113	
RESRV	0	0	0	0	0	0	2,637	2,637	
TOTAL	248,113	0	0	0	0	0	2,637	250,750	

METROPOLITAN SERVICE DISTRICT
 TRANSPORTATION IMPROVEMENT PROGRAM
 QUARTERLY REPORT FOR QUARTER ENDING 30-JUN-83
 FAU/EA PROJECTS BY SPONSOR AND FUNDING SOURCE
 14-Dec-83

PHASES
 TIPSON.DAT

OBLIGATED	1983	1984	1985	1986	1987	POST 1987	AUTHORIZED	
WASHINGTON COUNTY PROJECTS (CONTINUED)								

*190 ALLEN BLVD INTERCHANGE - CONSTRUCTION*****264*335*407*****FAU79								80086
INTERSTATE TRANSFER FUNDS								
PE	8,245	0	0	0	0	0	8,245	
CONST	6,188,262	-183,234	0	0	0	0	6,005,028	
RESRV	0	68,255	0	0	0	0	68,255	
TOTAL	6,196,507	-114,979	0	0	0	0	6,081,528	

*191 CORNELL ROAD PHASE II-ECL TO CORNELIUS PASS ROAD*****585*254*****FAU9022								10060
INTERSTATE TRANSFER FUNDS								
PE	178,500	0	230,000	0	0	0	408,500	
R/W	0	0	370,000	0	0	0	370,000	
CONST	0	0	0	1,571,500	0	0	1,571,500	
TOTAL	178,500	0	600,000	1,571,500	0	0	2,350,000	

*192 MURRAY BLVD-JENKINS ROAD TO SUNSET HIGHWAY*****586*255*****FAU9067								10059
INTERSTATE TRANSFER FUNDS								
PE	150,000	150,000	0	0	0	0	300,000	
R/W	0	0	2,000,000	0	0	0	2,000,000	
CONST	0	0	0	3,201,530	0	0	3,201,530	
TOTAL	150,000	150,000	2,000,000	3,201,530	0	0	5,501,530	

*193 NW 185TH-ROCK CREEK BLVD TO TV HIGHWAY*****752*259*****FAU9043								10128
INTERSTATE TRANSFER FUNDS								
PE	170,000	306,250	250,000	0	0	0	726,250	
R/W	0	0	0	0	3,000,000	0	3,000,000	
CONST	0	0	0	0	0	5,966,747	5,966,747	
RESRV	0	0	0	0	0	0	-303,237	
TOTAL	170,000	306,250	250,000	0	3,000,000	5,966,747	-303,237	9,389,760

*194 TV HIGHWAY-21ST TO OAK*****828*267*****FAU32								79085
INTERSTATE TRANSFER FUNDS								
R/W	0	0	0	500,000	0	0	500,000	
CONST	0	0	0	0	1,300,000	0	1,300,000	
TOTAL	0	0	0	500,000	1,300,000	0	1,800,000	

METROPOLITAN SERVICE DISTRICT
 TRANSPORTATION IMPROVEMENT PROGRAM
 QUARTERLY REPORT FOR QUARTER ENDING 30-JUN-83
 FAU/E4 PROJECTS BY SPONSOR AND FUNDING SOURCE
 14-Dec-83

PHASES
 TIPSON.DAT

	OBLIGATED	1983	1984	1985	1986	1987	POST 1987	AUTHORIZED
WASHINGTON COUNTY PROJECTS (CONTINUED)								
*195 SCHOLLS FERRY ROAD/HALL BOULEVARD INTERSECTION*****829*484***** FAU9234								
INTERSTATE TRANSFER FUNDS								
PE	0	0	55,000	0	0	0	0	55,000
CONST	0	0	0	0	345,000	0	0	345,000
TOTAL	0	0	55,000	0	345,000	0	0	400,000
*196 HALL BOULEVARD-ALLEN TO GREENWAY*****830*268***** FAU9091								
INTERSTATE TRANSFER FUNDS								
PE	0	0	340,000	0	0	0	0	340,000
CONST	0	0	0	860,000	0	0	0	860,000
TOTAL	0	0	340,000	860,000	0	0	0	1,200,000
*197 OBLIGATIONAL AUTHORITY RESERVE-WASHINGTON COUNTY*****836*420***** N/A								
INTERSTATE TRANSFER FUNDS								
RESRV	0	56,379	943,621	0	0	0	-1,000,000	0
AGENCY TOTAL: WASHINGTON COUNTY								
FEDERAL AID URBAN SYSTEM FUNDS								
TOTAL	0	0	0	0	0	0	0	0
INTERSTATE TRANSFER FUNDS								
PE	1,699,906	460,331	875,000	0	0	0	0	3,035,237
R/W	5,717,382	1,745,001	2,370,000	500,000	3,000,000	0	0	13,332,382
CONST	17,549,198	3,059,734	8,879,250	5,633,030	1,645,000	5,966,747	0	42,732,958
RESRV	0	168,417	943,621	0	0	0	-790,020	322,018
TOTAL	24,966,486	5,433,482	13,067,870	6,133,030	4,645,000	5,966,747	-790,020	59,422,596
IS05 TRANSFER FUNDS								
TOTAL	0	0	0	0	0	0	0	0
AGENCY TOTAL: WASHINGTON COUNTY								
PE	1,699,906	460,331	875,000	0	0	0	0	3,035,237
R/W	5,717,382	1,745,001	2,370,000	500,000	3,000,000	0	0	13,332,382
CONST	17,549,198	3,059,734	8,879,250	5,633,030	1,645,000	5,966,747	0	42,732,958
RESRV	0	168,417	943,621	0	0	0	-790,020	322,018
TOTAL	24,966,486	5,433,482	13,067,870	6,133,030	4,645,000	5,966,747	-790,020	59,422,596

METROPOLITAN SERVICE DISTRICT
 TRANSPORTATION IMPROVEMENT PROGRAM
 QUARTERLY REPORT FOR QUARTER ENDING 30-JUN-83
 FAU/E4 PROJECTS BY SPONSOR AND FUNDING SOURCE
 14-Dec-83

PHASES
TIPSON.DAT

OBLIGATED	1983	1984	1985	1986	1987	POST 1987	AUTHORIZED
FUNDS TO BE ALLOCATED PROJECTS							
*198 FUNDS TO BE REALLOCATED*****1000*421*****							N/A
INTERSTATE TRANSFER FUNDS							
OTHER	-36,880	36,883	0	0	0	0	3
AGENCY TOTAL: FUNDS TO BE ALLOCATED							
FEDERAL AID URBAN SYSTEM FUNDS							
TOTAL	0	0	0	0	0	0	0
INTERSTATE TRANSFER FUNDS							
OTHER	-36,880	36,883	0	0	0	0	3
TOTAL	-36,880	36,883	0	0	0	0	3
1505 TRANSFER FUNDS							
TOTAL	0	0	0	0	0	0	0
AGENCY TOTAL: FUNDS TO BE ALLOCATED							
OTHER	-36,880	36,883	0	0	0	0	3
TOTAL	-36,880	36,883	0	0	0	0	3

METROPOLITAN SERVICE DISTRICT
 TRANSPORTATION IMPROVEMENT PROGRAM
 QUARTERLY REPORT FOR QUARTER ENDING 30-JUN-83
 FAU/E4 PROJECTS BY SPONSOR AND FUNDING SOURCE
 14-Dec-83

PHASES TIPSON.DAT	OBLIGATED	1983	1984	1985	1986	1987	POST 1987	AUTHORIZED
PROJECTS								
GRAND TOTAL								
FEDERAL AID URBAN SYSTEM FUNDS								
TOTAL	0	0	0	0	0	0	0	0
INTERSTATE TRANSFER FUNDS								
PE	26,746,675	7,170,676	2,321,009	984,400	402,000	355,000	-155,000	37,824,760
R/W	47,566,332	6,608,394	3,598,882	2,259,950	6,952,700	1,142,608	85,000	68,213,866
CONST	149,533,483	36,312,272	36,200,451	32,079,017	18,357,680	10,683,576	8,563,100	291,729,580
OPRTC	492,409	141,292	0	68,143	53,995	0	0	755,839
RESRV	201,857	48,806,386	6,798,599	2,049,048	1,415,125	1,036,734	41,821,408	102,129,157
OTHER	-36,880	36,883	0	0	0	0	0	3
TOTAL	224,503,876	99,075,904	48,918,941	37,440,559	27,181,500	13,217,918	50,314,508	500,653,205
ISO5 TRANSFER FUNDS								
TOTAL	0	0	0	0	0	0	0	0
REPORT TOTAL								
PE	26,746,675	7,170,676	2,321,009	984,400	402,000	355,000	-155,000	37,824,760
R/W	47,566,332	6,608,394	3,598,882	2,259,950	6,952,700	1,142,608	85,000	68,213,866
CONST	149,533,483	36,312,272	36,200,451	32,079,017	18,357,680	10,683,576	8,563,100	291,729,580
OPRTC	492,409	141,292	0	68,143	53,995	0	0	755,839
RESRV	201,857	48,806,386	6,798,599	2,049,048	1,415,125	1,036,734	41,821,408	102,129,157
OTHER	-36,880	36,883	0	0	0	0	0	3
TOTAL	224,503,876	99,075,904	48,918,941	37,440,559	27,181,500	13,217,918	50,314,508	500,653,205

STAFF REPORT

Agenda Item No. _____

Meeting Date _____

CONSIDERATION OF RESOLUTION NO. 83- FOR
THE PURPOSE OF AMENDING THE FY 1984 UNIFIED
WORK PROGRAM

Date: December 22, 1983

Presented by: Andy Cotugno

FACTUAL BACKGROUND AND ANALYSIS

Recommendation

Recommend adoption of the attached resolution amending the FY 1984 Unified Work Program (UWP) to combine the tasks and budgets of two work elements: 1) Phase I Alternatives Analysis Southern/Bi-State Corridors, and 2) Phase I Alternatives Analysis Barbur Corridor/Westside Branches. This amendment would also shift more of Metro's budget to Materials and Services to fund Data Processing associated with the Bi-State LRT study.

Policy Impact

This action will allow completion of the Southern Corridor/Bi-State studies this year and will delay Barbur/Westside work accordingly. Only start-up activities for the Barbur/Westside study (TAC formation, alternative definition, etc.) will be scheduled for this fiscal year.

Budget Impact

This amendment would consolidate available resources devoted to Phase I Alternatives Analysis/LRT studies within the existing UWP and will not affect other programs. In addition, a discretionary (e)(4) grant of \$65,000 for Barbur LRT engineering consultants is dropped due to the late startup. The amendment is needed to continue funding both Tri-Met and Metro Milwaukie/Bi-State project tasks.

Background

In FY 1983, the Regional LRT System Plan Scope of Work was approved, defining corridors to undergo Phase I Alternatives Analysis and phasing them for study. The Southern Corridor (Milwaukie) and the Bi-State Corridor were set as Study Phase 1, Barbur/Westside extensions as Study Phase 2 to be initiated after Study Phase 1, and Clackamas County extensions as Study Phase 3. The adopted UWP implements this overall strategy and recognizes that budget adjustments between Study Phases 1 and 2 may be necessary.

Study Phase 1 corridors (Milwaukie/Bi-State) have taken longer than anticipated because:

- Both the Southern Corridor and Bi-State studies bore the burden of developing new travel-forecasting packages which detailed zone structure and networks for the Eastside subarea and the Bi-State subarea. Developing these new systems took longer than anticipated. At the time the UWP was drafted, it was anticipated that Southern Corridor forecasts would be complete by July 1983. Instead they were not completed until the end of September.
- Delays in contracting with the engineering consultant assisting Tri-Met and the traffic consultant assisting in impact assessment have delayed engineering/capital costing and impact assessment phases of the work, stretching out the project schedule.
- Southern Corridor conceptual engineering at Tri-Met has taken longer than anticipated, due to the number of alignments and competing work elements.

Technical work on the Southern Corridor is nearly complete and Bi-State model calibration is also complete. Both traffic and structural engineering contracts are underway.

Delaying the schedule for the Barbur/Westside Branches phase of study will allow the Southwest Corridor Study to develop the travel-forecasting tools to be used and to develop a working relationship with the jurisdictions involved prior to initiating the transitway study.

EXECUTIVE OFFICER'S RECOMMENDATION

The Executive Officer recommends adoption of the attached resolution.

COMMITTEE CONSIDERATION AND RECOMMENDATION

AC/NM/srb
0416C/366
12/13/83

BEFORE THE COUNCIL OF THE
METROPOLITAN SERVICE DISTRICT

FOR THE PURPOSE OF AMENDING THE) RESOLUTION NO.
FY 1984 UNIFIED WORK PROGRAM)
) Introduced by the Joint
) Policy Advisory Committee
) on Transportation

WHEREAS, The FY 1984 Unified Work Program (UWP) was adopted
May 26, 1983 by Resolution No. 83-404; and

WHEREAS, Changes to the UWP must be approved by the Metro
Council and the Intermodal Planning Group; and

WHEREAS, The FY 1984 UWP must be revised to accurately
reflect task priorities and project schedules; now, therefore,

BE IT RESOLVED,

1. That the Metro Council hereby approve the amendments
to the FY 1984 UWP as shown in Exhibits "A," "B" and "C."
2. That staff is authorized to submit this resolution
with its exhibits and necessary grant amendments to the Urban Mass
Transportation Administration for approval.

ADOPTED by the Council of the Metropolitan Service District
this _____ day of _____, 1983.

Presiding Officer

NM/srb
0416C/366
12/13/83

EXHIBIT "A"

PHASE I ALTERNATIVES ANALYSIS - SOUTHERN/BI-STATE/BARBUR CORRIDORS

Program Objectives:

1. Complete the technical analysis for the Phase I Alternatives Analysis in the Central Portland area, Southern Corridor and Bi-State Corridor.
2. Determine whether to proceed with a Phase II Alternatives Analysis; produce a report describing promising alternatives.
3. Amend the Regional Transportation Plan (RTP) to include any feasible transitway corridors and initiate a Phase II Alternatives Analysis/Draft Environmental Impact Statement (DEIS) accordingly.
4. Adopt the McLoughlin Boulevard highway and transit improvement program, staging plan and financing strategy.
5. Allocate the McLoughlin Boulevard Interstate Transfer Reserve.
6. Begin the technical analysis for the Phase I Alternatives Analysis in the Barbur Corridor and for extensions to Hillsboro, Tualatin and between Beaverton and Tigard.

Relation to Previous Work:

The Regional Light Rail Transit (LRT) System Plan Scope of Work (approved in FY 83) serves as an overall guide for the Regional LRT System Plan project phases. This Scope of Work provides a context for following the federal process for a Phase I and Phase II Alternatives Analysis. The first geographic area of analysis, which is comprised of the Southern Corridor, the Bi-State Corridor (I-5 North and I-205 North) and the Central Portland study area, was begun in FY 83. All of the technical work is scheduled for completion prior to FY 85. A supportive consulting engineering effort was also begun in FY 84, in accordance with the Regional LRT System Plan Scope of Work.

The Barbur Corridor/Westside Branches is the second geographic area identified for evaluation in the "Regional LRT System Plan Scope of Work," adopted in FY 83. All work in this area will be built upon the results of the Westside Corridor Project DEIS (March 1982) and Preferred Alternatives Report (January 1983).

Products:

1. McLoughlin Corridor Highway/Transit Staging Plan and Financing Strategy.

2. Phase I Alternatives Analysis recommendations and resulting amendments to RTP.
3. Phase I Alternatives Analysis "Promising Alternatives" report, documenting analysis.
4. Decision on whether to proceed with a Phase II Alternatives Analysis in any of these corridors.
5. Allocation of McLoughlin Corridor Interstate Transfer Reserve.

Responsibilities:

Metro is responsible for the overall conduct of the study, coordination of the Oregon decisions, Oregon public involvement, technical analysis associated with travel forecasts, impact analysis and cost-effectiveness evaluation.

Tri-Met is responsible for definition of alternatives including engineering analysis, capital costing and operating costing.

The Regional Planning Council of Clark County (RPC) is responsible for coordinating Washington decisions and development of alternatives within Washington (including highway network coding, transit route design and population/employment forecasts).

Portland will provide input on impact analyses and provide technical supervision of traffic impact analyses in Portland.

Expenses:

Metro: Personnel	\$157,527
M & S	62,300
	<u>\$219,827</u>
Tri-Met: Personnel	\$ 93,080
M & S	133,000
	<u>\$226,080</u>
Portland: Personnel	\$ 10,000
TOTAL	<u>\$455,907</u>

Revenues:

FY 83 (e) (4)	4,528
Metro Match	799
FY 84 (e) (4)	158,100
Metro Match	13,950
Tri-Met Match	13,950
Phase I Alt. Anal. (e) (4)	170,000
Tri-Met Match	28,500
(in-kind)	
Portland Match	1,500
Section 9A	51,664
Tri-Met Match	12,916
TOTAL	<u>\$455,907</u>

AC/srb
0416C/366
12/13/83

EXHIBIT "B"

FY 84 e(4)
Grant Amendment
OR-29-9009

	<u>Approved</u>	<u>+</u> <u>-</u>	<u>Proposed</u>
1. Phase I Altern./Analysis So. Corr./Bi-State Corr.	\$ 57,000	- 57,000	0
2. Phase II Altern./Analysis Barbur/Westside	129,000	-129,000	0
3. Westside Corridor	117,647	0	\$117,647
4. Southwest Corridor	12,500	0	12,500
5. Transp. Improvement Prog.	36,813	0	36,813
6. Phase I Altern./Analysis* So./Bi-State/Barbur	0	+186,000	186,000
	<u>\$352,960</u>	<u>0</u>	<u>\$352,960</u>

*Combining the two separate segments of the Phase I Alternatives Analysis into one task.

Project Financing

UMTA (85%)	\$300,016
Local (15%)	<u>52,944</u>
	\$352,960

KT:lmk
12-8-83

FY 84 FUNDING SUMMARY

federal funding													CARRYOVER				
FY84	FY84	SEC 8	FY84	FY83 SEC 8	FY82 SEC 8	FY80 SEC 8	FY83 e(4)	FY82 e(4)	FY83 e(4)	EPA 175	WESTSIDE	PHWA	LOCAL	TOTAL			
PL/ODOT	SEC 8	DISCTRY	e(4)	OR-09-0012	OR-09-0029	OR-09-0020	OR-23-9001	OR-29-9007	DISCTRY	OR-19-0005	SEC 105	OR-29-9004	SEC 9A	HPR/ODOT	MATCH		
Phase I AA Southern/Bi-State/Barbur																	
Metro			158,100				4,528		28,500						33,728	224,856	
Tri-Met									133,000				51,664		36,387	221,051	
Portland									8,500						1,500	10,000	
McLoughlin - Clackamas County								8,091							1,428	9,519	
Westside Corridor																	
Metro			100,000									35,942			23,990	159,932	
Tri-Met													35,955		8,989	44,944	
Southwest Corridor/Metro	34,000	29,432	10,625												9,233	83,290	
RTP Refinement/Metro	38,100	29,600		15,081	422										11,276	94,479	
Elderly & Handicapped Plan/Metro				22,320											5,580	27,900	
Elderly & Handicapped Plan/Tri-Met													16,000		4,000	20,000	
Technical Assistance/Metro	29,100															29,100	
Coordination & Management/Metro	32,500	47,600													11,900	92,000	
Data Monitoring/Metro	14,900	28,080													96,417	139,417	
Travel Forecast/Metro	20,552	14,000		14,392											7,098	56,042	
Travel Forecast/Tri-Met					4,000										1,000	5,000	
Model Refinement Disc/Metro		24,000													6,000	30,000	
Air Quality Program																	
Metro										3,000	5,000				0	8,000	
Portland										10,730					0	10,730	
Transp. Imp. Program/Metro		51,288	31,291												18,344	100,923	
Transp. Financing/Metro								81,971							14,465	96,436	
Energy Contingency/Tri-Met					4,000										1,000	5,000	
Transit Development/Tri-Met						16,989									4,248	21,237	
Computer Purchase/Metro	47,868												28,224		22,418	98,510	
ODOT Planning Assistance														145,000		145,000	
Subtotal																	
	217,020	200,000	24,000	300,016	51,793	8,422	16,989	86,499	8,091	170,000	13,730	5,000	35,942	145,000			
Note: Amounts shown are federal share except PL and HPR. PL is \$184,467 with match \$32,553 at 85/15 ratio.																	
													TDP Update/Tri-Met	15,326	3,831	19,157	
													Capital Dev. Plan/Tri-Met	34,189	8,547	42,736	
													TSEP/Tri-Met	156,110	39,028	195,138	
													Transit Perf. Analy./Tri-Met	42,600	10,650	53,250	
													Labor Mgmt. & Prod. Analy./Tri-Met	10,160	2,540	12,700	
													Mgmt. Info. Sys. Dev./Tri-Met	52,640	13,160	65,800	
													MMIA/Tri-Met	43,896	10,974	54,870	
													Network Sim. & Analy./Tri-Met	16,960	4,240	21,200	
													On-Board O-D Survey/Tri-Met	2,240	560	2,800	
													CE TIP Analy. & Eval./Tri-Met	67,616	16,904	84,520	
													Transit Ctr. & TSM Dev./Tri-Met	17,792	4,448	22,240	
													Service Dev./Planning/Tri-Met	41,396	10,349	51,745	
													Financial Forecast/Tri-Met	9,640	2,410	12,050	
													Private Sector Partic./Tri-Met	4,000	1,000	5,000	
													Civil Rights/Tri-Met	6,939	1,735	8,674	
													Program Administration/Tri-Met	4,000	1,000	5,000	
														657,347	450,397	2,390,246	

Rev. 7-25-83
12-8-83

STAFF REPORT

Agenda Item No. _____

Meeting Date _____

CONSIDERATION OF A MOTION APPROVING TRANSMITTAL
TO THE U.S. DEPARTMENT OF TRANSPORTATION THE
BREAKDOWN OF INTERSTATE TRANSFER FUNDING BETWEEN
TRANSIT AND HIGHWAY CATEGORIES

Date: December 22, 1983

Presented by: Andrew Cotugno

FACTUAL BACKGROUND AND ANALYSIS

Recommendation

Adopt a motion approving transmittal of the attached material to U.S. Department of Transportation (USDOT) defining how the Portland region Interstate Transfer funds are divided between transit and highway categories.

Background

Annual apportionment of Interstate Transfer funds are allocated to metropolitan areas on a formula based on their share of the cost to complete the Interstate Transfer program. Seventy-five percent of available highway funds are allocated by formula and 50 percent of available transit funds. The split between transit and highway as shown in the attached material is based on the individual project allocations approved in the Transportation Improvement Program.

EXECUTIVE OFFICER'S RECOMMENDATION

The Executive Officer recommends approval of the motion.

COMMITTEE CONSIDERATION AND RECOMMENDATION

AC/srb
0450C/366
12/23/83



Memo

METROPOLITAN SERVICE DISTRICT 527 S.W. HALL ST., PORTLAND, OREGON 97201 503 221-1646
 Providing Zoo, Transportation, Solid Waste and other Regional Services

Date: December 21, 1983

To: Ted Spence, ODOT

From: Andrew Cotugno *AK*

Regarding: Input to Interstate Transfer Apportionment Factors

Attached in response to FHWA and UMTA's request is the split of the Portland region Interstate Transfer program between highway and transit. As shown, the cost to complete -- assuming obligations through September 30, 1983 and apportionments through FY 84 -- are:

	<u>Highway</u>	<u>Transit</u>	<u>Total</u>
Cost to Complete:			
a) w/obligations thru 9-30-83	\$191,862,711	\$17,263,584	\$209,126,295
b) w/FY 84 apportionments	\$106,809,867	\$ 5,313,339	\$112,123,206

This information has been reviewed by TPAC on December 22, 1983 but is not scheduled for JPACT until January 12, 1984 and the Metro Council January 26, 1984. I understand the transit versus the highway split can be updated annually if necessary.

ACC:lmk

Attachments

PORTLAND REGION INTERSTATE TRANSFER PROGRAM
 (Input to Federal Apportionment Factors)

	<u>Highway</u>	<u>Transit</u>	<u>Total</u>
Total Program	\$347,254,300	\$153,398,904	\$500,653,204
Obligated thru Sept. 30, 83	155,391,589	136,135,320	291,526,909
Remainder 9/30/83	191,862,711	17,263,584	209,126,295
	(91.745%)	(8.255%)	(100%)
Apportioned thru FY 1984	<u>85,052,844</u>	<u>11,950,245</u>	<u>97,003,089</u>
Portland Region Cost-to-Complete	\$106,809,867	\$5,313,339	\$112,123,206
National Cost-to-Complete	\$4,713,000,000	\$1,166,000,000	
Portland Share	2.265%	.46%	
Estimated FY 1985 Allocation	x \$700M x 75% \$11.9M	x \$390M x 50% \$.9M	

0459C/D3

PORTLAND REGION (e) (4) HIGHWAY PROGRAM SUMMARY BY YEAR

	Obl. <u>thru 84</u>	<u>85</u>	<u>86</u>	<u>87</u>	Post <u>87</u>	<u>Total</u>
Cat. I	\$ 57.8M	\$14.1	\$ 3.	\$ 0	\$42.5	\$117.4M
Port.	61.8	9.1	17.1	6.3	.6	94.8
Mult. Co.	20.2	3.0	1.6	1.2	0	26.0
Clack. Co.	42.9	4.4	.9	.9	.2	49.3
Wash. Co.	43.5	6.1	4.6	5.2	0	59.4
	<u>\$226.1M</u>	<u>\$36.7</u>	<u>\$27.2</u>	<u>\$13.6</u>	<u>\$43.3</u>	<u>\$346.9M</u>

(e) (4) HIGHWAY FUNDING NEED

Cumulative
Allocation \$240.4M

FY 84 Program 226.1

Carryover \$ 14.3M

Carryover	\$ 7.3	\$ 7.0	
Formula	11.9	10.5	\$ 9.5
Discretionary	<u>17.5</u>	<u>9.7</u>	<u>4.1</u>
Total	\$36.7M	\$27.2M	\$13.6M

Requested Earmark	\$29.5M	\$20.2M	\$13.6M
----------------------	---------	---------	---------

AC/gl
0458C/D3

ODOT FY 1984-89
SIX-YEAR HIGHWAY IMPROVEMENT PROGRAM

I. Response to JPACT position.

II. Other major changes from public meetings and Commission and staff review.



METROPOLITAN SERVICE DISTRICT

Providing Zoo, Transportation, Solid Waste and other Regional Services

Rick Gustafson
Executive Officer

Metro Council

Cindy Banzer
Presiding Officer
District 9

Bob Oleson
Deputy Presiding
Officer
District 1

Richard Waker
District 2

Charlie Williams
District 3

Corky Kirkpatrick
District 4

Jack Deines
District 5

George Van Berg
District 6

Jarron Kelley
District 7

Ernie Bonner
District 8

Bruce Etlinger
District 10

Marge Kafoury
District 11

Gary Hansen
District 12

ODOT SIX-YEAR PROGRAM

Portland Region Position adopted by JPACT
for Consideration by ODOT

I. REGIONAL PROGRAM ADOPTED BY JPACT

A. Major emphasis in support of projects identified in "Draft" 84-89 Program in particular:

- New funding to complete previously initiated projects.
- New projects.

Strong recognition of the fair treatment by ODOT staff in funding many high priority projects.

B. Focused emphasis on several key project additions to, but not at the expense of, the "Draft" 84-89 Program:

	<u>Ranking</u>
• N.E. Portland Highway - PE, ROW, CON	1,210
• Sunset Highway @ 158th - PE and ROW	907.5
• Sunset Highway @ 185th - PE	830

C. Recognition and support of:

1. Minor projects to be pursued as needed between ODOT and developers and jurisdictions.
2. Resurfacing of at least 1-5 and Highway 217.
3. Use of safety funds for hazard locations as determined by ODOT and local staff.
4. Use of bridge replacement funds as determined by ODOT.
5. Use of bike funds as determined by staff and local bike committees.

527 SW Hall S.
Portland, OR
97201
503/221-1646

II. STATUS OF PROJECTS IN CURRENT "DRAFT" 84-89 PROGRAM

- A. Projects currently identified for funding in the 82-87 Program and retained in the "Draft" 84-89 update are as follows:

I-5/Greeley Ramps	T.V. Highway @ Murray
I-405 Extension	Sunset @ Murray - PH I
I-5/Slough Bridge - Phase I and II	Ross Island Bridge Overlay
I-205/South Banfield Ramps	Tualatin P+R
I-5/Water Avenue - Phase I	Sandy P+R
I-5/Lower Boones Fry. Signals	Oregon City P+R
I-5 South Ramp Metering	Lents P+R

- B. Historical ODOT project commitments that are identified in the "Draft" 84-89 Six-Year Program for funding are as follows:

I-5/Slough Bridge - Phase III
I-5 Water Avenue - Phase II
I-5 NB Marquam Ramp to I-84 EB
I-205 Six-Lane Widening
I-84/181st Interchange
I-84 Widening - 117th to 122nd
I-5 Widening at Portland Boulevard
I-5 Ramp Improvements - Banfield to Fremont Bridge

- C. Historical ODOT project commitments that remain unfunded in the "Draft" 84-89 Six-Year Program are as follows:

I-84 Widening - 122nd to Sandy River
I-5 Marquam Ramps to McLoughlin Boulevard

- D. New projects identified in the "Draft" 84-89 Six-Year Program are as follows:

I-5/Terwilliger Interchange
I-205/Lester Interchange
Sunset/Murray Interchange - Phase II
I-5/Nyberg Interchange
I-5/Wilsonville and Stafford Signals
Sunset Climbing Lane
Mt. Hood Highway @ Palmquist
Sunset/Helvetia Signal
I-84 WB to I-5 SB Ramp Improvement
I-205 SB @ Highway 224 Auxillary Lane
I-205 @ Oregon City Bypass Ramp Improvement
99W @ Highway 217 Signal Channelization

III. DISPOSITION OF PROJECTS CONSIDERED FOR INCLUSION IN THE SIX-YEAR PROGRAM BUT NOT RECOMMENDED FOR FUNDING

- A. McLoughlin Boulevard - allocation of "Primary" funds premature pending resolution of (e)(4) funds to highway vs LRT purposes; may be appropriate at a later date.
- B. Sunset ramp metering and T.V. Highway - 21st to Oak - ODOT funding not necessary due to allocation of (e)(4) funds.
- C. Airport Way, Marine Drive, Beaverton-Hillsdale Highway - not currently eligible additions to FAP system; possibility of (e)(4) funding resulting from funds released by St. Helens Road, I-5/Terwilliger and N.E. Portland Highway
- D. Remainder of Sunset interchanges - needed for long-range development; to be considered in future updates.
- E. I-84 widening - 122nd to Sandy River and I-5 Marquam ramps to McLoughlin Boulevard - long-term funding commitment should be retained; will be considered in future updates.
- F. Graham Road - ineligible for FAI or FAP funds; alternate source should be identified.
- G. I-5/Norwood Interchange; Tigard Bypass and 99W Corridor improvements - to be considered after completion of Southwest Corridor study.
- H. Scholls Ferry Road - ineligible for FAI or FAP funds; alternate source should be identified.

AC/gl
9292B/354

COST STATUS REPORT

Banfield Light Rail Project
Tri-Met

January 11, 1984

FUNDING ALLOCATED

Grants Received:

Section 3	\$ 17,375,000
Interstate Transfer - Transit	160,837,080
Interstate Transfer - Highway	<u>31,275,884</u>
SUBTOTAL	\$209,487,964

Remaining Grants to be Received:

Section 3	\$ 98,569,063
Interstate Transfer - Transit	<u>11,951,597</u>
SUBTOTAL	\$110,520,660
TOTAL	\$320,008,624

ESTIMATED COST AT COMPLETION

Budget	\$307,694,040
Contingency	<u>12,314,585</u>
TOTAL	\$320,008,624

STATUS

137 contracts awarded to date
35 remaining to be let
68.2 of budget committed to contract
37.4 of contracts completed

The three-story Operations Facility at Ruby Junction is complete. Staff moved in September.

The facility's 12.3 acre yard will be complete in time for the arrival of the first vehicles.

First light rail car has been built and is in Pueblo, Colorado for testing. The first car will arrive in Portland in March.

2.1 miles of trackwork from Gresham to Ruby Junction is complete and will be the test track for light rail vehicles.

All track and copper wire has been procured; electrification work has started.

4.5 miles of Banfield Freeway work is 50% complete.

E. Burnside and Holladay Street construction work is underway.

Right-of-way acquisition is nearly complete except for E. Burnside Street parcels.

Major contracts yet to be awarded:

Estimated Value

2/84	Line Section 4A - Holladay	\$ 5,757,428
2/84	Steel Bridge - ODOT	13,820,000
2/84	Line Section 2B - East Burnside	12,509,095
4/84	Stations, P & R Lots	3,589,654
4/84	Fare Collection	3,248,000
5/84	Line Section 4B - Downtown	24,142,630
10/84	Line Section 3 - Banfield	<u>7,572,775</u>
	TOTAL	\$70,639,582

SCHEDULE

The project is on schedule in terms of meeting the overall systemwide start-up date of mid-1986.

While some parts of the project have slipped behind schedule, they have not yet caused overall project delays.

There are three critical areas which are being watched closely:

1) right-of-way acquisition on E. Burnside; 2) access date to the Banfield Freeway for LRT construction; and 3) utility relocations in downtown Portland.

BUDGET STATUS

12/30/83

By Major Category

<u>Major Category</u>	<u>Projected Costs at Completion</u>	<u>Committed Contracted To Date</u>	<u>Payments To Date</u>	<u>Percent Budget Complete*</u>
26 Light Rail Vehicles & Equipment	\$ 25,100,000	\$ 22,697,496	\$ 7,890,944	31.4
Operations Facility and Maintenance Equipment	11,696,425	9,443,036	8,910,095	76.2
Traction Electrification	10,220,015	8,353,649	2,180,818	21.3
Communications & Signals	7,184,000	6,363,823	1,379,193	19.2
Track, Lifts, Signs, Fare Collection	13,635,216	9,628,829	8,390,219	61.5
LS-1, LS-2, Stations & P/R Lots	30,027,747	11,826,931	5,971,031	19.9
LS-3	7,572,775			
LS-4, Vintage Trolley	33,965,077	1,699,340	372,314	1.1
ODOT Managed Work	106,211,493	92,391,493	49,135,146	46.3
UMTA 74,935,609				
FHWA 31,275,884				
Real Estate Acquisition	17,898,970	16,878,769	12,741,139	71.2
Professional Services	24,466,398	14,296,056	10,864,072	44.4
Tri-Met Administration, Force Account Metro Planning, Contingencies	<u>19,715,933</u>	<u>16,377,330</u>	<u>7,111,309</u>	<u>36.1</u>
TOTAL BUDGET	307,694,040	209,956,752	114,946,280	37.4%
		(68.2%)	(54.7%)	

*Payments divided by Projected Costs

COMMITTEE MEETING TITLE JPACT

DATE 1/12/84

NAME

AFFILIATION

✓ M- RICHARD WAKER METRO

✓ M- ED FERGUSON WSDOT

✓ M- JOHN FRENING TRI-MET

✓ S- COTRINO

✓ S- BRISTOLSON

✓ M- DICK AKOENOWSKI City of Vancouver

✓ MA- EARL BLUMENAUER Multnomah County

✓ M- MIKE LINDBERG City of Portland

✓ M- Charlie Williamson Metro

✓ G- Larry Rice Wash. Co.

✓ G- Ted Spence ODOT

✓ G- Beba Rucker Mull Co.

✓ M- Ed Hardt ODOT

✓ M- Margaret Weil East Co. Cities

✓ S- Keith Lawton Metro

✓ S- Bill Pettis ||

✓ G- Guadalupe B. Buel Representing OGB, Inc + self.

✓ G- Keith Ahola WSDOT

✓ S- Peg Hemmard METRO

Media Rosemary Reynolds KYXT Radio

✓ G- KEN ZATARIN TRI-MET

✓ G- Bob Post TRI-MET

✓ G- GARY HANSEN Metro

✓ G- JANE CEASE House Transportation Committee

✓ G- Caston Cross Regn legislature

