

BEFORE THE METRO COUNCIL

FOR THE PURPOSE OF WAIVER OF) RESOLUTION NO 97-2506
THE FILING DEADLINE FOR THE)
CHAMBERLAIN PETITION FOR AN) Introduced by Councilor McLain
URBAN GROWTH BOUNDARY)
LOCATIONAL ADJUSTMENT)

WHEREAS, the Metro Code establishes the deadline for filing petitions for individual amendments of the Urban Growth Boundary (UGB) as March 15 of each calendar year; and

WHEREAS, a petition for locational adjustment was received from Joseph Chamberlain on March 14, 1997, and that application was still incomplete on April 3, 1997, the deadline for final completion of all such applications; and

WHEREAS, the petition now seems to be complete except for the required recommendation by Washington County; and

WHEREAS, the application involves land in the area of the Taylor Industrial Park adjacent to the City of Forest Grove; and

WHEREAS, the Metro Code 3.01.033(d) provides as follows: "Upon request by a councilor or the executive officer, the council may, by an affirmative vote of two-thirds of the full council, waive the filing deadline for a particular petitioner or petitions . . . Such waiver shall not waive any other requirement of this chapter"; and

WHEREAS, the Executive Officer has taken no position on this matter; and

WHEREAS, granting the waiver indicates no position as to the merits of this issue; now, therefore,

BE IT RESOLVED:

1. That Mr. Chamberlain be permitted to complete the application for a locational adjustment in the vicinity of the Taylor Industrial Park; and
2. That upon completion of the petition, a hearings officer be assigned for completion of review of this locational adjustment petition.

ADOPTED by the Metro Council this 3rd day of May 1997.



Jon Kvistad, Presiding Officer

APPROVED AS TO FORM:



Daniel B. Cooper, General Counsel

LSS:kaj
F:\DOCS#07.P&D\02UGB\02AMENDM.ENT\97-2506.RES
5/8/97

STAFF REPORT

IN CONSIDERATION OF RESOLUTION NO. 97-2506, FOR THE PURPOSE OF WAIVER OF THE FILING DEADLINE FOR THE CHAMBERLAIN PETITION FOR AN URBAN GROWTH BOUNDARY LOCATIONAL ADJUSTMENT

DATE: May 1, 1997

PROPOSED ACTION

A waiver of the deadline for filing a UGB locational adjustment is being sought by a Metro Council member according to Metro code 3.01.33(d). Five votes are required to enact this resolution.

BACKGROUND

An Urban Growth Boundary amendment was filed with Metro on March 14, 1997, one day before the deadline, requesting that a 1.28 acre parcel be added to the UGB, adjacent to Forest Grove. Ray Valone, Senior Regional Planner in the Growth Management Department, has been handling this application. He describes the particulars as follows:

The proposal is to swap 1.13 acres of land (Parcel 1 on map) the applicant claims is inside the UGB for 1.28 acres of land (Parcel 2 on map) outside the UGB. The Metro UGB map, however, shows both pieces of land to be outside the boundary. The City of Forest Grove agrees that the properties are both outside the line. Some of the confusion is due to the UGB line being defined by the 1974 Washington County floodplain elevation line (see attached map.) Both of the properties are zoned as EFU, though the applicant has indicated that the 1.13 acre piece is General Industrial.

The application was still incomplete on April 3, 1997, the deadline for final completion of all such applications. The City of Forest Grove has recommended approval of this petition. Washington County has not taken action on any recommendation. Such an action by the county is required to complete the application.

The Executive Officer has taken no position on this matter. Granting the waiver does not indicate a position as to the merits of the issue. If the request is not granted, the applicant will have to wait until March of 1998 to resubmit

Post-It® Card # 7671

Date	3-17-21	# of pages	2
From	Bob Tiernan		
Co./Dept.	City of Forest Grove		
Phone #	359-3227		
Fax #	359-3207		

To	Ray Valone		
Co./Dept.	Metro		
Phone #	797-1808		
Fax #	797-1211		

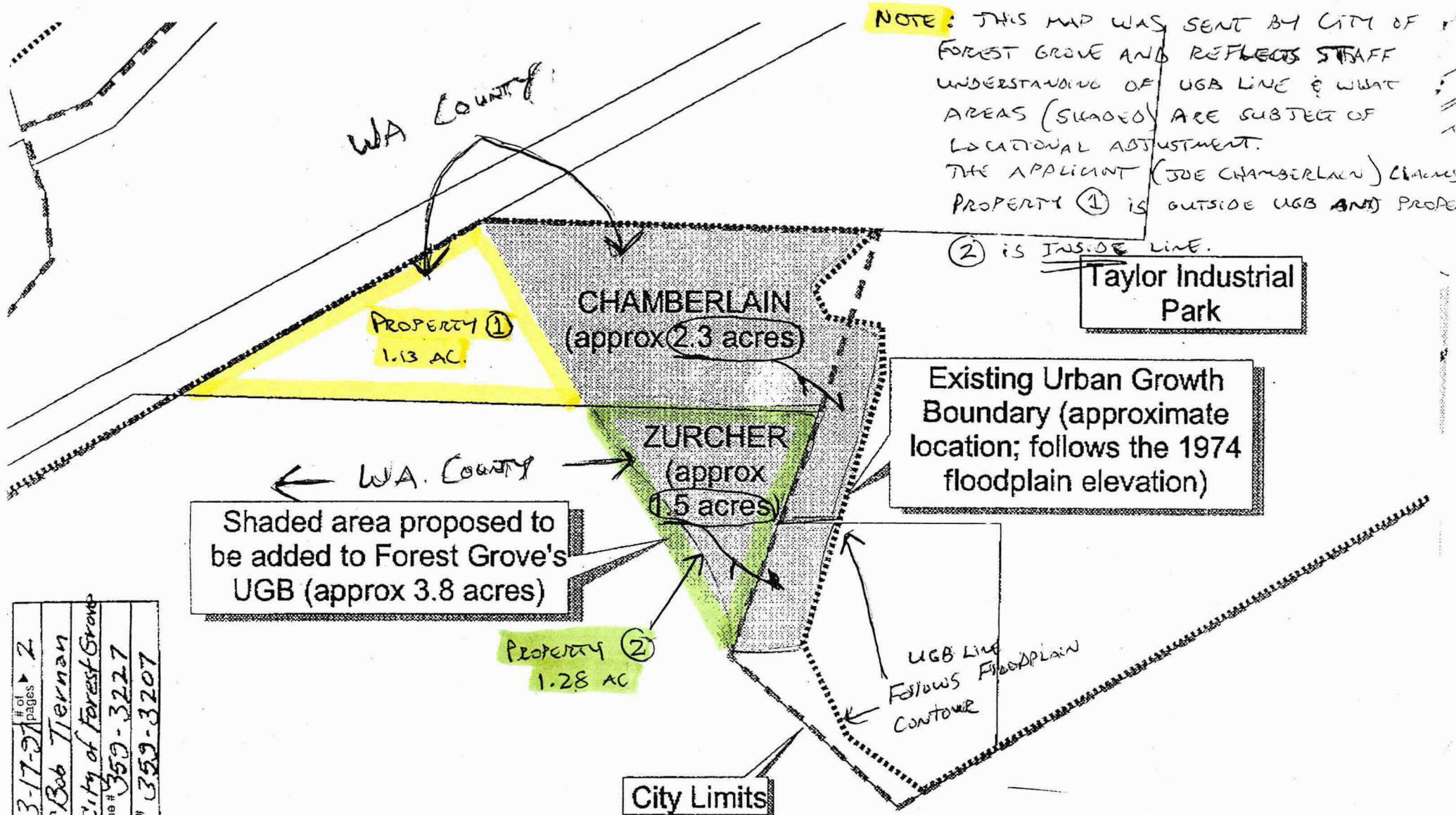

NOTE: THIS MAP WAS SENT BY CITY OF FOREST GROVE AND REFLECTS STAFF UNDERSTANDING OF UGB LINE & WHAT AREAS (SHADED) ARE SUBJECT OF LOCATIONAL ADJUSTMENT. THE APPLICANT (JOE CHAMBERLAIN) CLAIMS PROPERTY ① IS OUTSIDE UGB AND PROPERTY ② IS INSIDE LINE.

Inset Map of Locational Adjustment