

150
X

LEACHATE COLLECTOR PIPE
SEE SHEET 2 - CONSTRUCT
AFTER ON-SITE ROAD IS
RELOCATED - PHASE II

TIRE CHIP
STORAGE A

SEE SHEET 2

CONSTRUCT GAS MONITORING
WELLS AFTER SITE IS OPERATING
(20 PLACES) SEE DETAIL SHEET

TIRE CHIP AND ROCK
STORAGE AREA

PHASE II
FILL AREA

LEACHATE
COLLECTOR
PIPE

LEACHATE
COLLECTOR
SUMP

EXISTING ROAD

EXISTING ROAD

MONITORING
& OPERATING
WELL SHEET

NOTE:

IN ORDER TO OPTIMIZE THE
CHANCES FOR METHANE GAS
RECOVERY FROM THIS SITE
AFTER LANDFILLING, IS CO
NO LARGE ROCK, CONCRETE
TIMBERS, ETC. SHOULD BE
IN THE CENTER OF THE SITE
ALONG THE EDGES. METHANE
RECOVERY WELLS, IF FEAS
WOULD BE PLACED IN THE
AFTER CONNECTING TO THE
SIDEWALL PASSIVE VENTS

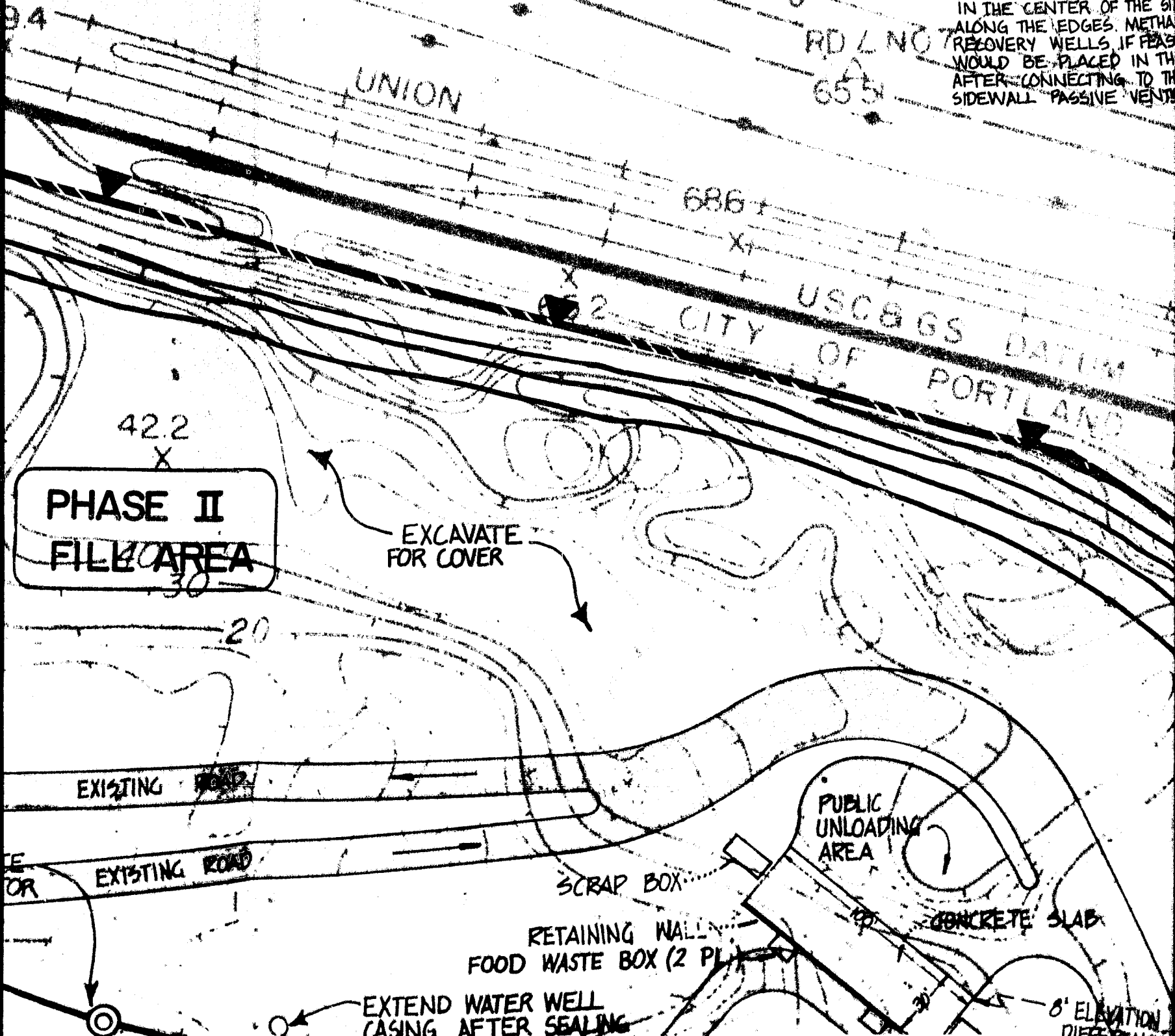

PHASE II
FILL AREA

EXCAVATE
FOR COVER

EXISTING ROAD

EXISTING ROAD

PUBLIC
UNLOADING
AREA

SCRAP BOX

RETAINING WALL
FOOD WASTE BOX (2 PL)

EXTEND WATER WELL
CASING AFTER SEALING

CONCRETE SLAB

8' ELEVATION
DIESEL

NOTE:

IN ORDER TO OPTIMIZE THE CHANCES FOR METHANE GAS RECOVERY FROM THIS SITE AFTER LANDFILLING IS COMPLETE, NO LARGE ROCK, CONCRETE, STUMPS, TIMBERS, ETC. SHOULD BE PLACED IN THE CENTER OF THE SITE - ONLY ALONG THE EDGES. METHANE GAS RECOVERY WELLS, IF FEASIBLE, WOULD BE PLACED IN THE CENTER AFTER CONNECTING TO THE SIDEWALL PASSIVE VENTS.

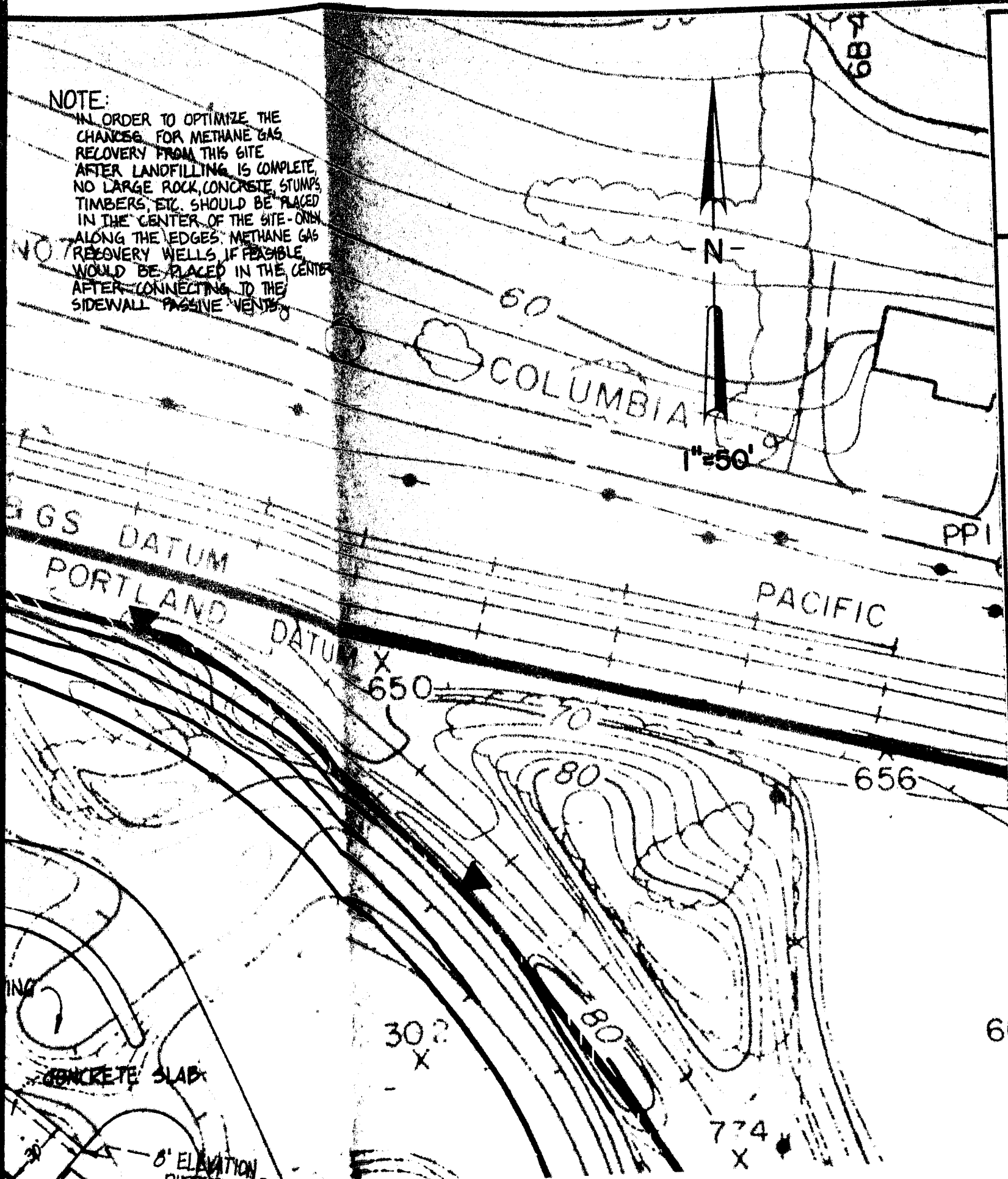



DATE
NOV. 1980

DESIGNER
CCK

DRAFTSMAN
FMS

REVIEWER
CCK













R.A.Wright
engineering
consulting engineers

1308 SW Bertha Blvd.
Portland, Oregon 97219
503/246-4293

CORP.
T
10

MATCH LINE

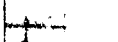
LEGEND

-  GAS MONITORING WELL
-  LEACHATE COLLECTION SUMP
-  STORM WATER SUMP
-  LEACHATE COLLECTION PIPE
-  WATER WELL (INDUSTRIAL)
-  GAS VENT
-  +20.0 FINAL EXCAVATION GRADE
-  EXCAVATION GRADE CONTOUR
-  WATER QUALITY MONITORING WELL
-  PROPERTY LINE
-  STORM DRAIN
-  SEWER LINE
-  EXISTING ELEVATION
-  PROPOSED ELEVATION

COVER SIDE WALLS WITH 36 MIL THICK REINFORCED HYPALON OR EQUAL

NOTE: LANDFILL GAS VENTS DETAIL SEE SHEET 6

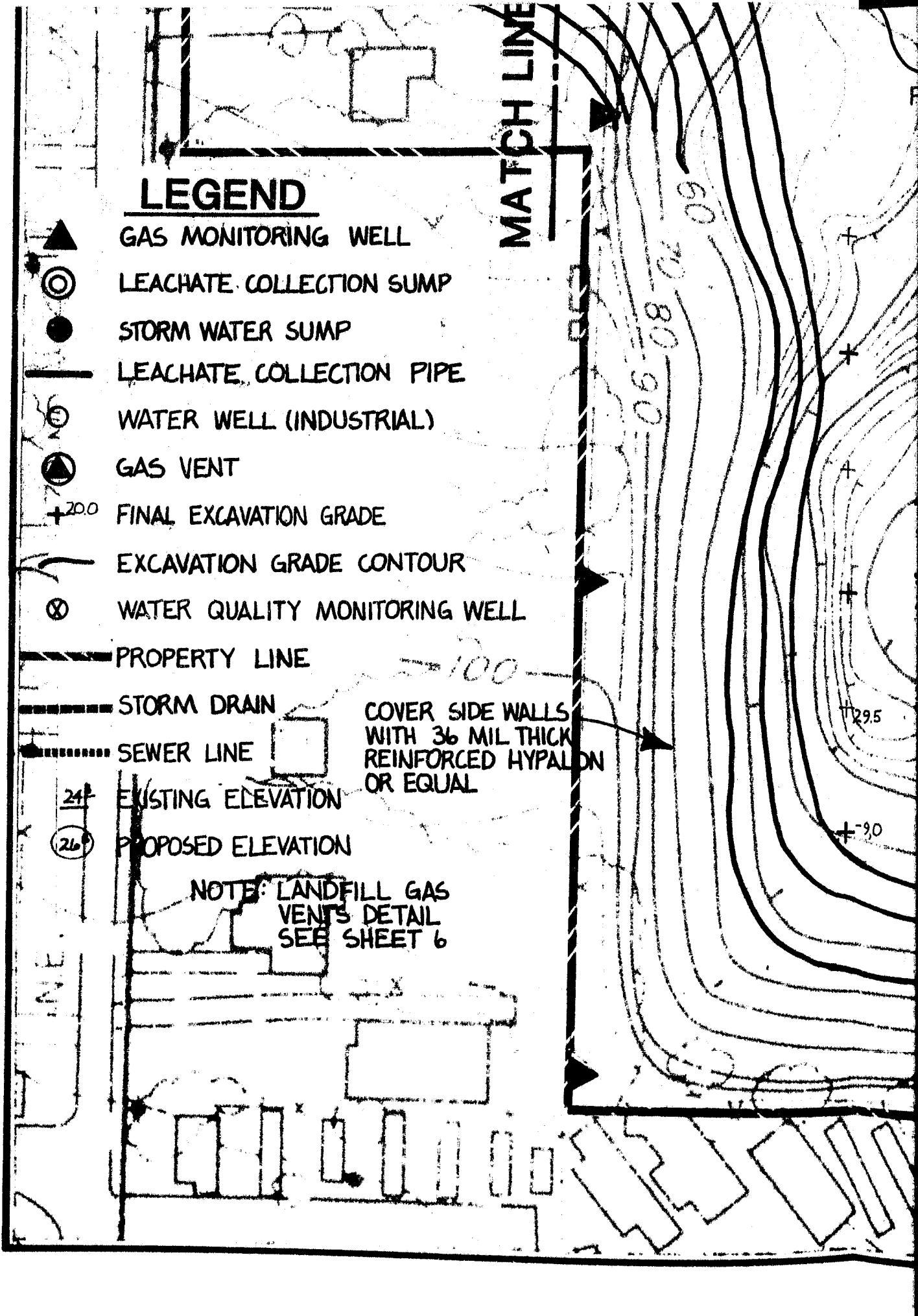

EXCAVATE
FOR COVER

STORM
SUMP
NOTE: MORE THAN
ONE SUMP MAY BE
REQUIRED DEPENDING
ON STORM FLOW AND
GROUND WATER LEVEL

PHASE I
FILL AREA

EXCAVATE
AND
GRADE

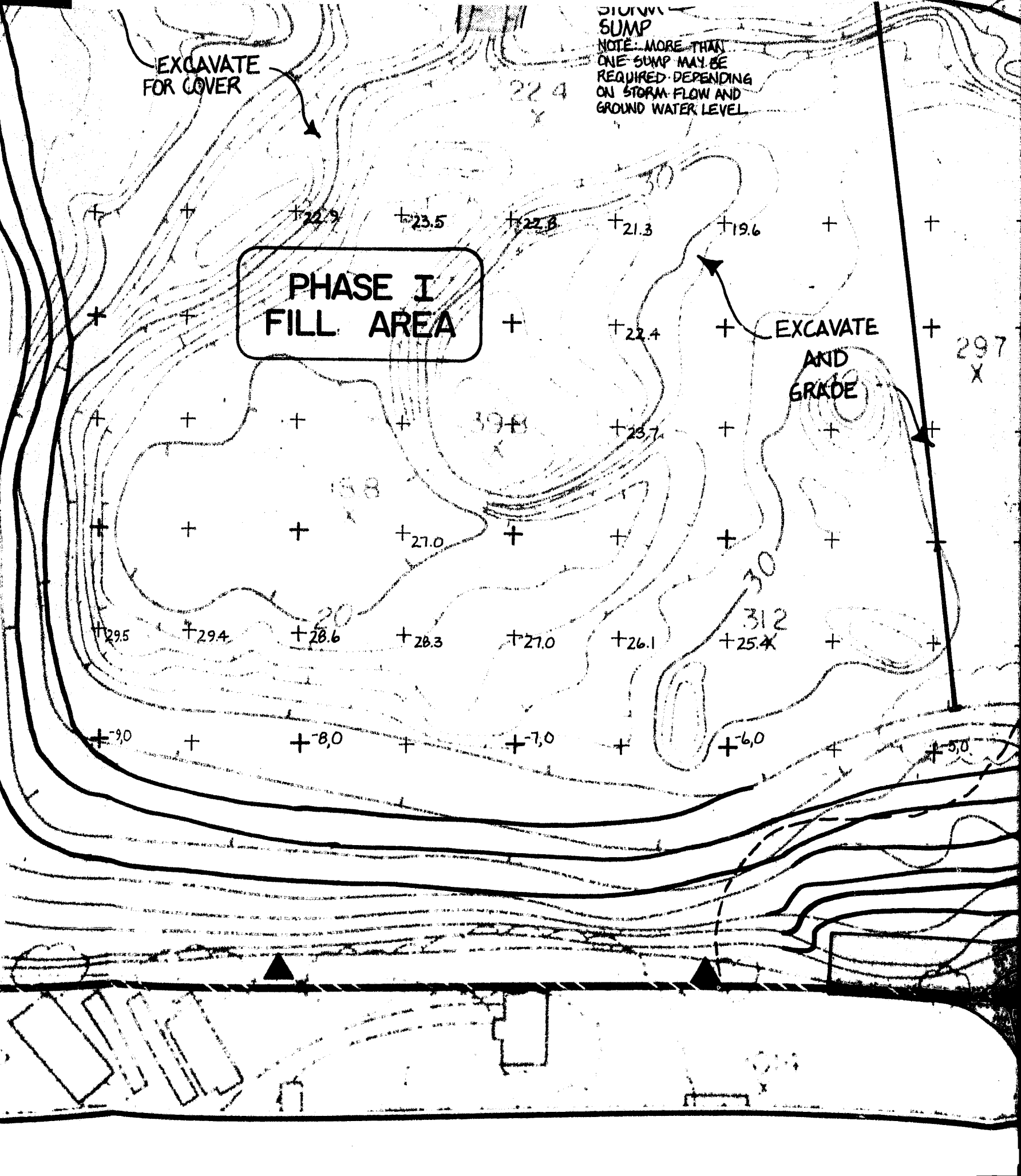

TO PREVENT ANNUAL
LEAKAGE

SCRAP BOX

ELEVATION
DIFFERENCE

ROADWAY TO FILL
0.075% MIN. SLOPE (TYPICAL)

MINIMUM PIT
BOTTOM GRADE 1%

APPROXIMATE
TOE OF EXISTING
FILL

RELIEF
GATE

MAINTENANCE BUILDING
AND TOOL SHED

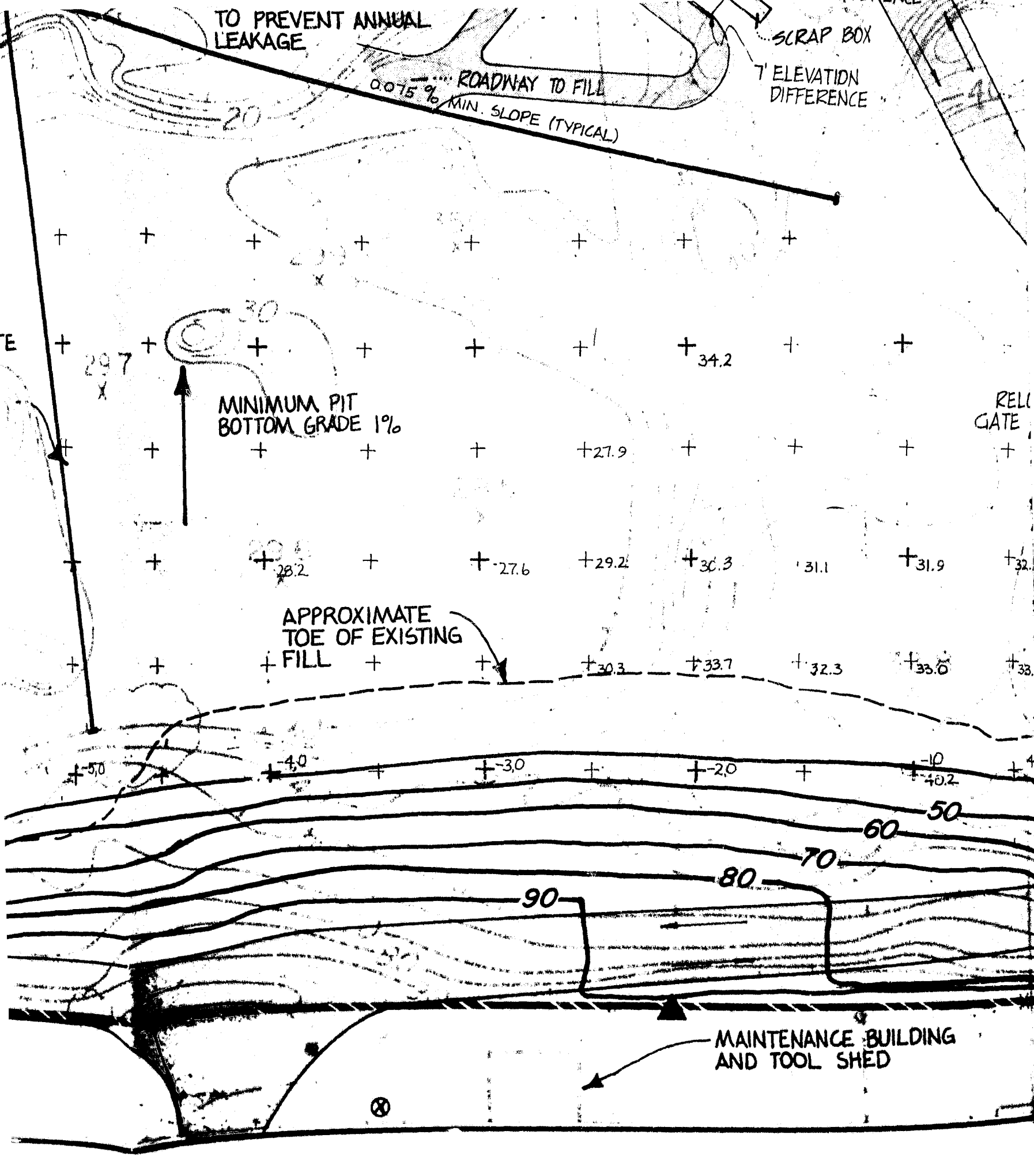

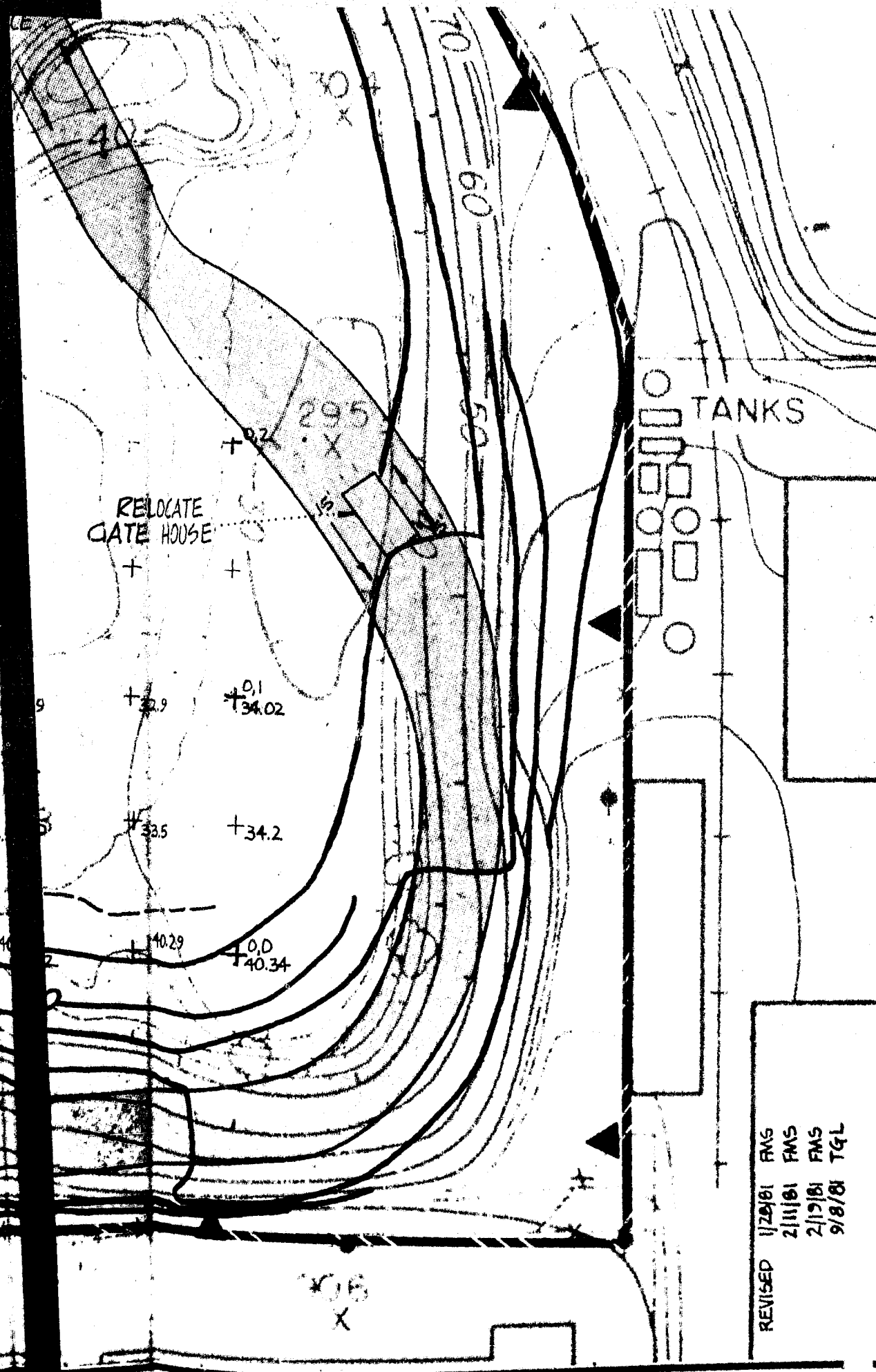

**METRO'S ANSWER TO THE
PUBLIC DUMPING PROBLEM
NASH PIT LAYOUT**

OWNER
WILLAMETTE-WESTERN
 3510 S.W. BOND STREET
 PORTLAND, OREGON 972
 PHONE (503) 222-4210

REVISED 1/29/81 FMS
 2/11/81 FMS
 2/19/81 FMS
 9/8/81 TGL

SHEET		1
OF		
7		
DRAWING NUMBER		
573-3		