

OREGON ASPHALTIC PAVING

LOCATION

Oregon Asphaltic Paving is located in Multnomah County five blocks from SE 162nd Avenue on Main Street. Its specific location is NE one-quarter Section 1, IS, 2E, WM.

ZONING

The site is zoned residential.

CURRENT SITE USE

Oregon Asphaltic Paving is a gravel pit.

ADJACENT LAND USE

Adjacent land use is residential. A park abutts the south side and a school yard abutts the east side.

GEOLOGY

Adjacent and on-site geology consistent of gravelly phase lacustrine deposits. Gravel is course with a sandy matrix.

SOIL

Soils are primarily gravel and sands. Top soil has been removed due to gravel operations.

SURFACE WATER

There are no lakes or streams near the site.

COVER

No cover material exists on site.

CAPACITY

The site is 20 acres with an estimated tonage capacity of 1,400,000.

ACCESS

Access is via SE Main Street through a residential neighborhood. Major access is via 162nd or Stark Street. The site is approximately 16 miles from Rossman's Landfill in Oregon City. The site will be easily accessible from I-205 when it is opened.

CLIMATE

Annual precipitation is 52 inches.

TA/ss/7287/103

Prepared by Metro Staff

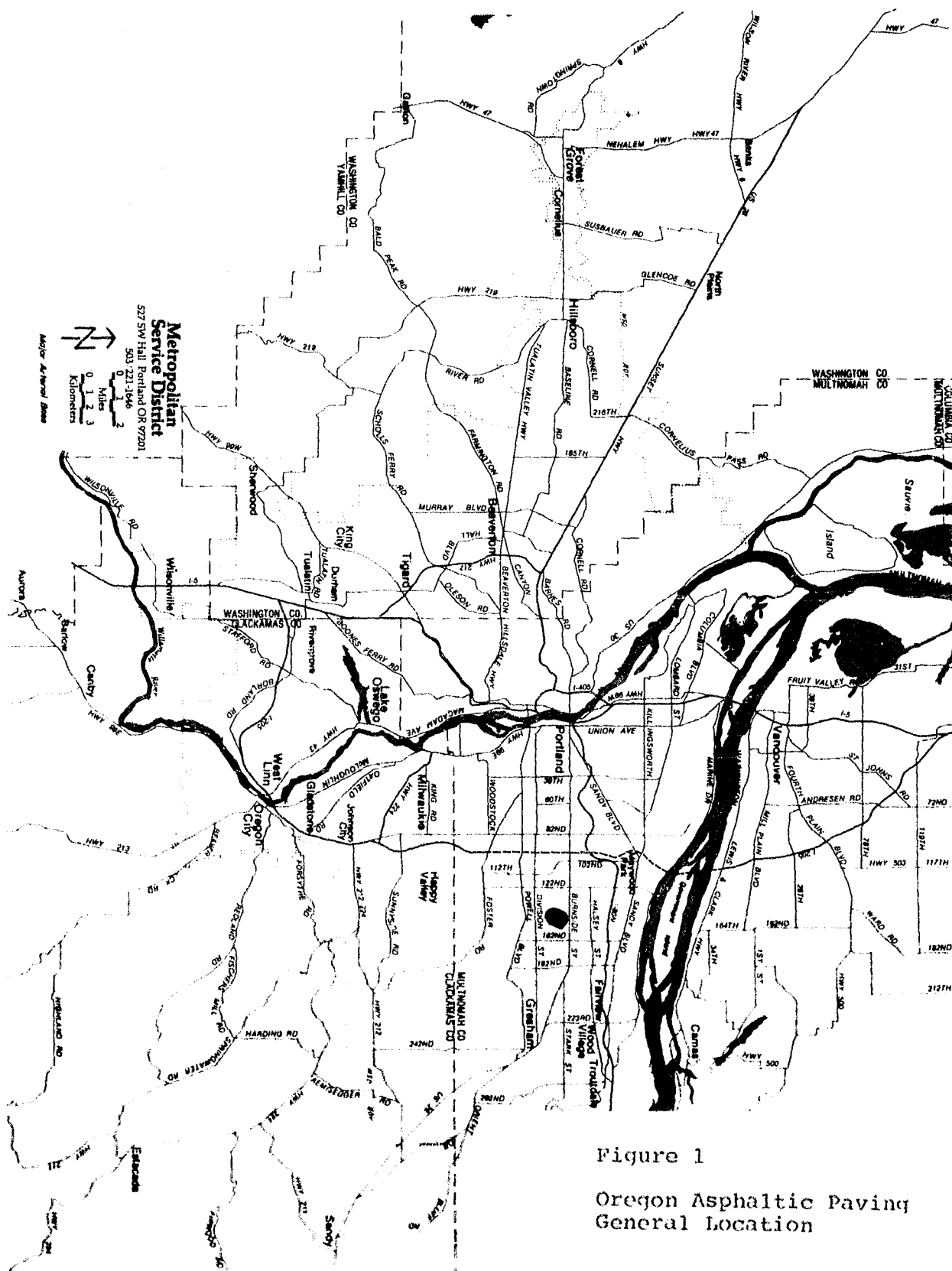

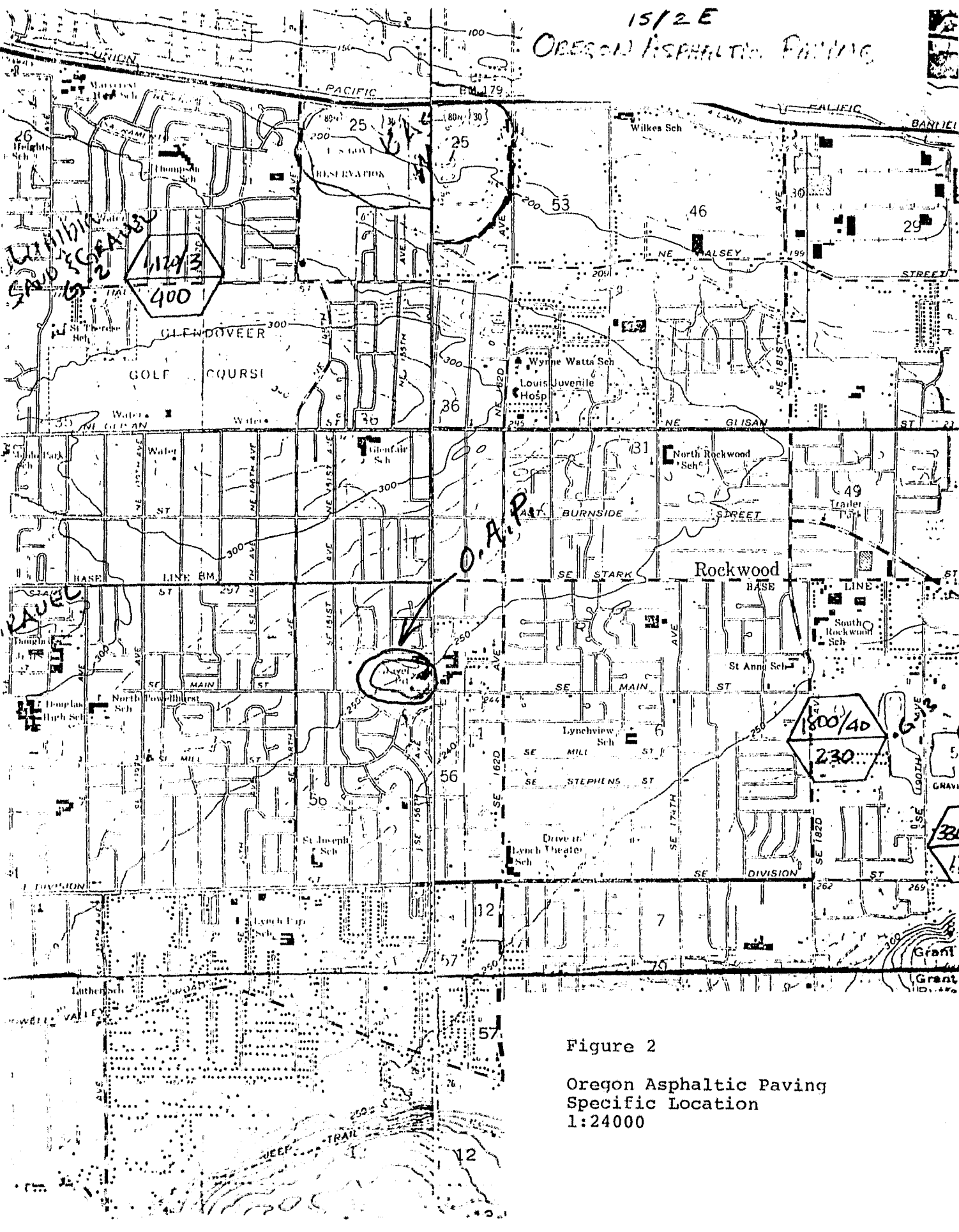

Figure 2

Oregon Asphaltic Paving
Specific Location
1:24000