

ASSIGNED, See Misc. Rec., Vol. 6 Page 1267

Application No. 62602

Permit No. 45974

STATE OF OREGON WATER RESOURCES DEPARTMENT

Application for Permit to Appropriate Surface Water

RECEIVED

SEP 8 1981

I, U.S. Fish and Wildlife Service

WATER RESOURCES DEPT.

P.O. Box 457

(Name of Applicant)

Ridgefield

SALEM, OREGON

of Washington

(Mailing Address)

98642

Phone No. (206) 887-4071

(City)

State of Washington

(Zip Code)

do hereby make application for a permit to appropriate the following described waters of the State of Oregon:

1. The source of the proposed appropriation is Columbia Slough

a tributary of Willamette River

2. The point of diversion is to be located 700 ft. N. and 100 ft. W.

(N. or S.)

(E. or W.)

from the E. 1/4 corner of Sec 36

(Public Land Survey Corner)

(If there is more than one point of diversion, each must be described)

being within the N.E. 1/4 of the S.E. 1/4 of

Sec. 36 Tp. 2N R. 1W W. M., in the county of Multnomah

(N. or S.) (E. or W.)

3. Location of area to be irrigated, or place of use if other than irrigation.

Township	Range	Section	List 1/4's of Section	List use and/or number of acres to be irrigated
2N	1E	30	SW 1/4, SE 1/4	OK 839 acres Total
		31	All except NE 1/4, NW 1/4	OK
		32	SW 1/4, SE 1/4	OK
		<del>33</del>		
		<del>34</del>		
2N	1W	25	SW 1/4 NE 1/4, SE 1/4 NW 1/4	OK
		36	E 1/2 SW 1/4, SE 1/4	OK
			E 1/2 SE 1/4	OK
			N 1/2 NE 1/4, SE 1/4 NE 1/4	OK
1N	1E	5	N 1/2 NW 1/4	OK
		6	N 1/2 NE 1/4, NE 1/4 NW 1/4	OK
		<del>7</del>		

4. The amount of water which the applicant intends to apply to beneficial use is 9<sup>1</sup> 4100 A.F. ~~3,692 acre ft (833 and 244 ft<sup>3</sup>)~~  
 cubic feet per second If water is to be used from more than one source, give quantity from each.

5. The use to which the water is to be applied is minimizing or eliminating conditions which foster avian botulism in the local waterfowl populations on Smith and Bybee Lakes in late summer.

6. DESCRIPTION OF WORKS

Include dimensions and type of construction of diversion dam and headgate, length and dimensions of supply ditch or pipeline, size and type of pump and motor, type of irrigation system to adequately describe the proposed distribution system:

Construction of temporary water level control structure at the outlet of Smith and Bybee Lakes, involving earthfill dam 14' above ground surface and 15' wide at top containing 50" diameter CMP 50' long with 72" diameter CMP half-round riser 10' high with removable timbers located in center of fill. Structure will allow high water runoff in Columbia Slough to overflow into Smith and Bybee Lakes and be held during summer months.

Total capacity at elevation 11.0 = 1,600 AF  
 Dead storage & siltage - below 6.5 = 500 AF  
 4100 AF

If for domestic use state number of families to be supplied

- 7. Construction work will begin on or before as soon as permits received
- 8. Construction work will be completed on or before October 31, 1981
- 9. The water will be completely applied to the proposed use on or before June 30, 1982

Application No. G 2602

Permit No. 45974

Remarks.....

.....  
.....  
.....  
.....  
.....

This permit, when issued, is for the beneficial use of water. By law, the land use associated with this water use must be in compliance with statewide land-use goals and any local acknowledged land-use plan. It is possible that the land use you propose may not be allowed if it is not in keeping with the goals and the acknowledged plan. Your city or county planning agency can advise you about the land-use plan in your area.

*John W. Fairbank*  
Signature of Applicant  
*Project Leader*

This is to certify that I have examined the foregoing application, together with the accompanying maps and data, and return the same for.....

In order to retain its priority, this application must be returned to the Water Resources Director with corrections on or before ....., 19.....

WITNESS my hand this ..... day of....., 19.....

Water Resources Director

By .....

This instrument was first received in the office of the Water Resources Director at Salem, Oregon, on the

8<sup>th</sup> day of SEPTEMBER, 1991, at 3:50 o'clock

P.M.

Application No. 021007

Permit No. 45974

Application No. 62602

Permit No. 45974

### Permit to appropriate the Public Waters of the State of Oregon

This is to certify that I have examined the foregoing application and do hereby grant the same **SUBJECT TO EXISTING RIGHTS INCLUDING THE EXISTING FLOW POLICIES ESTABLISHED BY THE WATER POLICY REVIEW BOARD** and the following limitations and conditions:

The right herein granted is limited to the amount of water which can be applied to beneficial use and shall not exceed 4,100 acre feet <sup>stored water only</sup> measured at the point of diversion from the stream, or its equivalent in case of rotation with other water users, from Smith and Bybee Lakes Reservoir to be constructed under Application R-62501, Permit R-8298.

The use to which this water is to be applied is minimizing or eliminating conditions which foster avian botulism.

If for irrigation, this appropriation shall be limited to of one cubic foot per second or its equivalent for each acre irrigated.

and shall be subject to such reasonable rotation system as may be ordered by the proper state officer. <sup>21 and 62</sup>  
The priority date of this permit is September 8, 1981 for 3,692 acre feet September 24, 1981 for 408 acre feet <sup>18/29/81</sup>

Actual construction work shall begin on or before September 30, 1982 and shall thereafter be prosecuted with reasonable diligence and be completed on or before October 1, 1983.

Complete application of the water to the proposed use shall be made on or before October 1, 1984.

WITNESS my hand this 30th day of September, 1981

  
Water Resources Director

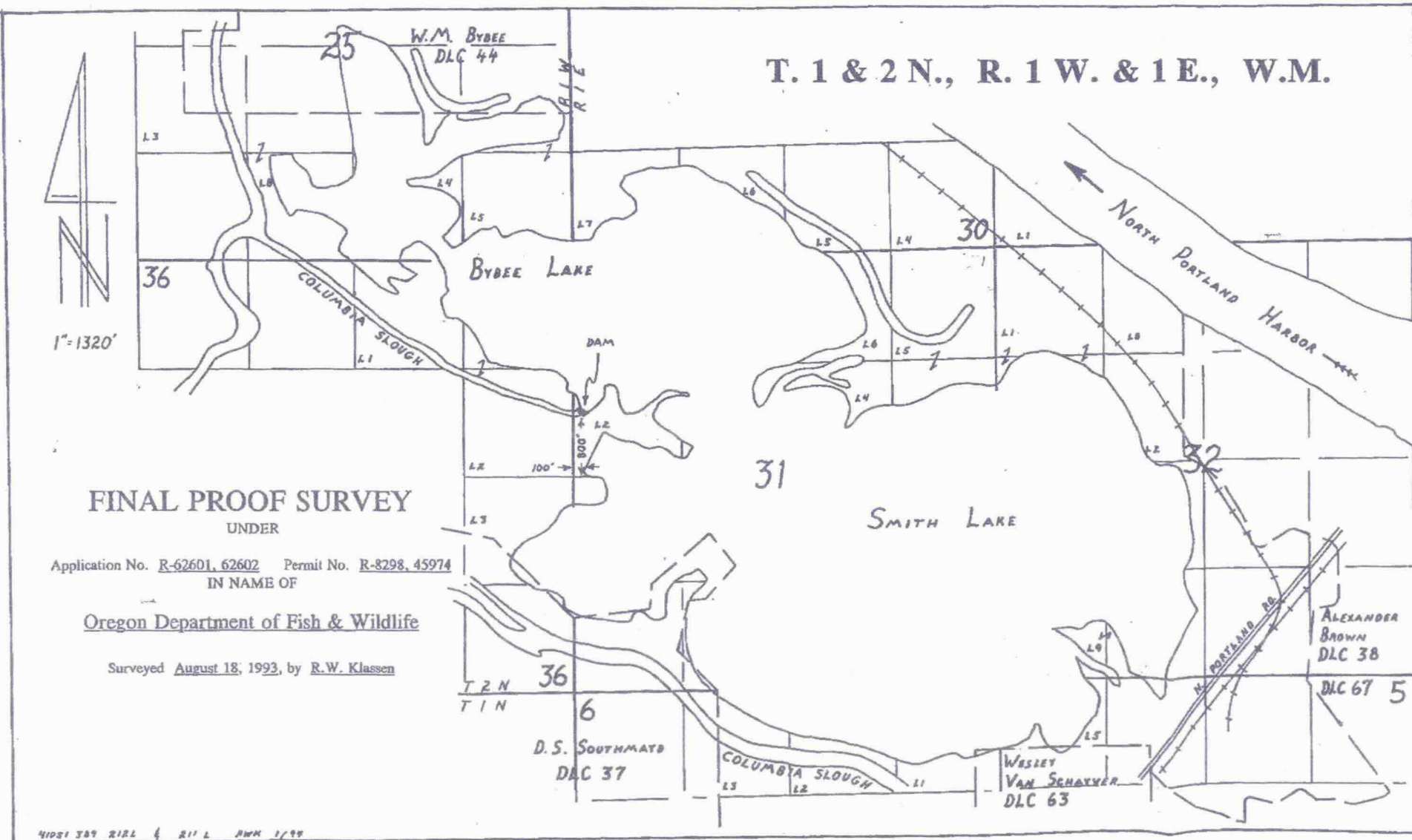

★ Reduced - sending original in mail