

Feb 26, 92

1

Foster

Banyuwangi

South Wengate  
LANDFILL OUTFALL TO AD

DC # 00892

Datum NGVD

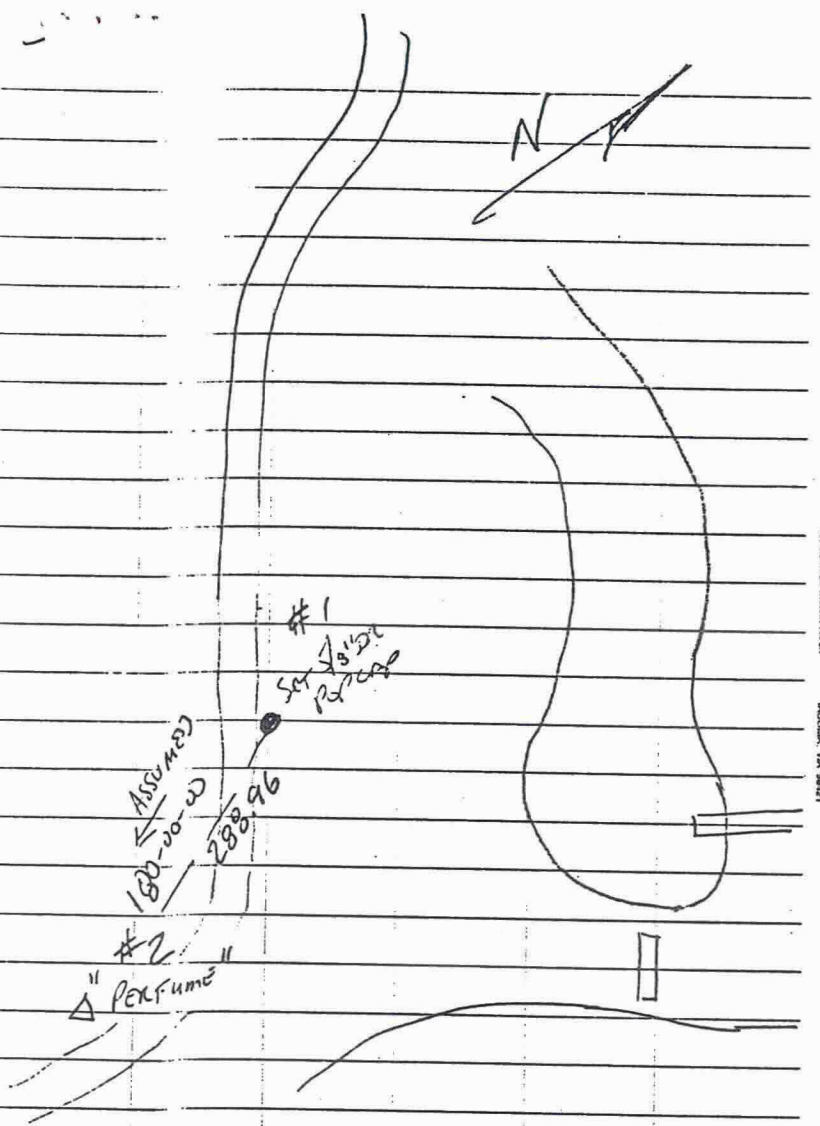
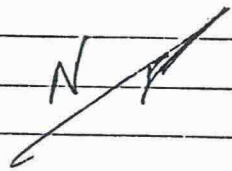

11. DRAINAGE CAMP  
 No. 312

SET DL/PCP CAP T@#1 1000.00 1000.00  
 "Perfume" BSC#2 711.04 1000.00  
 ASSUMED BKAE 130-00-00 288.96

HI T & P = +532

ELEV #1 = 2862

HI Q = 525

ELEV "Perfume" 3041 NGVD 33  
 (3050 "WCI")

$\Delta H = +172$

$3041 + 525 - 532 - 172 = 2862$

Breakline 1 TOE

" 2 TOP

" 3 TOE

#24 IE (56" CMP)

Breakline 4 TOP

" 5 TOE

#60 IE

#69 SEMB - "CG-192" METAL PLATE stamped

#70 12" wide cone

BREAKLINE 6 TOP ROAD

LAST RECTID # 129

LAST PT NO # 90

No. 312