

1. PROJECT DESCRIPTION

Removal of the black berries from the riparian areas north and south of Summer Creek on the Fowler Middle School property, S.W. Walnut Street and Tiedman Ave., Tigard, Oregon. This activity would be followed by the purchase and planting of native shrubs to provide food and cover for animals. Bird houses will be built and installed to increase the homes for song and water birds.

2. WORK TASKS AND TIME-LINES

Work began in the Fall of 1991 and will continue (with a 6 month extension) until Spring of 1993.

Fall 1991 cutting of black berries
Late winter of 1992, planting of native shrubs (W/extension 1993)
Spring, (early) 1993, installation of bird houses

3. PROJECT BUDGET (see attachment "A&B")

4. PROJECT STAFF AND WORKERS AND THOSE INVOLVED

Mr. Dick Bishop, proj. director
Mrs. Kathy Watanabe, teacher & homemaker
MR. Hank Dietz, teacher
Mrs. Nadien Lutes, teacher
Miss Kelly Dishinger, teacher
Mrs. Kelly Grant, teacher
Mrs. Christy Gayland, Fishman Environmental Services
Mr. Jack Broome, Wetlands Conservancy
Sargent Hutchensen, parent; contact Army Corps of Engineers
Ms. Maureen O. Smith, U.S. Fish and Wildlife Biologist, encouragement and advice, immediate supervisor.
Mr. Jeff Godfree, Fans of Fano Creek, OMSI, maps, encouragement, and good listening ear.

5. BENIFITS OF PROJECT

- a) ability to see and get in close to a much greater part of our portion of Summer Creek.
- b) have students at risk working cooperatively to clear black berries and plant something new which will affect our community for years to come.
- c) get us outdoors in science curriculum now and in the future.
- d) draw community people into school project cooperatively.
- e) "open" our woods to "savory people". Stop the trend toward a scary, off-limits area for the "unsavory."

6. HOW PROJECT RELATES TO THE GREENSPACES PROGRAM

Fanno Creek is all ready envolved in much community development and clean-up. As a tributary of Fanno, Summer Creeks time has come. We eventually want this to become an environmental learning center used by school and community as a arboretum, and outdoor learning center with fitness paths, challenge courses and a park for people. The more people we envolve and the more that carefully flow through it, the "safer" the woods will be.

7. WHAT WORKED/WHAT DIDN'T WORK/HELPFUL HINTS TO OTHERS

Worked...

- a) good developmnet of intra personal reactions
- b) cutting of black berries with machettes, long handled lopping shears
- c) spraying follage with Crossbow (not recommended for wetlands by USFWS) . Killed follage quickly, but not roots. Second application would have cone it. Used successfully a hand carried, low pressure, coarse spray.

Didn't work...

- a) wheel borrows with inflated tires, punctured by throns
- b) some of the students at risk
- c) plantings and drought combination
- d) planting before black berries dug out- very difficult to remove later in and around the plantings
- e) spraying with Rodeo plus fertilizer in the fall; spraying cut stems with undiluted Rodeo (?) Will have to wait until spring '92 to see if it worked (?). Crossbow did not kill roots.
- f) ordering plants for late winter delivery with a mild winter. They came.. some in blossom and many leafed out (bare root)
- g) used too short of marking stakes. 2 footers not tall enough. new growth hides them. Also the color coded stakes were often removed and thrown in creek. Plants were trashed by persons using the stakes.
- h) Wapato (arrow leaf), wild rice, cattails won't grow in partial shade.

Hints.....

- a) REMOVE BLACK BERRY PLANTS AND ROOTS BEFORE PLANTING
- b) stake, color code, every plank with at least 3 feet of stake above ground. Then when other vegetation grows up, you can find your plantings.
- c) ALWAYS plant plants in same pattern in relation to stake. i.e. creek side of the stake
- d) set photo-sites first. Record compass bearings for photo's at each site. Have prints and slides made. Keep a video record. (This will mean having a photo person around often. Proj. director can't work, direct, and make photo record too.)
- e) Put into grant request administrative costs, own labor costs, cost of time to leave regular job, and concentrate of project job. (As a teacher, I found it next to impossible to plan, administer, and direct the work of the students and volunteers. Personel in the School District offered to do part of it, but had trouble following through.)
- f) meet with grounds people. walk them around the site. show them stakes and plantings. EXPLAIN so they don't lawn mow them out when they get in a hurry.

5. PROJECT BUDGET

	FROM 91-92 \$10,000 Grant		ACTUALLY SPENT / DONE / USED	
	Local Match	METRO	Local Match	METRO
a) Personnel	\$3,575 (143 hrs @ \$25 ^{hr})	0	\$3,024 (108 periods @ \$28 ^{cc})	
b) Materials,	0	\$10,000		
Plants				\$3,853.65
Supplies				\$855.48 (tools 797.19) (lath 53.70) (file 4.59)
c) Rental fees	0	0	0	0
d) Professional Services (10 hrs @ \$50 ^{hr})	\$500		\$550 (11 hrs: Jack Brown 5 Sylvia Gulen 2 Jeff Hedfrie 2 Mike Rechinbach 1 Neal Main 1)	
e) Volunteer Labor Hrs. @ \$4.75	\$7,353		\$9,586.60 (2,018.23 hrs) (@ \$4.75)	
f) Indirect Costs	0	0	\$30 (aerial photo)	
g) Contingency	0	0	0	0
h) Local Resources	\$24	(work incentives) \$234 (workmans comp) 141.26 (4 days sub) 349.40 @ \$87.35/day (film devel) 52.04		
TOTALS	\$11,852	\$10,000	\$13,967.30	\$4,709.13

PROPOSED EXTENSION (being somewhat wiser and more experienced)

5. PROJECT BUDGET

	Local Match	Request from METRO (from previous / remainder of 1991-92 \$10,000 Grant)
a) Personnel	<p>Workman's Comp. for 353 hrs @ \$7/100hrs. = \$24.71</p>	<p>admin. 1 hr./wk. -6 mon. @ \$20/hr. = \$ 480 labor 64 @ \$8.00 (spraying)* 512 planting 265 @ \$8.00 \$2,120 <i>* Lynn Hatch Landscaping (~\$30/hr for spraying)</i></p>
b) Materials	0	<p>Spray (Rodeo)/fertilizer 400 Lath stakes (11 bundles) 100 Caulking (10 tubes) 30 PLANTS (replacement) 800</p>
plants		
supplies		<p>8 steel fence posts \$6 ea. (photo. cites) 48</p>
c) Rental fees	0	<p>Backpack sprayer 8 days @ \$20/day 160 Post driver @ \$5/ 4 hrs. 5</p>
d) Professional Services	0	0
e) Volunteer Labor @ \$4.75/ hour.	SEE PREVIOUS 91-92 BUDGET PAGE AND PAST REPORTS AND REIMBURSEMENT REQUESTS. \$13,967.30	
f) Indirect Costs		
g) Contingency	0	0
h) Local Resources	0	0
TOTALS	\$24.71	
	\$13,992.01	\$4,655

-180 ?

who can argue?
If spraying is to include \$525.83 balance - \$10,000 to make total \$5186.83 - then 512 + 525.83 = 1037.83 ÷ 64 hr = 16.21/hr. Slightly more than 1/2 hr.

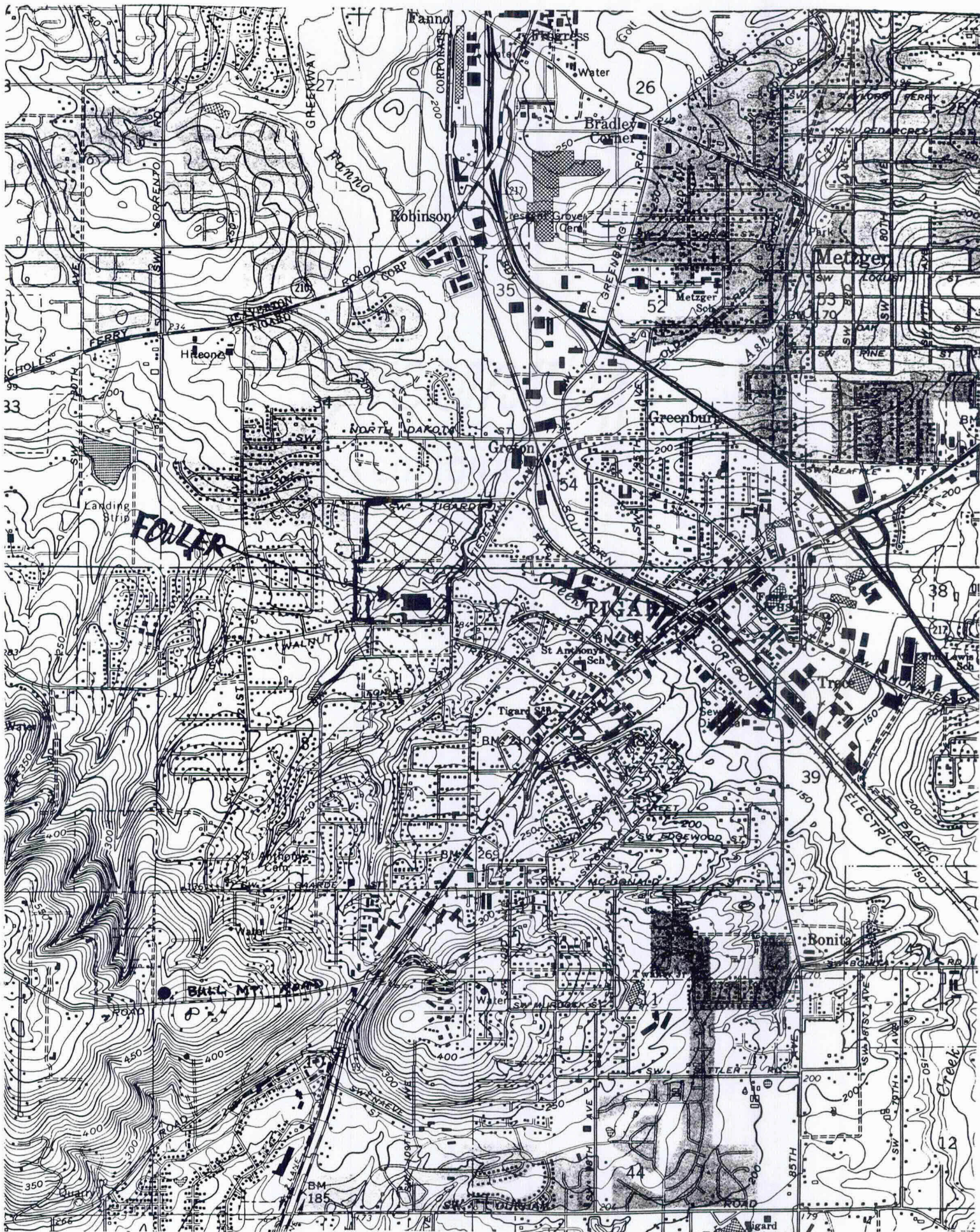

99W ↑
SW. PACIFIC HWY



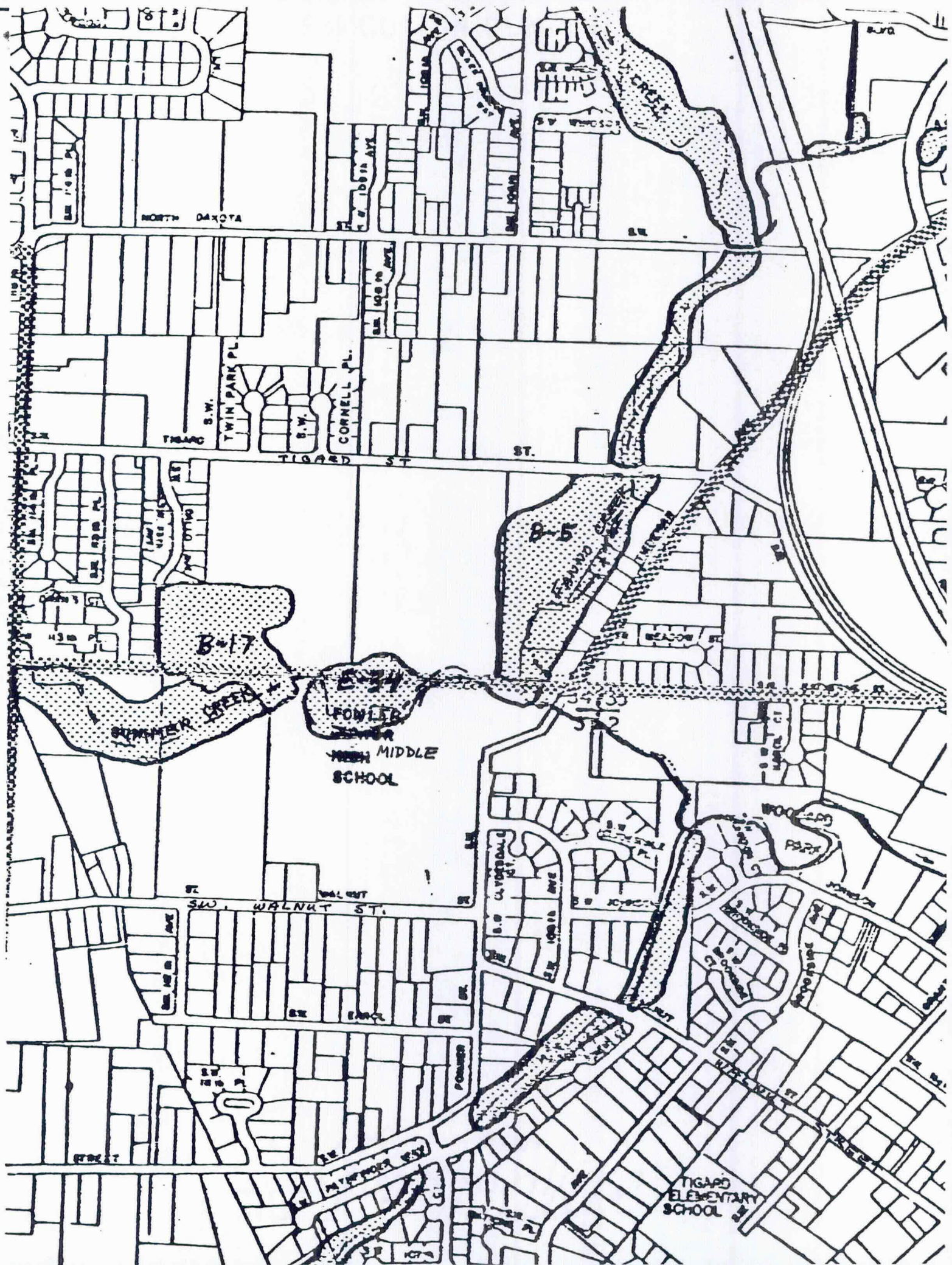

NORTH DAKOTA

TWIN PARK PL

CORNELL PL

TIGARD ST

ST.

B-17

SUMMER CREEK

FOWLER CREEK

TIGARD MIDDLE SCHOOL

B-5

WALNUT ST

TIGARD ELEMENTARY SCHOOL

△ B-17, E-34 & B-5 official 'Wetlands'
--- WOODS, FIR, PINE, CEDAR, MISC.

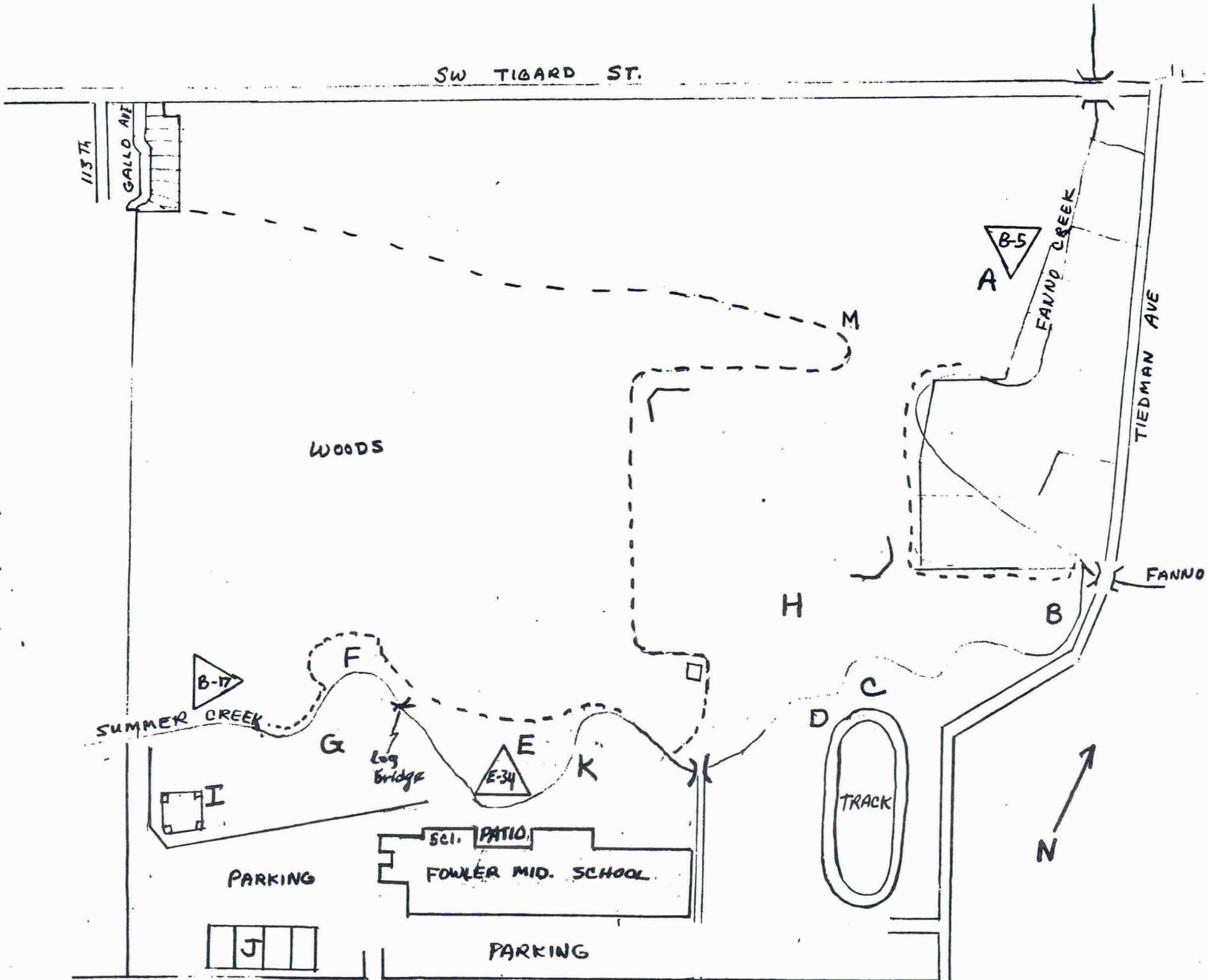





Photo Point

Site 6b

12/91 - 1/92 winter 91-92
right after clearing

after C Cotton tail
Meadow (CTM)
of Blackberries 8' tall.
of set CD

S. central side
of CTM. N. side
of Summer Creek.

Elderberry bush liberated

Kevin Riving
Angela Howard

Phillips

any
Myers



Site 3 5/2/93

W. end of CTM past
Chilmark trees



Liberated from 200 knots

W. end of CTM looking
W. across Summer creek at
S side of Big Bend toward
Soccer goal (out of sight to left)

Site 3



Site # 5 1/2 92

25 JAN 93

824



Winter 92

Site # 5
outside scene Rm 25 door

SEATTLE FILMWORKS

looking to NE & NW across
Summer Creek





Winter 93

Site # 68

SW end of Cotton tail meadow
looking east to track shed
past Elderberry. & creek.



start of

winter 93

Site 4b







Site 2 after cutting
2nd spring

Soccer goal in Big Bend
N. side, looking E
across Summer Creek
toward concrete bridge

5/2/93

alders on S. side ^{of creek}, Elderberry in bloom
on N side of creek





Site #7

of Summer Creek
N. side above Big Bend
looking S. to
Hinton Soccer field +
5/2/93 baseball field

Standing at post N.
side of sewage
creek trail





Site 4b East end of CTM
N. side of CTM
Hazelbrush freed



Start of Spring '93

Site 4b

E. entrance to CTM by
creek looking due W.
5/2/93



Big Bend - N. shore/bank of
Summer Creek
View straight from Spring 93

View
Rm. 25.
Cleared + bare of Black berries. Were
8 ft tall in fall of '91
directly opposite side of creek from site #7

SEATTLE FILMWORKS
PRINT 22 ROLL 31355713 28APR93

Big Bend - N. shore of
Summer Creek -
directly opposite view





winter 93

SEATTLE FILMWORKS 25 JAN 93

Site #5 outside Science Rm 25 door
Looking N + NW across
Summer Creek



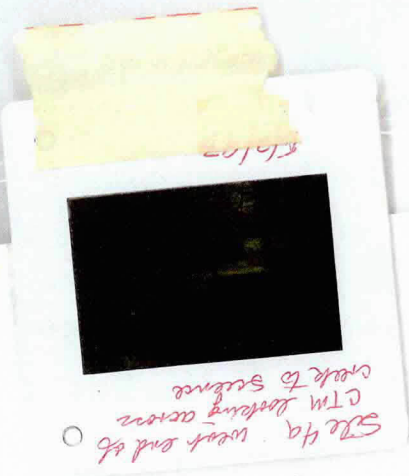

Looking N. from N side of CTM
across Summer creek
to Math Fire escape doors.

Spring 5/2/93

Site 4a





Winter 72

Site #5 outside Scene Rm 25
door. Looking N + NW across
Summer Creek

SEATTLE FILMWORKS
251193



Site 6b
SW end of water tank
meadow, Elderberry & Creek



to right, track added to E.
Spring 5/2/93
regrowth Nettles

Site 6b

N. end W end of CTM
standing on extreme N bank
of Summer Creek looking
E toward tracks

Spring 5/2/93

regrowth

blk berry, but
mostly nettles